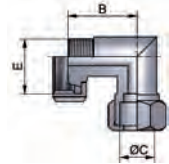

Zubehör – Behälterarmaturen
accessories – tank equipment
Art.-Nr. 9101-

							AISI 304/304L-1.4301/1.4307		AISI 316L-1.4404	
DN	A	B	C	D	E	Gew.	Art.-Nr.	Preis	Art.-Nr.	Preis
	mm	mm	mm	mm	mm	kg	poliert	EUR	poliert	EUR
10		41,0	13/10			G1/2"	-00101	56,00	-00103	75,60
15		41,0	15/10			G1/2"	-00151	56,00	-00153	75,60
20		41,0	20/15			G1/2"	-00201	66,05	-00203	89,20
10		41,0	13/10			Rd44x1/6	-20101	77,00	-20103	104,00
15		41,0	15/10			Rd44x1/6	-20151	77,00	-20153	104,00
20		41,0	20/15			Rd44x1/6	-20201	87,05	-20203	117,60

 G: Rohrgewinde ISO 228-1
 Rd: Rundgewinde

 G: pipe thread ISO 228-1
 Rd: round thread

Obere Standanzeige
upper level indicator

Art.-Nr. 9102-

							AISI 304/304L-1.4301/1.4307		AISI 316L-1.4404	
DN	A	B	C	D	E	Gew.	Art.-Nr.	Preis	Art.-Nr.	Preis
	mm	mm	mm	mm	mm	kg	poliert	EUR	poliert	EUR
10	92,0	41,0	13/10			G1/2"	-00101	93,30	-00103	126,00
15	92,0	41,0	15/10			G1/2"	-00151	93,30	-00153	126,00
20	92,0	41,0	20/15			G1/2"	-00201	103,40	-00203	139,60
10	92,0	41,0	13/10			Rd44x1/6	-20101	114,30	-20103	154,35
15	92,0	41,0	15/10			Rd44x1/6	-20151	114,30	-20153	154,35
20	92,0	41,0	20/15			Rd44x1/6	-20201	124,40	-20203	167,95

 G: Rohrgewinde ISO 228-1
 Rd: Rundgewinde

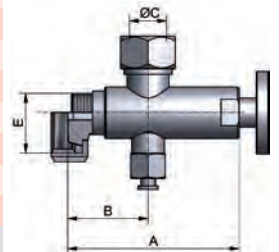
 G: pipe thread ISO 228-1
 Rd: round thread

Untere Standanzeige
lower level indicator

Art.-Nr. 9103-

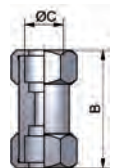
							AISI 304/304L-1.4301/1.4307		AISI 316L-1.4404	
DN	A	B	C	D	E	Gew.	Art.-Nr.	Preis	Art.-Nr.	Preis
	mm	mm	mm	mm	mm	kg	poliert	EUR	poliert	EUR
10		68,0	13/10				-00101	50,35	-00103	68,00
15		68,0	15/10				-00151	50,35	-00153	68,00
20		82,0	20/15				-00201	60,25	-00203	81,35

Zwischenstück
Standanzeige
intermediate piece

Art.-Nr. 910-

							PMMA/Borosilikat - PMMA/borosilicate			
DN	A	B	C	D	E	Gew.	Art.-Nr.	Preis	Art.-Nr.	Preis
	mm	mm	mm	mm	mm	kg	PMMA	EUR/m	Borosilikat	EUR/m
10	13,0		10,0				-400101	(+)	-500101	(+)
15	15,0		10,0				-400151	(+)	-500151	(+)
20	20,0		16,0				-400201	(+)	-500201	(+)
25	25,0		19,0				-400251	(+)		

 Länge B gemäß Angabe - Schutzrohr auf Anfrage
 (+) Preis auf Anfrage

 dimension B as specified - protecting pipe on inquiry
 (+) price on inquiry

Anzeigerohr
Plexi/Glas
indicator pipe
plexi/glass

Zubehör – Behälterarmaturen
accessories – tank equipment
Ablasshahn Art.-Nr. 91210-

AISI 316Ti / 316L-1.4571 / 1.4404

drain cock

DN	A	B	C	D	E	Gew.	Art.-Nr.	Preis
mm	mm	mm	mm	mm	mm	kg	poliert	EUR
4	5,0	G1/4"	55,0			0,090	-0043	70,60
6	6,0	G3/8"	65,0			0,170	-0063	84,80
8	8,0	G1/2"	70,0			0,270	-0083	97,70
12	12,0	G3/4"	95,0			0,560	-0123	147,55
20	15,0	G1"	125,0			0,880	-0203	203,50

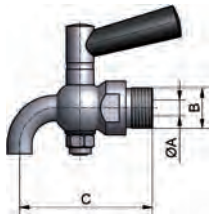

G: Rohrgewinde ISO 228-1

G: pipe thread ISO 228-1

Proberhahn Art.-Nr. 91220-

AISI 316Ti / 316L-1.4571 / 1.4404

test cock

DN	A	B	C	D	E	Gew.	Art.-Nr.	Preis
mm	mm	mm	mm	mm	mm	kg	poliert	EUR
4	5,0	G1/4"	62,0			0,100	-0043	59,15
6	6,0	G3/8"	66,0			0,160	-0063	74,90
8	8,0	G1/2"	78,0			0,260	-0083	77,75
12	12,0	G3/4"	100,0			0,520	-0123	111,85
20	15,0	G1"	128,0			0,840	-0203	177,15

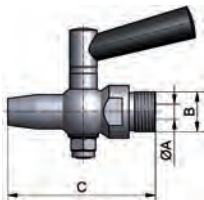

G: Rohrgewinde ISO 228-1

G: pipe thread ISO 228-1

Proberhahn mit Tülle Art.-Nr. 91230-

AISI 316Ti / 316L-1.4571 / 1.4404

test cock with nozzle

DN	A	B	C	D	E	Gew.	Art.-Nr.	Preis
mm	mm	mm	mm	mm	mm	kg	poliert	EUR
4	5,0	G1/4"	70,0			0,100	-0043	57,75
6	6,0	G3/8"	82,0			0,160	-0063	70,60
8	8,0	G1/2"	93,0			0,260	-0083	82,00
12	12,0	G3/4"	113,0			0,500	-0123	93,40
20	15,0	G1"	143,0			0,820	-0203	175,35

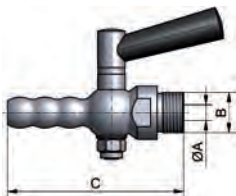

G: Rohrgewinde ISO 228-1

G: pipe thread ISO 228-1

Ablasshahn mit Muffe Art.-Nr. 91240-

AISI 316Ti / 316L-1.4571 / 1.4404

drain cock with socket

DN	A	B	C	D	E	Gew.	Art.-Nr.	Preis
mm	mm	mm	mm	mm	mm	kg	poliert	EUR
4	4,0	G1/4"	56,0			0,100	-0043	73,40
6	6,0	G3/8"	68,0			0,190	-0063	82,00
8	8,0	G1/2"	74,0			0,300	-0083	100,50
12	12,0	G3/4"	96,0			0,640	-0123	168,60
20	20,0	G1"	113,0			0,920	-0203	239,40

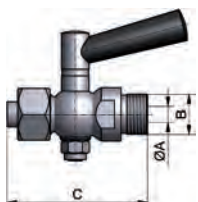

G: Rohrgewinde ISO 228-1

G: pipe thread ISO 228-1

Zubehör – Behälterarmaturen
accessories – tank equipment

Sprühkopf 270° Lochung oben - Splint spray ball 270° perforation above - cotter		Art.-Nr. 9445-						AISI 316Ti-1.4571		Art.-Nr.	Preis
		DN	A	B	C	D	E	Gew.	blank		
		mm	m³/h	m³/h	m	mm	kg				
		20	40,0	7,5	11,8	2,0-2,5	22,2	0,060	-00203	96,55	
		25	64,0	10,0	15,8	2,0-3,0	28,2	0,150	-00253	97,50	
		25	64,0	16,0	26,2	3,0-4,0	28,2	0,150	-10253	124,35	
		32	64,0	11,4	18,6	2,5-3,5	34,3	0,180	-00323	133,30	
		32	64,0	20,0	32,6	3,0-4,0	34,3	0,180	-10323	172,30	
		40	64,0	10,4	16,2	2,5-3,5	40,3	0,180	-00403	176,20	
		40	64,0	18,0	30,0	3,0-4,0	40,3	0,180	-10403	184,50	
		50	90,0	27,7	45,0	4,0-4,5	52,3	0,250	-00503	223,40	
		50	90,0	45,0	74,3	6,0	52,3	0,250	-10503	272,20	

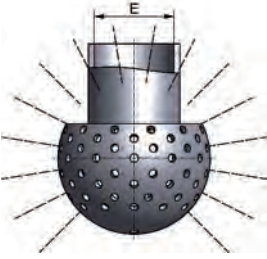

A: Kugeldurchmesser
 B/C: Durchsatz m³/h bei min. 1bar / max. 2,5 bar
 D: Spritzkreisdurchmesser [m]

A: ball diameter
 B/C: mass flow rate m³/h for min.1bar / max.2,5 bar
 D: spraying circle [m]

Sprühkopf 360° - Innengewinde spray ball 360° - inside thread		Art.-Nr. 9446-						AISI 316Ti-1.4571		Art.-Nr.	Preis
		DN	A	B	C	D	E	Gew.	blank		
		mm	m³/h	m³/h	m	mm	kg				
		10	25,0	2,1		0,5-1,0	G1/8"	0,020	-00103	114,30	
		15	30,0	4,2		1,0-1,5	G1/4"	0,032	-00153	94,55	
		20	40,0	7,7	12,2	2,0-2,5	G1/2"	0,060	-00203	96,55	
		25	64,0	11,0	17,3	2,0-3,0	G1"	0,150	-00253	101,50	
		25	64,0	17,5	28,1	3,0-4,0	G1"	0,150	-10253	131,30	
		32	64,0	13,5	19,5	2,5-3,5	G1"	0,180	-00323	152,80	
		32	64,0	21,7	32,2	3,0-4,0	G1"	0,180	-10323	164,10	
		40	64,0	11,8	19,2	2,5-3,5	G1"	0,180	-00403	158,50	
		40	64,0	22,8	36,8	3,4-4,0	G1"	0,180	-10403	192,30	
		50	90,0	28,6	41,7	4,0-4,5	G2"	0,250	-00503	228,10	
		50	90,0	49,1	67,0	6,0	G2"	0,250	-10503	269,60	

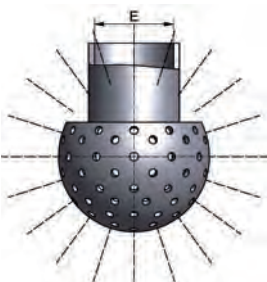

A: Kugeldurchmesser
 B/C: Durchsatz m³/h bei min. 1bar / max. 2,5 bar
 D: Spritzkreisdurchmesser [m]

A: ball diameter
 B/C: mass flow rate m³/h for min.1bar / max.2,5 bar
 D: spraying circle [m]

Sprühkopf 360° - Splint spray ball 360° - cotter		Art.-Nr. 9447-						AISI 316Ti-1.4571		Art.-Nr.	Preis
		DN	A	B	C	D	E	Gew.	blank		
		mm	m³/h	m³/h	m	mm	kg				
		10	25,0	2,1		0,5-1,0	12,2	0,020	-00103	98,70	
		15	30,0	4,2		1,0-1,5	18,2	0,032	-00153	94,55	
		20	40,0	7,7	12,2	2,0-2,5	22,2	0,060	-00203	96,55	
		25	64,0	11,0	17,3	2,0-3,0	28,2	0,150	-00253	101,50	
		25	64,0	17,5	28,1	3,0-4,0	28,2	0,150	-10253	131,30	
		32	64,0	13,5	19,5	2,5-3,5	34,3	0,180	-00323	133,30	
		32	64,0	21,7	32,2	3,0-4,0	34,3	0,180	-10323	186,20	
		40	64,0	11,8	19,2	2,5-3,5	40,3	0,180	-00403	152,40	
		40	64,0	22,8	36,8	3,0-4,0	40,3	0,180	-10403	196,60	
		50	90,0	28,6	41,7	4,0-4,5	52,3	0,250	-00503	211,90	
		50	90,0	49,1	67,0	6,0	52,3	0,250	-10503	287,10	

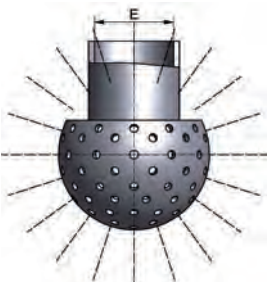

A: Kugeldurchmesser
 B/C: Durchsatz m³/h bei min. 1bar / max. 2,5 bar
 D: Spritzkreisdurchmesser [m]

A: ball diameter
 B/C: mass flow rate m³/h for min.1bar / max.2,5 bar
 D: spraying circle [m]