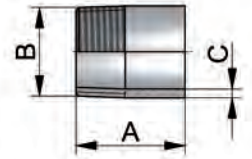

**Rohrverbindungen – Industriefittinge**
**pipe connections – industrial fittings**

Art-Nr. 0400-							AISI 304-1.4301		AISI 316Ti-1.4571	
DN	A	B	C	D	E	Gew.	Art.-Nr.	Preis	Art.-Nr.	Preis
mm	mm	mm	mm	mm	mm	kg	matt	EUR	matt	EUR
1/8"	30,0	R1/8"	2,0			0,020	-30801812	(+)	-30801814	(+)
1/4"	30,0	R1/4"	2,3			0,020	-30801412	(+)	-30801414	(+)
3/8"	30,0	R3/8"	2,3			0,020	-30803812	(+)	-30803814	(+)
1/2"	35,0	R1/2"	2,6			0,040	-30801212	(+)	-30801214	(+)
3/4"	40,0	R3/4"	2,6			0,050	-30803412	(+)	-30803414	(+)
1"	40,0	R1"	3,2			0,080	-30810012	(+)	-30810014	(+)
1 1/4"	50,0	R1 1/4"	3,2			0,120	-30811412	(+)	-30811414	(+)
1 1/2"	50,0	R1 1/2"	3,2			0,150	-30811212	(+)	-30811214	(+)
2"	50,0	R2"	3,6			0,200	-30820012	(+)	-30820014	(+)
2 1/2"	60,0	R2 1/2"	3,6			0,300	-30821212	(+)	-30821214	(+)
3"	70,0	R3"	4,0			0,460	-30830012	(+)	-30830014	(+)
4"	80,0	R4"	4,5			0,910	-30840012	(+)	-30840014	(+)

R: Rohrgewinde DIN EN 10226-1 R: pipe thread DIN EN 10226-1

**Anschweißnippel**
**screwed end**

Art-Nr. 0400-							AISI 304-1.4301		AISI 316Ti-1.4571	
DN	A	B	C	D	E	Gew.	Art.-Nr.	Preis	Art.-Nr.	Preis
mm	mm	mm	mm	mm	mm	kg	matt	EUR	matt	EUR
1/8"	17,0	Rp1/8"	14,0			0,020	-33301812	(+)	-33301814	(+)
1/4"	25,0	Rp1/4"	18,0			0,020	-33301412	(+)	-33301414	(+)
3/8"	26,0	Rp3/8"	21,3			0,030	-33303812	(+)	-33303814	(+)
1/2"	34,0	Rp1/2"	26,4			0,060	-33301212	(+)	-33301214	(+)
3/4"	36,0	Rp3/4"	31,8			0,080	-33303412	(+)	-33303414	(+)
1"	43,0	Rp1"	39,5			0,140	-33310012	(+)	-33310014	(+)
1 1/4"	48,0	Rp1 1/4"	48,3			0,190	-33311412	(+)	-33311414	(+)
1 1/2"	48,0	Rp1 1/2"	54,5			0,240	-33311212	(+)	-33311214	(+)
2"	56,0	Rp2"	66,3			0,340	-33320012	(+)	-33320014	(+)
2 1/2"	65,0	Rp2 1/2"	82,0			0,530	-33321212	(+)	-33321214	(+)
3"	71,0	Rp3"	95,0			0,610	-33330012	(+)	-33330014	(+)
4"	83,0	Rp4"	122,0			1,180	-33340012	(+)	-33340014	(+)

Rp: Rohrgewinde DIN EN 10226-1 Rp: pipe thread DIN EN 10226-1

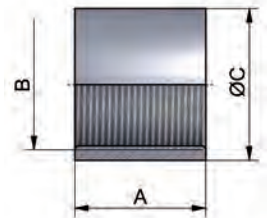
**Muffe**
**socket**

Art-Nr. 0400-							AISI 304-1.4301		AISI 316Ti-1.4571	
DN	A	B	C	D	E	Gew.	Art.-Nr.	Preis	Art.-Nr.	Preis
mm	mm	mm	mm	mm	mm	kg	matt	EUR	matt	EUR
1/8"	7,5	Rp1/8"	14,0			0,010	-33401812	(+)	-33401814	(+)
1/4"	11,0	Rp1/4"	18,0			0,020	-33401412	(+)	-33401414	(+)
3/8"	11,5	Rp3/8"	21,3			0,020	-33403812	(+)	-33403814	(+)
1/2"	15,0	Rp1/2"	26,4			0,030	-33401212	(+)	-33401214	(+)
3/4"	16,5	Rp3/4"	31,8			0,040	-33403412	(+)	-33403414	(+)
1"	19,0	Rp1"	39,5			0,060	-33410012	(+)	-33410014	(+)
1 1/4"	21,5	Rp1 1/4"	48,3			0,090	-33411412	(+)	-33411414	(+)
1 1/2"	21,5	Rp1 1/2"	54,5			0,120	-33411212	(+)	-33411214	(+)
2"	26,0	Rp2"	66,3			0,170	-33420012	(+)	-33420014	(+)
2 1/2"	30,0	Rp2 1/2"	82,0			0,210	-33421212	(+)	-33421214	(+)
3"	33,0	Rp3"	95,0			0,290	-33430012	(+)	-33430014	(+)
4"	39,0	Rp4"	122,0			0,940	-33440012	(+)	-33440014	(+)

Rp: Rohrgewinde DIN EN 10226-1 Rp: pipe thread DIN EN 10226-1

(+) Bitte fordern Sie hier unsere Preisliste an (+) please request our price list

**Halbe Muffe**
**half socket**

**Rohrverbindungen – Industriefittinge**
**pipe connections – industrial fittings**

Rohrdoppelnippel barrel nipple	Art-Nr. 0400-							AISI 304-1.4301		AISI 316Ti-1.4571	
	DN	A	B	C	D	E	Gew.	Art.-Nr.	Preis	Art.-Nr.	Preis
	mm	mm	mm	mm	mm	mm	kg	matt	EUR	matt	EUR
	1/8"	40,0	R1/8"				0,020	-31001812	(+)	-31001814	(+)
	1/4"	40,0	R1/4"				0,020	-31001412	(+)	-31001414	(+)
	3/8"	40,0	R3/8"				0,030	-31003812	(+)	-31003814	(+)
	1/2"	60,0	R1/2"				0,060	-31001212	(+)	-31001214	(+)
	3/4"	60,0	R3/4"				0,070	-31003412	(+)	-31003414	(+)
	1"	60,0	R1"				0,110	-31010012	(+)	-31010014	(+)
	1 1/4"	80,0	R1 1/4"				0,200	-31011412	(+)	-31011414	(+)
	1 1/2"	80,0	R1 1/2"				0,250	-31011212	(+)	-31011214	(+)
	2"	100,0	R2"				0,440	-31020012	(+)	-31020014	(+)
	2 1/2"	100,0	R2 1/2"				0,480	-31021212	(+)	-31021214	(+)
	3"	120,0	R3"				0,770	-31030012	(+)	-31030014	(+)
	4"	120,0	R4"				1,300	-31040012	(+)	-31040014	(+)

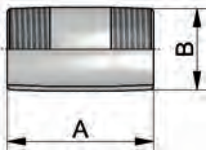

R: Rohrgewinde DIN EN 10226-1

R: pipe thread DIN EN 10226-1

Winkel 90° elbow 90°	Art-Nr. 0400-							AISI 316-1.4408		
	DN	A	B	C	D	E	Gew.	Art.-Nr.	Preis	
	mm	mm	mm	mm	mm	mm	kg	matt	EUR	
	1/8"	17,6	Rp1/8"	18,0			0,040	-30101814		(+)
	1/4"	20,0	Rp1/4"	21,3			0,060	-30101414		(+)
	3/8"	21,3	Rp3/8"	23,5			0,070	-30103814		(+)
	1/2"	27,0	Rp1/2"	29,0			0,100	-30101214		(+)
	3/4"	33,0	Rp3/4"	35,0			0,170	-30103414		(+)
	1"	38,0	Rp1"	43,0			0,260	-30110014		(+)
	1 1/4"	45,0	Rp1 1/4"	52,0			0,390	-30111414		(+)
	1 1/2"	50,0	Rp1 1/2"	58,0			0,510	-30111214		(+)
	2"	58,0	Rp2"	71,0			0,760	-30120014		(+)
	2 1/2"	69,3	Rp2 1/2"	86,5			1,180	-30121214		(+)
	3"	77,5	Rp3"	99,0			1,420	-30130014		(+)
	4"	97,3	Rp4"	125,0			2,620	-30140014		(+)

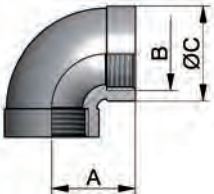

Rp: Rohrgewinde DIN EN 10226-1

Rp: pipe thread DIN EN 10226-1

T-Stück tee	Art-Nr. 0400-							AISI 316-1.4408		
	DN	A	B	C	D	E	Gew.	Art.-Nr.	Preis	
	mm	mm	mm	mm	mm	mm	kg	matt	EUR	
	1/8"	34,0	Rp1/8"	17,0			0,060	-30701814		(+)
	1/4"	42,0	Rp1/4"	21,0			0,090	-30701414		(+)
	3/8"	47,2	Rp3/8"	23,6			0,110	-30703814		(+)
	1/2"	54,0	Rp1/2"	27,0			0,160	-30701214		(+)
	3/4"	66,0	Rp3/4"	33,0			0,230	-30703414		(+)
	1"	76,0	Rp1"	38,0			0,360	-30710014		(+)
	1 1/4"	90,0	Rp1 1/4"	45,0			0,550	-30711414		(+)
	1 1/2"	100,0	Rp1 1/2"	50,0			0,700	-30711214		(+)
	2"	116,0	Rp2"	58,0			1,060	-30720014		(+)
	2 1/2"	137,4	Rp2 1/2"	68,7			1,540	-30721214		(+)
	3"	155,6	Rp3"	77,8			1,840	-30730014		(+)
	4"	194,0	Rp4"	97,0			3,240	-30740014		(+)

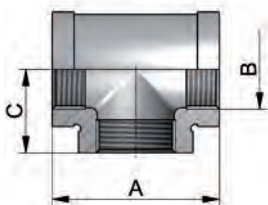

Rp: Rohrgewinde DIN EN 10226-1

Rp: pipe thread DIN EN 10226-1

(+) Bitte fordern Sie hier unsere Preisliste an

(+) please request our price list

**Rohrverbindungen – Industriefittinge**
**pipe connections – industrial fittings**

Art-Nr. 0400-							AISI 316-1.4408		
DN	A	B	C	D	E	Gew.	Art.-Nr.	Preis	
mm	mm	mm	mm	mm	mm	kg	matt	EUR	
1/8"	37,0	Rp1/8"	SW30			0,100	-31101814	(+)	
1/4"	37,0	Rp1/4"	SW30			0,090	-31101414	(+)	
3/8"	40,0	Rp3/8"	SW36			0,130	-31103814	(+)	
1/2"	46,0	Rp1/2"	SW41			0,170	-31101214	(+)	
3/4"	48,0	Rp3/4"	SW46			0,260	-31103414	(+)	
1"	52,0	Rp1"	SW50			0,290	-31110014	(+)	
1 1/4"	60,0	Rp1 1/4"	SW65			0,530	-31111414	(+)	
1 1/2"	71,0	Rp1 1/2"	SW75			0,880	-31111214	(+)	
2"	76,0	Rp2"	SW90			1,320	-31120014	(+)	
2 1/2"	90,0	Rp2 1/2"	SW110			1,960	-31121214	(+)	
3"	90,0	Rp3"	SW120			2,280	-31130014	(+)	
4"	115,0	Rp4"	SW155			4,520	-31140014	(+)	

Rp: Rohrgewinde DIN EN 10226-1  
 SW: Schlüsselweite

Rp: pipe thread DIN EN 10226-1  
 SW: width across flats

**Verschraubung  
flach dichtend  
Innengewinde**

**union  
flat seat  
with internal thread**

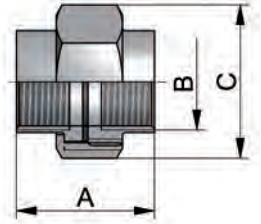

Art-Nr. 0400-							AISI 316-1.4408		
DN	A	B	C	D	E	Gew.	Art.-Nr.	Preis	
mm	mm	mm	mm	mm	mm	kg	matt	EUR	
1/8"	37,0	Rp1/8"	SW30			0,100	-31201814	(+)	
1/4"	37,0	Rp1/4"	SW30			0,090	-31201414	(+)	
3/8"	40,0	Rp3/8"	SW36			0,130	-31203814	(+)	
1/2"	46,0	Rp1/2"	SW41			0,170	-31201214	(+)	
3/4"	48,0	Rp3/4"	SW46			0,260	-31203414	(+)	
1"	52,0	Rp1"	SW50			0,290	-31210014	(+)	
1 1/4"	60,0	Rp1 1/4"	SW65			0,530	-31211414	(+)	
1 1/2"	71,0	Rp1 1/2"	SW75			0,880	-31211214	(+)	
2"	76,0	Rp2"	SW90			1,320	-31220014	(+)	
2 1/2"	90,0	Rp2 1/2"	SW110			1,960	-31221214	(+)	
3"	90,0	Rp3"	SW120			2,280	-31230014	(+)	
4"	115,0	Rp4"	SW155			4,520	-31240014	(+)	

Rp: Rohrgewinde DIN EN 10226-1  
 SW: Schlüsselweite

Rp: pipe thread DIN EN 10226-1  
 SW: width across flats

**Verschraubung  
konisch dichtend  
Innengewinde**

**union  
conical seat  
with internal thread**

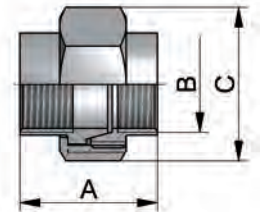

Art-Nr. 0400-							AISI 316-1.4408		
DN	A	B	C	D	E	Gew.	Art.-Nr.	Preis	
mm	mm	mm	mm	mm	mm	kg	matt	EUR	
1/4"-1/8"	15,2	Rp1/8"	R1/4"	SW16		0,010	-32501414018	(+)	
3/8"-1/4"	16,5	Rp1/4"	R3/8"	SW18		0,010	-32503814014	(+)	
1/2"-3/8"	21,0	Rp3/8"	R1/2"	SW26		0,030	-32501214038	(+)	
3/4"-1/2"	24,0	Rp1/2"	R3/4"	SW30		0,050	-32503414012	(+)	
1"-3/4"	27,0	Rp3/4"	R1"	SW35		0,080	-32510014034	(+)	
1 1/4"-1"	30,0	Rp1"	R1 1/4"	SW45		0,140	-32511414100	(+)	
1 1/2"-1 1/4"	36,0	Rp1 1/4"	R1 1/2"	SW52		0,200	-32511214114	(+)	
2"-1 1/2"	36,0	Rp1 1/2"	R2"	SW63		0,300	-32520014112	(+)	
2 1/2"-2"	45,0	Rp2"	R2 1/2"	SW81		0,650	-32521214200	(+)	
3"-2 1/2"	47,0	Rp2 1/2"	R3"	SW95		0,770	-32530014212	(+)	
4"-3"	52,0	Rp3"	R4"	SW119		1,500	-32540014300	(+)	

R+Rp: Rohrgewinde DIN EN 10226-1  
 SW: Schlüsselweite

R+Rp: pipe thread DIN EN 10226-1  
 SW: width across flats

(+) Bitte fordern Sie hier unsere Preisliste an  
 (+) please request our price list

**Sechskant-  
reduzierstück**

**hexagon bushing**

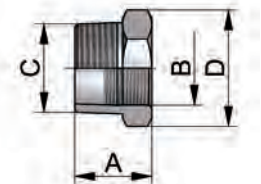

**Rohrverbindungen – Industriefittinge**
**pipe connections – industrial fittings**
**Sechskantstopfen**  
**hexagon plug**

Art-Nr. 0400-							AISI 316-1.4408		
DN	A	B	C	D	E	Gew.	Art.-Nr.	Preis	
mm	mm	mm	mm	mm	mm	kg	matt	EUR	
1/8"	17,0	R1/8"	SW12			0,010	-33001814	(+)	
1/4"	17,5	R1/4"	SW16			0,020	-33001414	(+)	
3/8"	18,0	R3/8"	SW20			0,030	-33003814	(+)	
1/2"	25,0	R1/2"	SW24			0,050	-33001214	(+)	
3/4"	26,0	R3/4"	SW30			0,080	-33003414	(+)	
1"	29,0	R1"	SW38			0,120	-33010014	(+)	
1 1/4"	35,0	R1 1/4"	SW46			0,210	-33011414	(+)	
1 1/2"	38,0	R1 1/2"	SW52			0,310	-33011214	(+)	
2"	39,0	R2"	SW65			0,430	-33020014	(+)	
2 1/2"	44,0	R2 1/2"	SW81			0,810	-33021214	(+)	
3"	54,0	R3"	SW94			1,140	-33030014	(+)	
4"	55,0	R4"	SW119			2,520	-33040014	(+)	

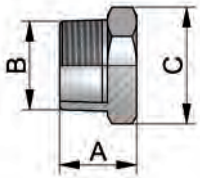
 R: Rohrgewinde DIN EN 10226-1  
 SW: Schlüsselweite

 R: pipe thread DIN EN 10226-1  
 SW: width across flats

**Sechskant-Doppelnippel**  
**hexagon nipple**

Art-Nr. 0400-							AISI 316-1.4408		
DN	A	B	C	D	E	Gew.	Art.-Nr.	Preis	
mm	mm	mm	mm	mm	mm	kg	matt	EUR	
1/8"	23,6	R1/8"	SW12			0,010	-34001814	(+)	
1/4"	27,8	R1/4"	SW16			0,020	-34001414	(+)	
3/8"	28,0	R3/8"	SW20			0,030	-34003814	(+)	
1/2"	34,0	R1/2"	SW24			0,050	-34001214	(+)	
3/4"	40,0	R3/4"	SW30			0,080	-34003414	(+)	
1"	46,0	R1"	SW38			0,120	-34010014	(+)	
1 1/4"	52,5	R1 1/4"	SW46			0,240	-34011414	(+)	
1 1/2"	54,0	R1 1/2"	SW52			0,300	-34011214	(+)	
2"	62,0	R2"	SW65			0,420	-34020014	(+)	
2 1/2"	70,0	R2 1/2"	SW81			0,720	-34021214	(+)	
3"	78,4	R3"	SW94			0,900	-34030014	(+)	
4"	94,0	R4"	SW119			1,450	-34040014	(+)	

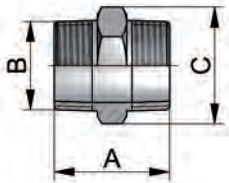
 R: Rohrgewinde DIN EN 10226-1  
 SW: Schlüsselweite

 R: pipe thread DIN EN 10226-1  
 SW: width across flats

**Kugelhahn Orbital**  
**3-teilig**  
**ball valve orbital**  
**3-pieces**

Art-Nr. 0400-							AISI 316-1.4408 PTFE		
DN	A	B	C	D	E	Gew.	Art.-Nr.	Preis	
mm	mm	mm	mm	mm	mm	kg	matt	EUR	
10	121,0	51,0	105,0	13,0	10,0	0,350	-69001028	(+)	
16	124,0	55,0	125,0	19,0	16,0	0,478	-69001628	(+)	
20	128,0	59,0	130,0	23,0	20,0	0,700	-69002028	(+)	
26	139,0	73,0	140,0	29,0	26,0	0,918	-69002628	(+)	
32	144,0	78,0	140,0	35,0	32,0	1,780	-69003228	(+)	
38	164,0	91,0	190,0	41,0	38,0	2,170	-69003828	(+)	
50	173,0	108,0	190,0	53,0	50,0	3,058	-69005028	(+)	

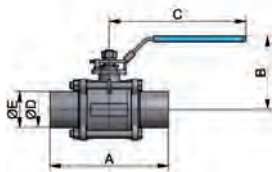

(+) Bitte fordern Sie hier unsere Preisliste an

(+) please request our price list