

Rohrverbindungen – Flanschverbindungen

pipe connections – flanged pipe connections

Flanschverbindung
komplett

flange connection
complete (DIN)

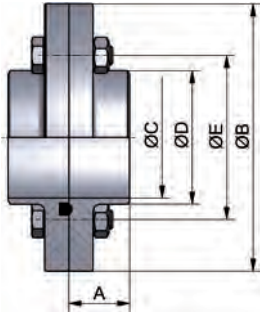

Art.-Nr. 14500-								AISI 304/304L-1.4301/1.4307				AISI 316L-1.4404			
DN	A	B	C	D	E	Gew.	Art.-Nr.	Preis	Art.-Nr.	Preis	Art.-Nr.	Preis	Art.-Nr.	Preis	
mm	mm	mm	mm	mm	mm	kg	bl. NBR	EUR	matt NBR	EUR	bl. NBR	EUR	matt NBR	EUR	
10	20,0	62,0	10,0	15,0	44,0	0,480	-0101200	(+)	-0102200	(+)	-0103200	(+)	-0104200	(+)	
15	20,0	68,0	16,0	21,0	50,0	0,520	-0151200	58,45	-0152200	60,45	-0153200	75,80	-0154200	78,45	
20	20,0	75,0	20,0	25,0	59,0	0,580	-0201200	55,60	-0202200	57,30	-0203200	72,20	-0204200	73,90	
25	20,0	87,0	26,0	31,0	73,0	0,780	-0251200	40,65	-0252200	42,35	-0253200	52,50	-0254200	54,20	
32	20,0	92,0	32,0	37,0	78,0	0,920	-0321200	44,30	-0322200	46,10	-0323200	57,60	-0324200	59,40	
40	25,0	97,0	38,0	43,0	82,5	0,940	-0401200	45,60	-0402200	47,55	-0403200	60,30	-0404200	62,20	
50	25,0	110,0	50,0	55,0	95,5	1,180	-0501200	49,10	-0502200	51,10	-0503200	66,30	-0504200	68,30	
65	25,0	127,0	66,0	72,0	112,5	1,500	-0651200	62,10	-0652200	64,20	-0653200	87,00	-0654200	89,10	
80	30,0	142,0	81,0	87,0	127,5	2,560	-0801200	87,85	-0802200	90,05	-0803200	123,00	-0804200	125,20	
100	30,0	162,0	100,0	106,0	147,5	3,430	-1001200	110,80	-1002200	113,10	-1003200	149,60	-1004200	151,90	
125	40,0	200,0	125,0	132,0	180,0	5,740	-1251200	326,40	-1252200	333,00	-1253200	417,85	-1254200	424,45	
150	45,0	230,0	150,0	157,0	210,0	7,690	-1501200	399,50	-1502200	407,50	-1503200	511,35	-1504200	519,35	

wird in Einzelteilen geliefert - weitere Dichtungswerkstoffe auf Anfrage
delivered in single components - other gasket materials on inquiry

Kleinflansch
mit Nut

flange
with groove

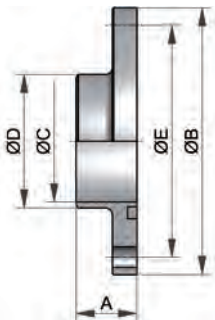

Art.-Nr. 14510-								AISI 304/304L-1.4301/1.4307				AISI 316L-1.4404			
DN	A	B	C	D	E	Gew.	Art.-Nr.	Preis	Art.-Nr.	Preis	Art.-Nr.	Preis	Art.-Nr.	Preis	
mm	mm	mm	mm	mm	mm	kg	blank	EUR	matt	EUR	blank	EUR	matt	EUR	
10	20,0	62,0	10,0	15,0	44,0	0,120	-0101	(+)	-0102	(+)	-0103	(+)	-0104	(+)	
15	20,0	68,0	16,0	21,0	50,0	0,260	-0151	27,40	-0152	28,45	-0153	36,40	-0154	37,75	
20	20,0	75,0	20,0	25,0	59,0	0,310	-0201	25,75	-0202	26,60	-0203	34,30	-0204	35,15	
25	20,0	87,0	26,0	31,0	73,0	0,410	-0251	18,05	-0252	18,90	-0253	24,15	-0254	25,00	
32	20,0	92,0	32,0	37,0	78,0	0,490	-0321	19,90	-0322	20,80	-0323	26,75	-0324	27,65	
40	25,0	97,0	38,0	43,0	82,5	0,500	-0401	20,55	-0402	21,50	-0403	28,10	-0404	29,05	
50	25,0	110,0	50,0	55,0	95,5	0,580	-0501	22,35	-0502	23,35	-0503	31,20	-0504	32,20	
65	25,0	127,0	66,0	72,0	112,5	0,730	-0651	28,95	-0652	30,00	-0653	41,80	-0654	42,85	
80	30,0	142,0	81,0	87,0	127,5	1,380	-0801	41,55	-0802	42,65	-0803	59,65	-0804	60,75	
100	30,0	162,0	100,0	106,0	147,5	1,640	-1001	53,20	-1002	54,35	-1003	73,20	-1004	74,35	
125	40,0	200,0	125,0	132,0	180,0	2,580	-1251	163,40	-1252	166,70	-1253	210,50	-1254	213,80	
150	45,0	230,0	150,0	157,0	210,0	3,300	-1501	200,90	-1502	204,90	-1503	258,50	-1504	262,50	

Montagesätze und Dichtungen siehe Seite 28
mounting kits and gaskets see page 28

Kleinflansch
ohne Nut

flange
without groove

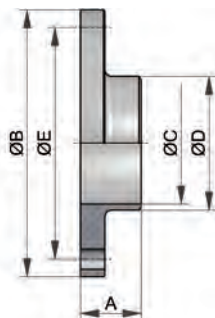

Art.-Nr. 14520-								AISI 304/304L-1.4301/1.4307				AISI 316L-1.4404			
DN	A	B	C	D	E	Gew.	Art.-Nr.	Preis	Art.-Nr.	Preis	Art.-Nr.	Preis	Art.-Nr.	Preis	
mm	mm	mm	mm	mm	mm	kg	blank	EUR	matt	EUR	blank	EUR	matt	EUR	
10	20,0	62,0	10,0	15,0	44,0	0,120	-0101	(+)	-0102	(+)	-0103	(+)	-0104	(+)	
15	20,0	68,0	16,0	21,0	50,0	0,260	-0151	25,50	-0152	26,45	-0153	33,85	-0154	35,15	
20	20,0	75,0	20,0	25,0	59,0	0,310	-0201	24,30	-0202	25,15	-0203	32,35	-0204	33,20	
25	20,0	87,0	26,0	31,0	73,0	0,410	-0251	17,00	-0252	17,85	-0253	22,75	-0254	23,60	
32	20,0	92,0	32,0	37,0	78,0	0,490	-0321	18,80	-0322	19,70	-0323	25,25	-0324	26,15	
40	25,0	97,0	38,0	43,0	82,5	0,500	-0401	19,40	-0402	20,35	-0403	26,50	-0404	27,45	
50	25,0	110,0	50,0	55,0	95,5	0,580	-0501	21,05	-0502	22,05	-0503	29,40	-0504	30,40	
65	25,0	127,0	66,0	72,0	112,5	0,730	-0651	27,30	-0652	28,35	-0653	39,35	-0654	40,40	
80	30,0	142,0	81,0	87,0	127,5	1,380	-0801	39,15	-0802	40,25	-0803	56,20	-0804	57,30	
100	30,0	162,0	100,0	106,0	147,5	1,640	-1001	50,10	-1002	51,25	-1003	68,90	-1004	70,05	
125	40,0	200,0	125,0	132,0	180,0	2,580	-1251	153,90	-1252	157,20	-1253	198,25	-1254	201,55	
150	45,0	230,0	150,0	157,0	210,0	3,300	-1501	189,25	-1502	193,25	-1503	243,50	-1504	247,50	

Montagesätze und Dichtungen siehe Seite 28
mounting kits and gaskets see page 28
(+) Preis auf Anfrage
(+) price on inquiry

Rohrverbindungen – Flanschverbindungen pipe connections – flanged pipe connections

**Flanschverbindung
komplett (Zoll)**

Art.-Nr. 14601-

AISI 304/304L-1.4301/1.4307

AISI 316L-1.4404

**flange connection
complete (inch)**

DN	A	B	C	D	E	Gew.	Art.-Nr.	Preis	Art.-Nr.	Preis	Art.-Nr.	Preis	Art.-Nr.	Preis
mm	mm	mm	mm	mm	mm	kg	bl. NBR	EUR	matt NBR	EUR	bl. NBR	EUR	matt NBR	EUR
1"	19,0	87,0	22,3	28,0	73,0	0,780	-1001200	43,10	-1002200	44,90	-1003200	55,55	-1004200	57,35
1,5"	24,0	97,0	35,1	41,0	82,5	0,940	-1121200	48,05	-1122200	50,05	-1123200	63,50	-1124200	65,50
2"	24,0	110,0	47,8	54,0	95,5	1,180	-2001200	51,55	-2002200	53,55	-2003200	69,60	-2004200	71,60
2,5"	24,0	127,0	60,5	68,0	112,5	1,500	-2121200	64,60	-2122200	66,70	-2123200	90,40	-2124200	92,50
3"	30,0	142,0	72,8	78,0	127,5	2,560	-3001200	114,00	-3002200	116,30	-3003200	159,25	-3004200	161,55
4"	29,0	162,0	97,6	104,0	147,5	3,430	-4001200	125,85	-4002200	128,45	-4003200	169,90	-4004200	172,50

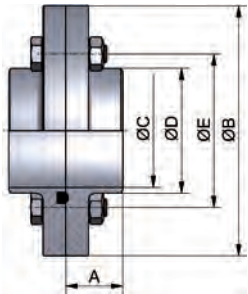

wird in Einzelteilen geliefert - weitere Dichtungswerkstoffe auf Anfrage

delivered in single components - other gasket materials on inquiry

**Kleinflansch
mit Nut (Zoll)**

Art.-Nr. 14611-

AISI 304/304L-1.4301/1.4307

AISI 316L-1.4404

**flange
with groove (inch)**

DN	A	B	C	D	E	Gew.	Art.-Nr.	Preis	Art.-Nr.	Preis	Art.-Nr.	Preis	Art.-Nr.	Preis
mm	mm	mm	mm	mm	mm	kg	blank	EUR	matt	EUR	blank	EUR	matt	EUR
1"	19,0	87,0	22,3	28,0	73,0	0,410	-1001	19,30	-1002	20,20	-1003	25,70	-1004	26,60
1,5"	24,0	97,0	35,1	41,0	82,5	0,510	-1121	21,80	-1122	22,80	-1123	29,75	-1124	30,75
2"	24,0	110,0	47,8	54,0	95,5	0,600	-2001	23,60	-2002	24,60	-2003	32,90	-2004	33,90
2,5"	24,0	127,0	60,5	68,0	112,5	0,800	-2121	30,25	-2122	31,30	-2123	43,55	-2124	44,60
3"	30,0	142,0	72,8	78,0	127,5	1,480	-3001	54,50	-3002	55,65	-3003	77,80	-3004	78,95
4"	29,0	162,0	97,6	104,0	147,5	1,710	-4001	60,95	-4002	62,25	-4003	83,60	-4004	84,90

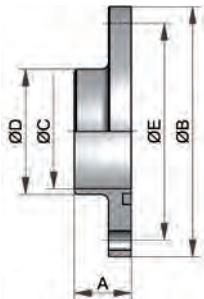

Montagesätze und Dichtungen siehe Seite 28

mounting kits and gaskets see page 28

**Kleinflansch
ohne Nut (Zoll)**

Art.-Nr. 14621-

AISI 304/304L-1.4301/1.4307

AISI 316L-1.4404

**flange
without groove (inch)**

DN	A	B	C	D	E	Gew.	Art.-Nr.	Preis	Art.-Nr.	Preis	Art.-Nr.	Preis	Art.-Nr.	Preis
mm	mm	mm	mm	mm	mm	kg	blank	EUR	matt	EUR	blank	EUR	matt	EUR
1"	19,0	87,0	22,3	28,0	73,0	0,410	-1001	18,20	-1002	19,10	-1003	24,25	-1004	25,15
1,5"	24,0	97,0	35,1	41,0	82,5	0,510	-1121	20,60	-1122	21,60	-1123	28,10	-1124	29,10
2"	24,0	110,0	47,8	54,0	95,5	0,600	-2001	22,25	-2002	23,25	-2003	31,00	-2004	32,00
2,5"	24,0	127,0	60,5	68,0	112,5	0,800	-2121	28,50	-2122	29,55	-2123	41,00	-2124	42,05
3"	30,0	142,0	72,8	78,0	127,5	1,480	-3001	51,35	-3002	52,50	-3003	73,30	-3004	74,45
4"	29,0	162,0	97,6	104,0	147,5	1,710	-4001	57,40	-4002	58,70	-4003	78,80	-4004	80,10

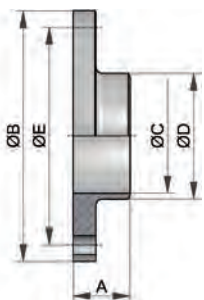

Montagesätze und Dichtungen siehe Seite 28

mounting kits and gaskets see page 28

Rohrverbindungen – Flanschverbindungen
pipe connections – flanged pipe connections

Art-Nr. 14M00-								AISI 304/304L-1.4301/1.4307				AISI 316L-1.4404			
DN	A	B	C	D	E	Gew.	Art.-Nr.	Preis	Art.-Nr.	Preis	Art.-Nr.	Preis	Art.-Nr.	Preis	
mm	mm	mm	mm	mm	mm	kg	bl. EPDM	EUR	matt EPDM	EUR	bl. EPDM	EUR	matt EPDM	EUR	
25	24,0	83,0	26,0	29,0	65,0	0,410	-0251300	(+)	-0252300	(+)	-0253300	84,55	-0254300	87,50	
40	24,0	100,0	38,0	41,0	82,0	0,500	-0401300	(+)	-0402300	(+)	-0403300	90,65	-0404300	93,80	
50	24,0	110,0	50,0	53,0	92,0	0,580	-0501300	(+)	-0502300	(+)	-0503300	107,35	-0504300	111,05	
65	24,0	127,0	66,0	70,0	109,0	0,730	-0651300	(+)	-0652300	(+)	-0653300	132,00	-0654300	136,50	
80	24,0	142,0	81,0	85,0	124,0	1,380	-0801300	(+)	-0802300	(+)	-0803300	142,40	-0804300	147,25	
100	24,0	162,0	100,0	104,0	144,0	1,640	-1001300	(+)	-1002300	(+)	-1003300	174,55	-1004300	180,50	

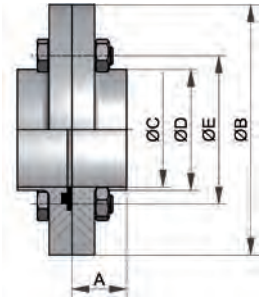
**Hygiene-
flanschverbindung**
**hygienic flange
connection**

Art-Nr. 14M10-								AISI 304/304L-1.4301/1.4307				AISI 316L-1.4404			
DN	A	B	C	D	E	Gew.	Art.-Nr.	Preis	Art.-Nr.	Preis	Art.-Nr.	Preis	Art.-Nr.	Preis	
mm	mm	mm	mm	mm	mm	kg	blank	EUR	matt	EUR	blank	EUR	matt	EUR	
25	24,0	83,0	26,0	29,0	65,0	0,410	-0251	(+)	-0252	(+)	-0253	33,45	-0254	34,95	
40	24,0	100,0	38,0	41,0	82,0	0,500	-0401	(+)	-0402	(+)	-0403	36,65	-0404	37,25	
50	24,0	110,0	50,0	53,0	92,0	0,580	-0501	(+)	-0502	(+)	-0503	41,85	-0504	43,75	
65	24,0	127,0	66,0	70,0	109,0	0,730	-0651	(+)	-0652	(+)	-0653	50,70	-0654	53,00	
80	24,0	142,0	81,0	85,0	124,0	1,380	-0801	(+)	-0802	(+)	-0803	54,80	-0804	57,30	
100	24,0	162,0	100,0	104,0	144,0	1,640	-1001	(+)	-1002	(+)	-1003	67,45	-1004	70,50	

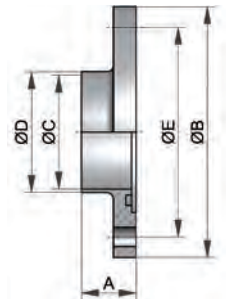
**Hygiene-
nutflansch**
**hygienic flange
with groove**

Montagesätze und Dichtungen siehe Seite 28

mounting kits and gaskets see page 28

Art-Nr. 14M20-								AISI 304/304L-1.4301/1.4307				AISI 316L-1.4404			
DN	A	B	C	D	E	Gew.	Art.-Nr.	Preis	Art.-Nr.	Preis	Art.-Nr.	Preis	Art.-Nr.	Preis	
mm	mm	mm	mm	mm	mm	kg	blank	EUR	matt	EUR	blank	EUR	matt	EUR	
25	24,0	83,0	26,0	29,0	65,0	0,410	-0251	(+)	-0252	(+)	-0253	31,90	-0254	33,35	
40	24,0	100,0	38,0	41,0	82,0	0,500	-0401	(+)	-0402	(+)	-0403	34,00	-0404	35,55	
50	24,0	110,0	50,0	53,0	92,0	0,580	-0501	(+)	-0502	(+)	-0503	39,90	-0504	41,70	
65	24,0	127,0	66,0	70,0	109,0	0,730	-0651	(+)	-0652	(+)	-0653	48,50	-0654	50,70	
80	24,0	142,0	81,0	85,0	124,0	1,380	-0801	(+)	-0802	(+)	-0803	52,30	-0804	54,65	
100	24,0	162,0	100,0	104,0	144,0	1,640	-1001	(+)	-1002	(+)	-1003	64,30	-1004	67,20	

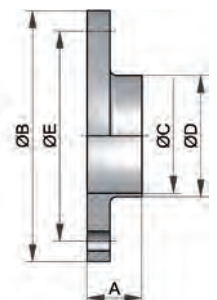
**Hygiene-
glattflansch**
**hygienic flange
without groove**

Montagesätze und Dichtungen siehe Seite 28

mounting kits and gaskets see page 28

(+) Preis auf Anfrage

(+) price on inquiry

Rohrverbindungen – Flanschverbindungen pipe connections – flanged pipe connections

Dichtring G Art.-Nr. 11100-

gasket

DN	A	B	C	D	E	Gew.	Art.-Nr.	Preis	Art.-Nr.	Preis	Art.-Nr.	Preis	Art.-Nr.	Preis
mm	mm	mm	mm	mm	mm	kg	VMQ	EUR	NBR	EUR	EPDM	EUR	FKM	EUR
10	4,5	12,0	20,0			0,001	-0100100	0,80	-0100200	0,25	-0100300	0,35	-0100400	2,45
15	4,5	18,0	26,0			0,002	-0150100	0,85	-0150200	0,25	-0150300	0,40	-0150400	2,50
20	4,5	23,0	33,0			0,003	-0200100	0,95	-0200200	0,25	-0200300	0,40	-0200400	2,85
25/1"	5,0	30,0	40,0			0,003	-0250100	1,00	-0250200	0,30	-0250300	0,45	-0250400	2,90
32/1,25"	5,0	36,0	46,0			0,004	-0320100	1,20	-0320200	0,30	-0320300	0,50	-0320400	3,35
40/1,5"	5,0	42,0	52,0			0,004	-0400100	1,40	-0400200	0,35	-0400300	0,55	-0400400	3,60
50/2"	5,0	54,0	64,0			0,005	-0500100	1,55	-0500200	0,40	-0500300	0,70	-0500400	4,15
65/2,5"	5,0	71,0	81,0			0,006	-0650100	2,20	-0650200	0,55	-0650300	1,00	-0650400	5,70
75/3"	5,0	78,0	88,0			0,008	-0750100	5,60	-0750200	1,75	-0750300	3,90	-0750400	13,10
80	5,0	85,0	95,0			0,008	-0800100	2,65	-0800200	0,75	-0800300	1,15	-0800400	7,00
90	5,0	94,0	104,0			0,010	-0900100	5,80	-0900200	1,90	-0900300	2,25	-0900400	16,90
100/4"	6,0	104,0	114,0			0,012	-1000100	4,60	-1000200	1,10	-1000300	1,45	-1000400	12,45
125	7,0	130,0	142,0			0,018	-1250100	6,45	-1250200	2,00	-1250300	2,90	-1250400	21,45
150	7,0	155,0	167,0			0,023	-1500100	7,95	-1500200	2,25	-1500300	3,70	-1500400	24,85
200	7,0	204,0	216,0			0,036	-2000100	30,35	-2000200	20,65	-2000300	23,80	-2000400	101,35

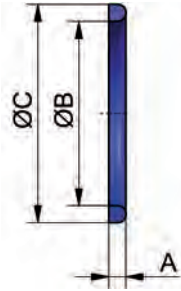

weitere Werkstoffe auf Anfrage

other gasket materials on inquiry

Hygienedichtung Art.-Nr. 14M00-

hygienic gasket

DN	A	B	C	D	E	Gew.	Art.-Nr.	Preis
mm	mm	mm	mm	mm	mm	kg	EPDM	EUR
25	5,3					0,003	-0250300	13,90
40	5,3					0,004	-0400300	15,70
50	5,3					0,005	-0500300	20,30
65	5,3					0,006	-0650300	27,50
80	5,3					0,008	-0800300	28,90
100	5,3					0,012	-1000300	36,40

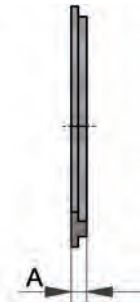

Montagesatz Flanschverbindung Art.-Nr. 14540-

assembly flange connection

DN	A	B	C	D	E	Gew.	Art.-Nr.	Preis
mm	mm	mm	mm	mm	mm	kg	A2/A4	EUR
*10-65						0,080	-0102000	5,30
*80-100						0,320	-0802000	6,40
*125-150						0,400	-1252000	7,10
#25-65						0,320	-0102000	5,30
#80-100						0,400	-0802010	6,40



* für Kleinflanschverbindung
für Hygienefflanschverbindung

* for flange connection
for hygienic flange connection

Rohrverbindungen – Flanschverbindungen
pipe connections – flanged pipe connections

Art.-Nr. 14200-							AISI 316L/316Ti-1.4404/1.4571		
DN	A	B	C	D	E	Gew.	Art.-Nr.	Preis	
mm	mm	mm	mm	mm	mm	kg	matt	EUR	
10	7,0	41,0	9,0	12,0		0,020	-0104	6,90	
15	7,0	45,0	15,0	18,0		0,025	-0154	6,90	
20	9,0	58,0	19,0	22,0		0,040	-0204	7,10	
25	12,0	68,0	25,0	28,0		0,060	-0254	7,10	
32	13,0	78,0	31,0	34,0		0,080	-0324	7,30	
40	17,0	88,0	37,0	40,0		0,090	-0404	8,10	
50	18,0	102,0	49,0	52,0		0,160	-0504	9,60	
65	23,0	122,0	66,0	70,0		0,260	-0654	13,75	
80	23,0	138,0	81,0	85,0		0,270	-0804	16,60	
100	27,0	158,0	100,0	104,0		0,300	-1004	20,00	
125	27,0	188,0	125,0	129,0		0,340	-1254	23,00	
150	27,0	212,0	150,0	154,0		0,400	-1504	27,60	
200	26,0	268,0	200,0	204,0		0,640	-2004	30,65	

andere Werkstoffe und Abmessungen auf Anfrage other materials and dimensions on request

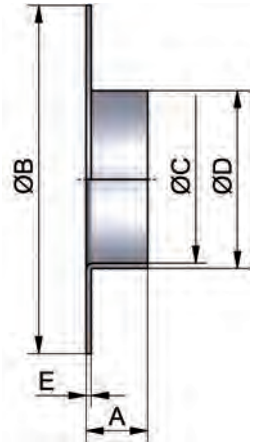
**Bördel
für DIN EN 10357**
**welding neck
for DIN EN 10357**

Art.-Nr. 14400-							AISI 304/321-1.4301/1.4541		
DN	A	B	C	D	E	Gew.	Art.-Nr.	Preis	
mm	mm	mm	mm	mm	mm	kg	blank	EUR	
10	14,0	90,0	16,0		60,0	0,540	-0101010	26,60	
15	14,0	95,0	22,0		65,0	0,600	-0151010	39,50	
20	14,0	105,0	28,0		75,0	0,900	-0201010	43,80	
25	16,0	115,0	33,0		85,0	1,070	-0251010	46,10	
32	16,0	140,0	42,0		100,0	1,270	-0321010	53,50	
40	16,0	150,0	50,0		110,0	1,710	-0401010	62,80	
50	16,0	165,0	62,0		125,0	2,350	-0501010	78,20	
65	16,0	185,0	81,0		145,0	2,850	-0651010	88,50	
80	18,0	200,0	94,0		160,0	3,400	-0801010	94,50	
100	18,0	220,0	113,0		180,0	4,030	-1001010	118,10	
125	18,0	250,0	138,0		210,0	6,350	-1251010	175,00	
150	18,0	285,0	164,0		240,0	7,950	-1501010	188,00	
200	20,0	340,0	225,0		295,0	10,350	-2001010	243,30	

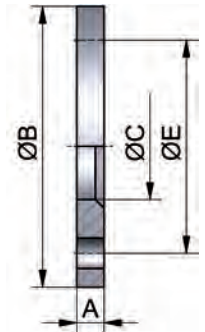
**Losflansch
DIN 2642 PN10**
loose flange PN10

Art.-Nr. 14400-							Aluminium			
DN	A	B	C	D	E	Gew.	Art.-Nr.	Preis	Art.-Nr.	Preis
mm	mm	mm	mm	mm	mm	kg	blank	EUR	beschichtet/coated	EUR
10	12,0	90,0	16,0		60,0	0,230	-0105010	5,60	-0106010	6,90
15	12,0	95,0	23,0		65,0	0,240	-0155010	5,60	-0156010	6,90
20	12,0	105,0	28,0		75,0	0,320	-0205010	6,90	-0206010	8,40
25	12,0	115,0	33,0		85,0	0,380	-0255010	6,90	-0256010	8,40
32	16,0	140,0	41,0		100,0	0,550	-0325010	8,80	-0326010	10,70
40	16,0	150,0	48,0		110,0	0,650	-0405010	9,50	-0406010	12,10
50	16,0	165,0	60,0		125,0	0,840	-0505010	12,00	-0506010	15,80
65	16,0	185,0	73,0		145,0	1,000	-0655010	15,20	-0656010	18,10
80	18,0	200,0	90,0		160,0	1,200	-0805010	16,40	-0806010	19,80
100	18,0	220,0	111,0		180,0	1,400	-1005010	17,80	-1006010	22,10
125	18,0	250,0	136,0		210,0	1,850	-1255010	23,40	-1256010	29,80
150	18,0	285,0	161,0		240,0	2,250	-1505010	30,40	-1506010	38,70
200	20,0	340,0	212,0		295,0	3,250	-2005010	43,10	-2006010	50,90

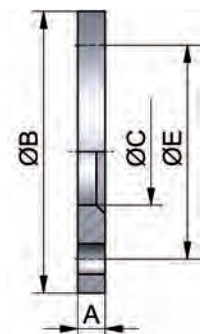
**Losflansch
Typ A PN 10**
loose flange PN10

Rohrverbindungen – Flanschverbindungen
pipe connections – flanged pipe connections
Bördeldichtung Art.-Nr. 14202-

flat seal for neck

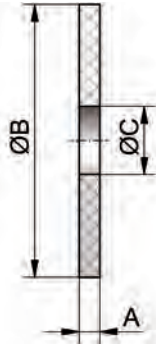

DN	A	B	C	D	E	Gew.	Art.-Nr.	Preis
mm	mm	mm	mm	mm	mm	kg	NBR	EUR
10	3,0	40,0	10,0			0,010	-0100200	2,90
15	3,0	45,0	16,0			0,010	-0150200	2,90
20	3,0	58,0	20,0			0,010	-0200200	2,90
25	3,0	68,0	25,0			0,010	-0250200	3,20
32	3,0	78,0	32,0			0,010	-0320200	3,50
40	4,0	88,0	38,0			0,010	-0400200	3,70
50	4,0	102,0	50,0			0,030	-0500200	3,80
65	4,0	122,0	66,0			0,040	-0650200	3,90
80	4,0	138,0	81,0			0,050	-0800200	4,70
100	4,0	158,0	100,0			0,060	-1000200	5,50
125	4,0	188,0	125,0			0,080	-1250200	5,90
150	4,0	212,0	150,0			0,080	-1500200	8,20
200	4,0	268,0	200,0			0,120	-2000200	9,10

weitere Dichtungswerkstoffe auf Anfrage

other gasket materials on inquiry

Glatter Flansch PN10

plain flange PN10

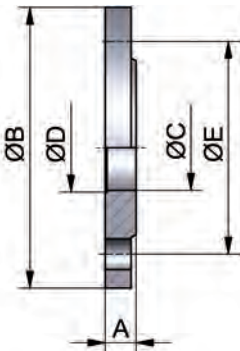
Art.-Nr. 14300-
AISI 304/304L-1.4301/1.4307
AISI 316L-1.4404

DN	A	B	C	D	E	Gew.	AISI 304/304L-1.4301/1.4307		AISI 316L-1.4404					
							Art.-Nr.	Preis	Art.-Nr.	Preis				
mm	mm	mm	mm	mm	mm	kg	blank	EUR	blank	EUR				
10	14,0	90,0	10,0	12,2	60,0	0,560	-0101	26,60	-0102	27,70	-0103	28,65	-0104	29,75
15	14,0	95,0	16,0	18,2	65,0	0,630	-0151	27,10	-0152	28,20	-0153	29,30	-0154	30,40
20	16,0	105,0	20,0	22,2	75,0	0,890	-0201	27,85	-0202	29,00	-0203	31,40	-0204	32,55
25	16,0	115,0	26,0	28,2	85,0	1,050	-0251	28,60	-0252	29,75	-0253	35,15	-0254	36,30
32	16,0	140,0	32,0	34,2	100,0	1,550	-0321	57,10	-0322	59,40	-0323	61,55	-0324	63,85
40	16,0	150,0	38,0	40,2	110,0	1,730	-0401	43,95	-0402	45,75	-0403	54,60	-0404	56,40
50	18,0	165,0	50,0	52,2	125,0	2,340	-0501	50,35	-0502	51,40	-0503	70,90	-0504	71,95
65	18,0	185,0	66,0	70,3	145,0	2,850	-0651	63,90	-0652	65,20	-0653	87,75	-0654	89,05
80	20,0	200,0	81,0	85,3	160,0	3,400	-0801	79,25	-0802	80,85	-0803	105,25	-0804	106,85
100	20,0	220,0	100,0	104,3	180,0	4,080	-1001	109,95	-1002	112,15	-1003	135,50	-1004	137,70
125	22,0	250,0	125,0	129,5	210,0	6,350	-1251	144,70	-1252	147,60	-1253	172,30	-1254	175,20
150	22,0	285,0	150,0	154,5	240,0	7,950	-1501	169,50	-1502	172,90	-1503	234,50	-1504	237,90
200	24,0	340,0	200,0	204,5	295,0	10,450	-2001	243,30	-2002	248,20	-2003	314,70	-2004	319,60

Flansch mit Schweißende

flange with welding end

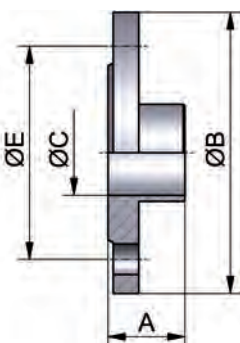
Art.-Nr. 14700-
AISI 304/304L-1.4301/1.4307
AISI 316L-1.4404

DN	A	B	C	D	E	Gew.	AISI 304/304L-1.4301/1.4307		AISI 316L-1.4404					
							Art.-Nr.	Preis	Art.-Nr.	Preis				
mm	mm	mm	mm	mm	mm	kg	blank	EUR	blank	EUR				
10	35,0	90,0	10,0		60,0	0,510	-0101	51,10	-0102	53,15	-0103	94,60	-0104	96,65
15	35,0	95,0	16,0		65,0	0,620	-0151	52,35	-0152	54,45	-0153	83,55	-0154	85,65
20	38,0	105,0	20,0		75,0	0,620	-0201	56,75	-0202	59,05	-0203	72,10	-0204	74,40
25	38,0	115,0	26,0		85,0	1,000	-0251	55,60	-0252	57,85	-0253	71,20	-0254	73,45
32	40,0	140,0	32,0		100,0	1,510	-0321	86,20	-0322	89,65	-0323	103,35	-0324	106,80
40	42,0	150,0	38,0		110,0	1,620	-0401	78,20	-0402	81,35	-0403	84,05	-0404	87,20
50	45,0	165,0	50,0		125,0	2,140	-0501	89,75	-0502	91,55	-0503	97,15	-0504	98,95
65	45,0	185,0	66,0		145,0	2,660	-0651	106,70	-0652	108,85	-0653	116,50	-0654	118,65
80	50,0	200,0	81,0		160,0	3,170	-0801	131,25	-0802	133,90	-0803	146,00	-0804	148,65
100	52,0	220,0	100,0		180,0	4,040	-1001	178,50	-1002	182,10	-1003	199,20	-1004	202,80

Rohrverbindungen – Flanschverbindungen
pipe connections – flanged pipe connections
Art.-Nr. 14820-

Art.-Nr. 14820-							AISI 304/321-1.4301/1.4541		AISI 316L/316Ti-1.4404/1.4571	
DN	A	B	C	D	E	Gew.	Art.-Nr.	Preis	Art.-Nr.	Preis
mm	mm	mm	mm	mm	mm	kg	blank	EUR	blank	EUR
10	35,0	90,0	13,0	10,0	60,0	0,580	-0101016	40,55	-0103016	43,85
15	35,0	95,0	19,0	16,0	65,0	0,648	-0151016	43,85	-0153016	47,40
20	38,0	105,0	23,0	20,0	75,0	0,952	-0201016	47,50	-0203016	51,40
25	38,0	115,0	29,0	26,0	85,0	1,140	-0251016	51,70	-0253016	55,90
32	40,0	140,0	35,0	32,0	100,0	1,690	-0321016	72,10	-0323016	77,90
40	42,0	150,0	41,0	38,0	110,0	1,860	-0401016	83,85	-0403016	90,50
50	45,0	165,0	53,0	50,0	125,0	2,530	-0501016	84,70	-0503016	91,50
65	45,0	185,0	70,0	66,0	145,0	3,060	-0651016	98,35	-0653016	106,25
80	50,0	200,0	85,0	81,0	160,0	3,700	-0801016	114,75	-0803016	123,90
100	52,0	220,0	104,0	100,0	180,0	4,620	-1001016	147,05	-1003016	158,85
125	55,0	250,0	129,0	125,0	210,0	6,300	-1251016	206,00	-1253016	222,50
150	55,0	285,0	154,0	150,0	240,0	7,750	-1501016	242,25	-1503016	261,60
200	62,0	340,0	204,0	200,0	295,0	11,000	-2001016	399,20	-2003016	431,30

weitere Druckstufen auf Anfrage other pressure ranges on inquiry

**Vorschweißflansch
DIN 2633 PN16
für Rohre
EN 10357 Serie A**

**welding neck flange
DIN 2633
for pipes
EN 10357 series A**

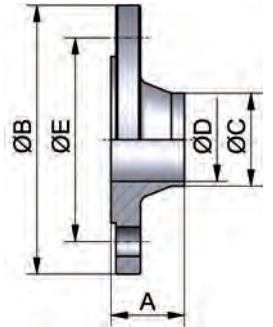

Art.-Nr. 14800-

Art.-Nr. 14800-							AISI 304/321-1.4301/1.4541		AISI 316L/316Ti-1.4404/1.4571	
DN	A	B	C	D	E	Gew.	Art.-Nr.	Preis	Art.-Nr.	Preis
mm	mm	mm	mm	mm	mm	kg	blank	EUR	blank	EUR
10	35,0	90,0	14,0	10,4	60,0	0,580	-0101016	42,00	-0103016	46,00
15	35,0	95,0	20,0	16,0	65,0	0,648	-0151016	42,00	-0153016	46,00
20	38,0	105,0	25,0	20,4	75,0	0,952	-0201016	45,00	-0203016	49,00
25	38,0	115,0	30,0	24,8	85,0	1,140	-0251016	50,40	-0253016	54,80
32	40,0	140,0	38,0	32,8	100,0	1,690	-0321016	68,10	-0323016	72,40
40	42,0	150,0	44,5	39,3	110,0	1,860	-0401016	76,20	-0403016	82,25
50	45,0	165,0	57,0	51,2	125,0	2,530	-0501016	77,00	-0503016	83,15
65*	45,0	185,0	76,1	70,3	145,0	3,060	-0651016	89,40	-0653016	96,55
80*	50,0	200,0	88,9	82,5	160,0	3,700	-0801016	104,30	-0803016	112,60
100	52,0	220,0	108,0	100,8	180,0	4,620	-1001016	133,65	-1003016	144,40
125	55,0	250,0	133,0	125,0	210,0	6,300	-1251016	187,25	-1253016	202,25
150	55,0	285,0	159,0	150,0	240,0	7,750	-1501016	220,20	-1503016	237,80
200*	62,0	340,0	219,1	207,3	295,0	11,000	-2001016	380,00	-2003016	415,00

weitere Druckstufen auf Anfrage other pressure ranges on inquiry
 * DIN 2633-R1 * DIN 2633-R1

**Vorschweißflansch
DIN 2633-R2 PN16**

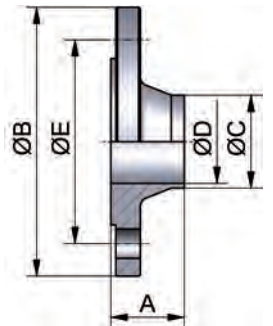
**welding neck flange
DIN 2633-R2 PN16**



Art.-Nr. 14808-

Art.-Nr. 14808-							AISI 304/321-1.4301/1.4541		AISI 316L/316Ti-1.4404/1.4571	
DN	A	B	C	D	E	Gew.	Art.-Nr.	Preis	Art.-Nr.	Preis
mm	mm	mm	mm	mm	mm	kg	blank	EUR	blank	EUR
10	35,0	90,0	17,2	13,6	60,0	0,580	-0101016	36,85	-0103016	39,85
15	35,0	95,0	21,3	17,3	65,0	0,648	-0151016	39,85	-0153016	43,05
20	38,0	105,0	26,9	22,3	75,0	0,952	-0201016	43,20	-0203016	46,70
25	38,0	115,0	33,7	28,5	85,0	1,140	-0251016	47,00	-0253016	50,80
32	40,0	140,0	42,4	37,2	100,0	1,690	-0321016	65,55	-0323016	70,80
40	42,0	150,0	48,3	43,1	110,0	1,860	-0401016	76,20	-0403016	82,25
50	45,0	165,0	60,3	54,5	125,0	2,530	-0501016	77,00	-0503016	83,15
65	45,0	185,0	76,1	70,3	145,0	3,060	siehe Artikel 148000651016	89,40	siehe Artikel 148000653016	96,55
80	50,0	200,0	88,9	82,5	160,0	3,700	siehe Artikel 148000801016	104,30	siehe Artikel 148000803016	112,60
100	52,0	220,0	114,3	107,1	180,0	4,620	-1001016	133,65	-1003016	144,40
125	55,0	250,0	139,7	131,7	210,0	6,300	-1251016	187,25	-1253016	202,25
150	55,0	285,0	168,3	159,3	240,0	7,750	-1501016	220,20	-1503016	237,80
200	62,0	340,0	219,1	207,3	295,0	11,000	siehe Artikel 148002001016	380,00	siehe Artikel 148002003016	415,00

weitere Druckstufen auf Anfrage other pressure ranges on inquiry

**Vorschweißflansch
DIN 2633-R1 PN16**

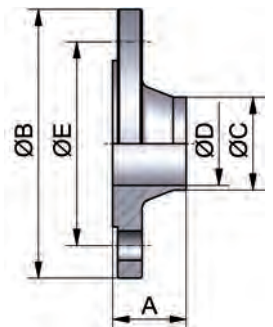
**welding neck flange
DIN 2633-R1 PN16**

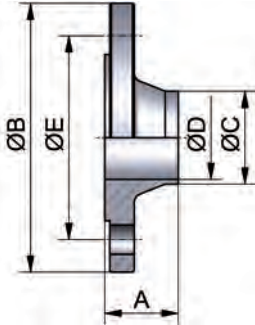

Rohrverbindungen – Flanschverbindungen
pipe connections – flanged pipe connections
**Vorschweißflansch
EN 1092-1
PN40/PN16**
**welding neck
flange EN 1092-1
PN40/PN16**

Art.-Nr. 14711-

DN	A	B	C	D	E	Gew.
mm	mm	mm	mm	mm	mm	kg
*10	35,0	90,0	17,2	13,6	60,0	0,500
*15	38,0	95,0	21,3	17,3	65,0	1,000
*20	40,0	105,0	26,9	22,3	75,0	1,000
*25	40,0	115,0	33,7	28,5	85,0	1,000
*32	42,0	140,0	42,4	37,2	100,0	2,000
*40	45,0	150,0	48,3	43,1	110,0	2,000
#50	45,0	165,0	60,3	54,5	125,0	2,800
#65	45,0	185,0	76,1	70,3	145,0	3,500
#80	50,0	200,0	88,9	82,5	160,0	4,000
#100	52,0	220,0	114,3	107,1	180,0	4,500
#125	55,0	250,0	139,7	131,7	210,0	6,500
#150	55,0	285,0	168,3	159,3	240,0	7,500

AISI 316L/316Ti-1.4404/1.4571

Art.-Nr.	Preis
blank	EUR
-0105140	19,00
-0155140	20,00
-0205140	29,80
-0255140	29,20
-0325140	52,20
-0405140	47,50
-0505116	52,10
-0655116	58,20
-0805116	70,40
-1005116	88,50
-1255116	(+)
-1505116	(+)

 * PN40
PN16

 * PN40
PN16

**Blindflansch
DIN 2527-B**

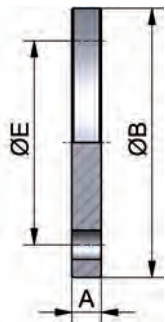
**blind flange
DIN 2527-B**

Art.-Nr. 15000-

DN	A	B	C	D	E	Gew.
mm	mm	mm	mm	mm	mm	kg
10	14,0	90,0			60,0	0,690
15	14,0	95,0			65,0	0,770
20	16,0	105,0			75,0	1,080
25	16,0	115,0			85,0	1,300
32	16,0	140,0			100,0	1,930
40	16,0	150,0			110,0	2,210
50	18,0	165,0			125,0	3,020
65	18,0	185,0			145,0	4,830
80	20,0	200,0			160,0	6,280
100	20,0	220,0			180,0	7,590
125	22,0	250,0			210,0	8,470
150	22,0	285,0			240,0	11,010
200	24,0	340,0			295,0	22,080

AISI 304/304L-1.4301/1.4307

AISI 316L-1.4404

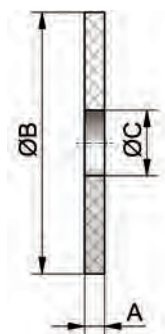
Art.-Nr.	Preis	Art.-Nr.	Preis
blank	EUR	blank	EUR
-0101016	37,10	-0103016	39,10
-0151016	40,10	-0153016	44,20
-0201016	45,20	-0203016	49,50
-0251016	50,40	-0253016	56,10
-0321016	62,80	-0323016	69,20
-0401016	73,10	-0403016	78,20
-0501016	76,20	-0503016	84,10
-0651016	83,20	-0653016	95,50
-0801016	94,50	-0803016	116,10
-1001016	128,10	-1003016	146,80
-1251016	134,50	-1253016	158,10
-1501016	172,00	-1503016	193,00
-2001016	285,00	-2003016	420,00

**Flanschdichtung
flat seal for flange**
Art.-Nr. 14900-

DN	A	B	C	D	E	Gew.
mm	mm	mm	mm	mm	mm	kg
10	3,0	40,0	10,0			0,004
15	3,0	45,0	16,0			0,006
20	3,0	58,0	20,0			0,010
25	3,0	68,0	26,0			0,012
32	3,0	78,0	32,0			0,015
40	4,0	88,0	38,0			0,025
50	4,0	102,0	50,0			0,034
65	4,0	122,0	66,0			0,045
80	4,0	138,0	81,0			0,057
100	4,0	158,0	100,0			0,060
125	4,0	188,0	125,0			0,089
150	4,0	212,0	150,0			0,102
200	4,0	268,0	200,0			0,124

Art.-Nr.	Preis
NBR	EUR
-0100200	3,80
-0150200	3,90
-0200200	4,00
-0250200	4,10
-0320200	4,80
-0400200	4,90
-0500200	5,10
-0650200	5,20
-0800200	5,60
-1000200	5,90
-1250200	6,90
-1500200	8,90
-2000200	9,95

 weitere Dichtungswerkstoffe auf Anfrage
 (+) Preis auf Anfrage

 other gasket materials on inquiry
 (+) price on inquiry