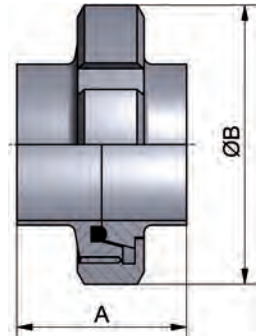

Rohrverbindungen – Verschraubungen
pipe connections – screwed pipe connections
Art.-Nr. 11222-

								AISI 304/304L-1.4301/1.4307				AISI 316L-1.4404			
DN	A	B	C	D	E	Gew.	Art.-Nr.	Preis	Art.-Nr.	Preis	Art.-Nr.	Preis	Art.-Nr.	Preis	
mm	mm	mm	mm	mm	mm	kg	bl. NBR	EUR	matt NBR	EUR	bl. NBR	EUR	matt NBR	EUR	
10	34,0	38,0				0,122	-0101200	16,25	-0102200	17,00	-0103200	18,55	-0104200	19,30	
15	34,0	44,0				0,159	-0151200	19,50	-0152200	20,35	-0153200	22,80	-0154200	23,65	
20	36,0	54,0				0,279	-0201200	21,35	-0202200	22,25	-0203200	25,15	-0204200	26,05	
25	45,0	63,0				0,385	-0251200	20,75	-0252200	22,55	-0253200	24,50	-0254200	26,30	
32	51,0	70,0				0,486	-0321200	24,85	-0322200	25,95	-0323200	29,50	-0324200	30,60	
40	53,0	78,0				0,587	-0401200	25,00	-0402200	26,10	-0403200	29,65	-0404200	30,75	
50	57,0	92,0				0,800	-0501200	29,30	-0502200	30,00	-0503200	34,25	-0504200	34,95	
65	65,0	112,0				1,238	-0651200	44,05	-0652200	45,00	-0653200	53,05	-0654200	54,00	
80	75,0	127,0				1,735	-0801200	68,70	-0802200	70,15	-0803200	81,05	-0804200	82,50	
100	89,0	148,0				2,744	-1001200	98,85	-1002200	100,85	-1003200	118,70	-1004200	120,70	
125	70,0	178,0				3,550	-1251200	181,10	-1252200	184,90	-1253200	241,00	-1254200	244,80	
150	76,0	210,0				5,620	-1501200	310,85	-1502200	317,45	-1503200	416,45	-1504200	423,05	

 für Rohre gemäß DIN EN 10357
 wird in Einzelteilen geliefert

 for pipes as per DIN EN 10357
 delivered in single components

**Verschraubung
DIN 11851-S**
**welding union
DIN 11851-S**
Art.-Nr. 11202-

								AISI 304/304L-1.4301/1.4307				AISI 316L-1.4404			
DN	A	B	C	D	E	Gew.	Art.-Nr.	Preis	Art.-Nr.	Preis	Art.-Nr.	Preis	Art.-Nr.	Preis	
mm	mm	mm	mm	mm	mm	kg	bl. NBR	EUR	matt NBR	EUR	bl. NBR	EUR	matt NBR	EUR	
10	34,0	38,0			ID 10	0,122	-0101200	16,25	-0102200	17,00	-0103200	18,55	-0104200	19,30	
15	34,0	44,0			ID 16	0,159	-0151200	19,50	-0152200	20,35	-0153200	22,80	-0154200	23,65	
20	36,0	54,0			ID 20	0,279	-0201200	21,35	-0202200	22,25	-0203200	25,15	-0204200	26,05	
25	45,0	63,0			ID 26	0,385	-0251200	20,75	-0252200	22,55	-0253200	24,50	-0254200	26,30	
32	51,0	70,0			ID 32	0,486	-0321200	24,85	-0322200	25,95	-0323200	29,50	-0324200	30,60	
40	53,0	78,0			ID 38	0,587	-0401200	25,00	-0402200	26,10	-0403200	29,65	-0404200	30,75	
50	57,0	92,0			ID 50	0,800	-0501200	29,30	-0502200	30,00	-0503200	34,25	-0504200	34,95	
65	65,0	112,0			ID 66	1,238	-0651200	44,05	-0652200	45,00	-0653200	53,05	-0654200	54,00	
80	75,0	127,0			ID 81	1,735	-0801200	68,70	-0802200	70,15	-0803200	81,05	-0804200	82,50	
100	89,0	148,0			ID 100	2,744	-1001200	98,85	-1002200	100,85	-1003200	118,70	-1004200	120,70	
125	70,0	178,0			ID 125	3,550	-1251200	181,10	-1252200	184,90	-1253200	241,00	-1254200	244,80	
150	76,0	210,0			ID 150	5,620	-1501200	310,85	-1502200	317,45	-1503200	416,45	-1504200	423,05	
200	74,0	260,0			ID 200	6,820	-2001200	1600,70	-2002200	1632,35	-2003200	1969,60	-2004200	2001,25	

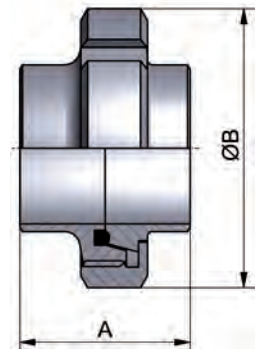
 für Rohre gemäß DIN EN 10357
 wird in Einzelteilen geliefert
 ID: Innendurchmesser Rohr

 for pipes as per DIN EN 10357
 delivered in single components
 ID: inside diameter pipe

Verschraubung S
welding union
Art.-Nr. 11203-

								AISI 304/304L-1.4301/1.4307				AISI 316L-1.4404			
DN	A	B	C	D	E	Gew.	Art.-Nr.	Preis	Art.-Nr.	Preis	Art.-Nr.	Preis	Art.-Nr.	Preis	
mm	mm	mm	mm	mm	mm	kg	bl. NBR	EUR	matt NBR	EUR	bl. NBR	EUR	matt NBR	EUR	
1"	45,0	63,0			ID 22,9	0,433	-1001200	21,30	-1002200	22,35	-1003200	25,20	-1004200	26,25	
1,5"	53,0	78,0			ID 35,1	0,654	-1121200	25,85	-1122200	27,05	-1123200	30,65	-1124200	31,85	
2"	57,0	92,0			ID 47,8	0,899	-2001200	30,10	-2002200	30,80	-2003200	35,25	-2004200	35,95	
2,5"	65,0	112,0			ID 60,2	1,462	-2121200	45,15	-2122200	46,20	-2123200	54,50	-2124200	55,55	
3"	65,0	119,0			ID 72,8	1,448	-3001200	73,25	-3002200	74,85	-3003200	86,10	-3004200	87,70	
4"	89,0	148,0			ID 97,4	2,777	-4001200	101,45	-4002200	103,60	-4003200	122,10	-4004200	124,25	

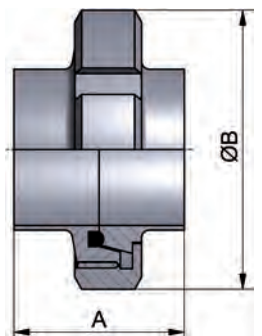
 ID: Innendurchmesser Rohr
 wird in Einzelteilen geliefert

 ID: inside diameter pipe
 delivered in single components

Verschraubung Zoll
welding union inch

Rohrverbindungen – Verschraubungen pipe connections – screwed pipe connections

Verschraubung ISO

Art.-Nr. 11208-

AISI 304/304L-1.4301/1.4307

AISI 316L-1.4404

welding union ISO

DN	A	B	C	D	E	Gew.	Art.-Nr.	Preis	Art.-Nr.	Preis	Art.-Nr.	Preis	Art.-Nr.	Preis
mm	mm	mm	mm	mm	mm	kg	bl. NBR	EUR	bl. NBR	EUR	bl. NBR	EUR	bl. NBR	EUR
17,2	34,0	38,0			17,2	0,130	-0101200	22,90	-0102200	23,90	-0103200	32,45	-0104200	33,45
21,3	34,0	44,0			21,3	0,160	-0151200	25,30	-0152200	26,35	-0153200	34,65	-0154200	35,75
26,9	36,0	54,0			26,9	0,290	-0201200	25,35	-0202200	26,45	-0203200	34,65	-0204200	35,75
33,7	45,0	63,0			33,7	0,400	-0251200	27,90	-0252200	29,10	-0253200	37,25	-0254200	38,45
42,4	51,0	70,0			42,4	0,490	-0321200	30,15	-0322200	31,40	-0323200	39,90	-0324200	41,15
48,3	53,0	78,0			48,3	0,610	-0401200	31,00	-0402200	32,10	-0403200	40,60	-0404200	41,70
60,3	57,0	92,0			60,3	0,860	-0501200	35,50	-0502200	36,30	-0503200	46,05	-0504200	46,85
76,1	65,0	112,0			76,1	1,130	-0651200	51,80	-0652200	52,90	-0653200	65,10	-0654200	66,20
88,9	75,0	127,0			88,9	1,800	-0801200	80,25	-0802200	81,90	-0803200	101,60	-0804200	103,25
114,3	89,0	148,0			114,3	2,460	-1001200	114,75	-1002200	117,10	-1003200	141,75	-1004200	144,10
139,7	70,0	178,0			139,7	1,800	-1251200	(+)	-1252200	(+)	-1253200	(+)	-1254200	(+)
168,3	76,0	210,0			168,3	2,460	-1501200	(+)	-1502200	(+)	-1503200	(+)	-1504200	(+)

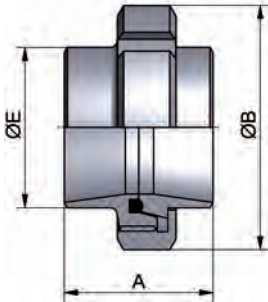

wird in Einzelteilen geliefert

delivered in single components

Verschraubung Walz

Art.-Nr. 11200-

AISI 304/304L-1.4301/1.4307

AISI 316L-1.4404

expanding union

DN	A	B	C	D	E	Gew.	Art.-Nr.	Preis	Art.-Nr.	Preis	Art.-Nr.	Preis	Art.-Nr.	Preis
mm	mm	mm	mm	mm	mm	kg	bl. NBR	EUR	bl. NBR	EUR	bl. NBR	EUR	bl. NBR	EUR
10	34,0	38,0			OD 12	0,131	-0101200	17,80	-0102200	18,55	-0103200	20,25	-0104200	21,00
15	34,0	44,0			OD 18	0,162	-0151200	20,75	-0152200	21,60	-0153200	24,60	-0154200	25,45
20	36,0	54,0			OD 22	0,292	-0201200	22,50	-0202200	23,40	-0203200	26,70	-0204200	27,60
25	45,0	63,0			OD 28	0,399	-0251200	22,25	-0252200	23,20	-0253200	26,10	-0254200	27,05
32	51,0	70,0			OD 34	0,489	-0321200	25,50	-0322200	26,60	-0323200	30,00	-0324200	31,10
40	53,0	78,0			OD 40	0,605	-0401200	25,80	-0402200	26,90	-0403200	30,50	-0404200	31,60
50	57,0	92,0			OD 52	0,856	-0501200	30,20	-0502200	30,90	-0503200	36,05	-0504200	36,75
65	65,0	112,0			OD 70	1,328	-0651200	46,70	-0652200	47,65	-0653200	56,25	-0654200	57,20
80	75,0	127,0			OD 85	1,795	-0801200	72,70	-0802200	74,20	-0803200	86,35	-0804200	87,85
100	89,0	148,0			OD 104	2,459	-1001200	105,40	-1002200	107,50	-1003200	127,90	-1004200	130,00

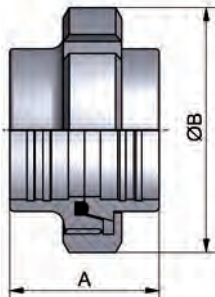

OD: Aussendurchmesser Rohr
wird in Einzelteilen geliefert

OD: outside diameter pipe
delivered in single components

Verschraubung Walz

Art.-Nr. 11201-

AISI 304/304L-1.4301/1.4307

AISI 316L-1.4404

Zoll

expanding union

inch

DN	A	B	C	D	E	Gew.	Art.-Nr.	Preis	Art.-Nr.	Preis	Art.-Nr.	Preis	Art.-Nr.	Preis
mm	mm	mm	mm	mm	mm	kg	bl. NBR	EUR	bl. NBR	EUR	bl. NBR	EUR	bl. NBR	EUR
1"	45,0	63,0			OD 25,4	0,433	-1001200	22,55	-1002200	23,50	-1003200	26,80	-1004200	27,75
1,5"	53,0	78,0			OD 38,1	0,654	-1121200	26,70	-1122200	27,85	-1123200	31,70	-1124200	32,85
2"	57,0	92,0			OD 50,8	0,899	-2001200	31,00	-2002200	31,70	-2003200	36,75	-2004200	37,45
2,5"	65,0	112,0			OD 63,5	1,462	-2121200	49,80	-2122200	50,85	-2123200	59,65	-2124200	60,70
3"	65,0	119,0			OD 76,1	1,448	-3001200	81,80	-3002200	83,45	-3003200	98,25	-3004200	99,90
4"	89,0	148,0			OD 101,6	2,777	-4001200	114,70	-4002200	116,95	-4003200	138,00	-4004200	140,25

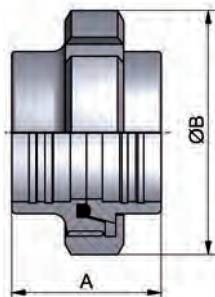

OD: Aussendurchmesser Rohr
wird in Einzelteilen geliefert
(+) Preis auf Anfrage

OD: outside diameter pipe
delivered in single components
(+) price on inquiry

Rohrverbindungen – Verschraubungen
pipe connections – screwed pipe connections
Art.-Nr. 11320-

							AISI 304/304L-1.4301/1.4307				AISI 316L-1.4404			
DN	A	B	C	D	E	Gew.	Art.-Nr.	Preis	Art.-Nr.	Preis	Art.-Nr.	Preis	Art.-Nr.	Preis
mm	mm	mm	mm	mm	mm	kg	blank	EUR	matt	EUR	blank	EUR	matt	EUR
10	21,0	10,0	13,0		Rd28x1/8	0,030	-0101	6,20	-0102	6,50	-0103	7,90	-0104	8,20
15	21,0	16,0	19,0		Rd34x1/8	0,040	-0151	6,95	-0152	7,25	-0153	8,95	-0154	9,25
20	24,0	20,0	23,0		Rd44x1/6	0,080	-0201	8,25	-0202	8,60	-0203	10,70	-0204	11,05
25	29,0	26,0	29,0		Rd52x1/6	0,120	-0251	7,55	-0252	7,90	-0253	9,75	-0254	10,10
32	32,0	32,0	35,0		Rd58x1/6	0,140	-0321	9,00	-0322	9,40	-0323	11,85	-0324	12,25
40	33,0	38,0	41,0		Rd65x1/6	0,150	-0401	9,30	-0402	9,70	-0403	12,10	-0404	12,50
50	35,0	50,0	53,0		Rd78x1/6	0,240	-0501	10,65	-0502	10,90	-0503	13,85	-0504	14,10
65	40,0	66,0	70,0		Rd95x1/6	0,370	-0651	16,10	-0652	16,45	-0653	21,25	-0654	21,60
80	45,0	81,0	85,0		Rd110x1/4	0,540	-0801	24,85	-0802	25,35	-0803	32,10	-0804	32,60
100	54,0	100,0	104,0		Rd130x1/4	0,700	-1001	36,40	-1002	37,15	-1003	47,90	-1004	48,65
125	46,0	125,0	129,0		Rd160x1/4	1,130	-1251	65,90	-1252	67,25	-1253	97,80	-1254	99,15
150	50,0	150,0	154,0		Rd190x1/4	1,770	-1501	114,00	-1502	116,35	-1503	168,90	-1504	171,25

 Rd: Rundgewinde - auf Anfrage mit APZ 3.1/AD2000-W2
 Dichtungen siehe Seite 11

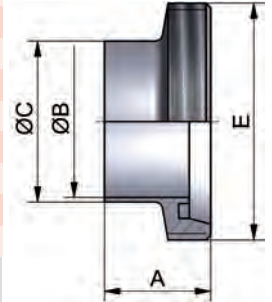
 Rd: round thread - on inquiry with certificate 3.1/AD2000-W2
 gaskets see page 11

**Gewindestutzen
DIN 11851-SC**
**welding male part
DIN 11851-SC**
Art.-Nr. 11420-

							AISI 304/304L-1.4301/1.4307				AISI 316L-1.4404			
DN	A	B	C	D	E	Gew.	Art.-Nr.	Preis	Art.-Nr.	Preis	Art.-Nr.	Preis	Art.-Nr.	Preis
mm	mm	mm	mm	mm	mm	kg	blank	EUR	matt	EUR	blank	EUR	matt	EUR
10	17,0	10,0	13,0		22,5	0,010	-0101	3,90	-0102	4,10	-0103	4,30	-0104	4,50
15	17,0	16,0	19,0		28,5	0,010	-0151	4,20	-0152	4,40	-0153	5,15	-0154	5,35
20	18,0	20,0	23,0		36,5	0,040	-0201	4,70	-0202	4,90	-0203	6,05	-0204	6,25
25	22,0	26,0	29,0		44,0	0,070	-0251	4,95	-0252	6,05	-0253	6,50	-0254	7,60
32	25,0	32,0	35,0		50,0	0,120	-0321	6,40	-0322	6,70	-0323	8,20	-0324	8,50
40	26,0	38,0	41,0		56,0	0,130	-0401	6,40	-0402	6,70	-0403	8,25	-0404	8,55
50	28,0	50,0	53,0		68,5	0,150	-0501	7,60	-0502	7,80	-0503	9,35	-0504	9,55
65	32,0	66,0	70,0		86,0	0,310	-0651	10,90	-0652	11,15	-0653	14,75	-0654	15,00
80	37,0	81,0	85,0		100,0	0,380	-0801	17,40	-0802	17,80	-0803	22,50	-0804	22,90
100	44,0	100,0	104,0		121,0	0,600	-1001	26,70	-1002	27,25	-1003	35,05	-1004	35,60
125	34,0	125,0	129,0		150,0	0,760	-1251	51,90	-1252	53,00	-1253	79,90	-1254	81,00
150	37,0	150,0	154,0		176,0	1,030	-1501	98,80	-1502	101,05	-1503	149,50	-1504	151,75

auf Anfrage mit APZ 3.1/AD2000-W2

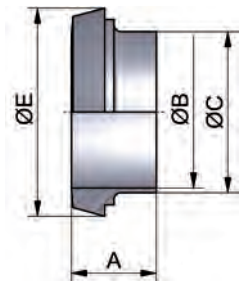
on inquiry with certificate 3.1/AD2000-W2

**Kegelstutzen
DIN 11851-SD**
**welding liner
DIN 11851-SD**
Art.-Nr. 11000-

							AISI 304/304L-1.4301/1.4307				AISI 316L-1.4404			
DN	A	B	C	D	E	Gew.	Art.-Nr.	Preis	Art.-Nr.	Preis	Art.-Nr.	Preis	Art.-Nr.	Preis
mm	mm	mm	mm	mm	mm	kg	blank	EUR	matt	EUR	blank	EUR	matt	EUR
10	18,0	3,0	38,0	19,0	Rd28x1/8	0,060	-0101	6,50	-0102	6,00	-0103	8,80	-0104	9,10
15	18,0	3,0	44,0	25,0	Rd34x1/8	0,080	-0151	8,45	-0152	8,80	-0153	10,90	-0154	11,25
20	20,0	3,0	54,0	31,0	Rd44x1/6	0,110	-0201	8,15	-0202	8,50	-0203	11,10	-0204	11,45
25	21,0	3,0	63,0	36,0	Rd52x1/6	0,160	-0251	7,95	-0252	8,30	-0253	10,30	-0254	10,65
32	21,0	3,0	70,0	42,0	Rd58x1/6	0,190	-0321	9,15	-0322	9,55	-0323	11,50	-0324	11,90
40	21,0	3,0	78,0	49,0	Rd65x1/6	0,240	-0401	8,95	-0402	9,35	-0403	12,50	-0404	12,90
50	22,0	3,0	92,0	62,0	Rd78x1/6	0,320	-0501	10,65	-0502	10,90	-0503	14,00	-0504	14,25
65	25,0	4,0	112,0	80,0	Rd95x1/6	0,530	-0651	16,50	-0652	16,85	-0653	21,75	-0654	22,10
75	25,0	4,0	119,0	88,0	Rd104x1/6	0,500	-0751	27,55	-0752	28,15	-0753	36,55	-0754	37,15
80	29,0	4,0	127,0	94,0	Rd110x1/4	0,720	-0801	25,70	-0802	26,25	-0803	33,25	-0804	33,80
90	30,0	4,0	138,0	104,0	Rd120x1/4	0,920	-0901	49,95	-0902	50,95	-0903	68,85	-0904	69,85
100	31,0	5,0	148,0	115,0	Rd130x1/4	0,970	-1001	34,65	-1002	35,35	-1003	45,95	-1004	46,65
125	35,0	5,0	178,0	138,0	Rd160x1/4	1,380	-1251	61,30	-1252	62,65	-1253	89,10	-1254	90,45
150	40,0	6,0	210,0	164,0	Rd190x1/4	2,150	-1501	95,80	-1502	97,80	-1503	148,80	-1504	150,80
200	39,0	6,0	260,0	214,0	Rd240x1/4	2,830	-2001	544,85	-2002	555,75	-2003	720,75	-2004	731,65

Rd: Rundgewinde - auf Anfrage mit APZ 3.1/AD2000-W2

Rd: round thread - on inquiry with certificate 3.1/AD2000-W2

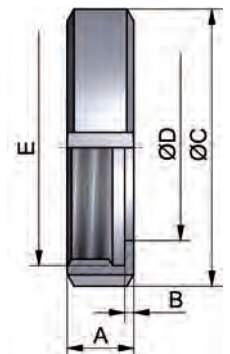
Nutmutter F DIN
nut DIN

Rohrverbindungen – Verschraubungen pipe connections – screwed pipe connections

Gewindestutzen DIN 11851-SKC	Art.-Nr. 11324-							AISI 304/304L-1.4301/1.4307				AISI 316L-1.4404			
	DN	A	B	C	D	E	Gew.	Art.-Nr.	Preis	Art.-Nr.	Preis	Art.-Nr.	Preis	Art.-Nr.	Preis
	mm	mm	mm	mm	mm	mm	kg	blank	EUR	matt	EUR	blank	EUR	matt	EUR
welding male part DIN 11851-SKC	10	17,0	10,0	13,0		Rd28x1/8	0,030	-0101	6,65	-0102	6,95	-0103	8,45	-0104	8,75
	15	17,0	16,0	19,0		Rd34x1/8	0,050	-0151	7,40	-0152	7,75	-0153	9,75	-0154	10,05
	20	19,0	20,0	23,0		Rd44x1/6	0,090	-0201	9,00	-0202	9,40	-0203	11,60	-0204	12,00
	25	22,0	26,0	29,0		Rd52x1/6	0,110	-0251	7,60	-0252	7,95	-0253	9,85	-0254	10,30
	32	22,0	32,0	35,0		Rd58x1/6	0,130	-0321	8,95	-0322	9,35	-0323	10,70	-0324	11,10
	40	22,0	38,0	41,0		Rd65x1/6	0,150	-0401	9,80	-0402	10,25	-0403	11,45	-0404	11,85
	50	23,0	50,0	53,0		Rd78x1/6	0,200	-0501	10,80	-0502	11,30	-0503	13,10	-0504	13,35

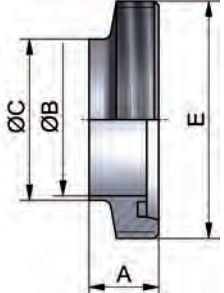

DN65-150 siehe Art.-Nr. 11304 - Rd: Rundgewinde
auf Anfrage mit APZ 3.1/AD2000-W2
Dichtungen siehe Seite 11

DN65-150 see item-no. 11304 - Rd: round thread
on inquiry with certificate 3.1/AD2000-W2
gaskets see page 11

Kegelstutzen DIN 11851-SKD	Art.-Nr. 11424-							AISI 304/304L-1.4301/1.4307				AISI 316L-1.4404			
	DN	A	B	C	D	E	Gew.	Art.-Nr.	Preis	Art.-Nr.	Preis	Art.-Nr.	Preis	Art.-Nr.	Preis
	mm	mm	mm	mm	mm	mm	kg	blank	EUR	matt	EUR	blank	EUR	matt	EUR
welding liner DIN 11851-SKD	10	13,0	10,0	13,0			22,5 0,010	-0101	3,80	-0102	4,00	-0103	4,20	-0104	4,40
	15	13,0	16,0	19,0			28,5 0,020	-0151	4,15	-0152	4,35	-0153	5,50	-0154	5,70
	20	13,0	20,0	23,0			36,5 0,040	-0201	4,85	-0202	5,05	-0203	6,25	-0204	6,45
	25	15,0	26,0	29,0			44,0 0,070	-0251	6,20	-0252	6,45	-0253	7,40	-0254	7,65
	32	15,0	32,0	35,0			50,0 0,090	-0321	6,60	-0322	6,90	-0323	8,30	-0324	8,60
	40	15,0	38,0	41,0			56,0 0,090	-0401	6,70	-0402	7,00	-0403	8,35	-0404	8,65
	50	16,0	50,0	53,0			68,5 0,150	-0501	7,90	-0502	8,10	-0503	9,55	-0504	9,75

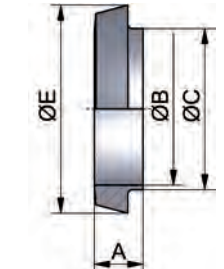

DN65-150 siehe Art.-Nr. 11404
auf Anfrage mit APZ 3.1/AD2000-W2

DN65-150 see item-no. 11404
on inquiry with certificate 3.1/AD2000-W2

Nutmutter F DIN nut DIN	Art.-Nr. 11000-							AISI 304/304L-1.4301/1.4307				AISI 316L-1.4404			
	DN	A	B	C	D	E	Gew.	Art.-Nr.	Preis	Art.-Nr.	Preis	Art.-Nr.	Preis	Art.-Nr.	Preis
	mm	mm	mm	mm	mm	mm	kg	blank	EUR	matt	EUR	blank	EUR	matt	EUR
	10	18,0	3,0	38,0	19,0	Rd28x1/8	0,060	-0101	6,50	-0102	6,00	-0103	8,80	-0104	9,10
	15	18,0	3,0	44,0	25,0	Rd34x1/8	0,080	-0151	8,45	-0152	8,80	-0153	10,90	-0154	11,25
	20	20,0	3,0	54,0	31,0	Rd44x1/6	0,110	-0201	8,15	-0202	8,50	-0203	11,10	-0204	11,45
	25	21,0	3,0	63,0	36,0	Rd52x1/6	0,160	-0251	7,95	-0252	8,30	-0253	10,30	-0254	10,65
	32	21,0	3,0	70,0	42,0	Rd58x1/6	0,190	-0321	9,15	-0322	9,55	-0323	11,50	-0324	11,90
	40	21,0	3,0	78,0	49,0	Rd65x1/6	0,240	-0401	8,95	-0402	9,35	-0403	12,50	-0404	12,90
	50	22,0	3,0	92,0	62,0	Rd78x1/6	0,320	-0501	10,65	-0502	10,90	-0503	14,00	-0504	14,25
	65	25,0	4,0	112,0	80,0	Rd95x1/6	0,530	-0651	16,50	-0652	16,85	-0653	21,75	-0654	22,10
	75	25,0	4,0	119,0	88,0	Rd104x1/6	0,500	-0751	27,55	-0752	28,15	-0753	36,55	-0754	37,15
	80	29,0	4,0	127,0	94,0	Rd110x1/4	0,720	-0801	25,70	-0802	26,25	-0803	33,25	-0804	33,80
	90	30,0	4,0	138,0	104,0	Rd120x1/4	0,920	-0901	49,95	-0902	50,95	-0903	68,85	-0904	69,85
	100	31,0	5,0	148,0	115,0	Rd130x1/4	0,970	-1001	34,65	-1002	35,35	-1003	45,95	-1004	46,65
	125	35,0	5,0	178,0	138,0	Rd160x1/4	1,380	-1251	61,30	-1252	62,65	-1253	89,10	-1254	90,45
	150	40,0	6,0	210,0	164,0	Rd190x1/4	2,150	-1501	95,80	-1502	97,80	-1503	148,80	-1504	150,80
	200	39,0	6,0	260,0	214,0	Rd240x1/4	2,830	-2001	544,85	-2002	555,75	-2003	720,75	-2004	731,65

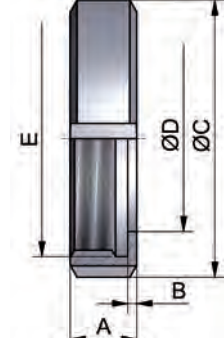

Rd: Rundgewinde - auf Anfrage mit APZ 3.1/AD2000-W2

Rd: round thread - on inquiry with certificate 3.1/AD2000-W2

Rohrverbindungen – Verschraubungen
pipe connections – screwed pipe connections

Art.-Nr. 11300-							AISI 304/304L-1.4301/1.4307				AISI 316L-1.4404			
DN	A	B	C	D	E	Gew.	Art.-Nr.	Preis	Art.-Nr.	Preis	Art.-Nr.	Preis	Art.-Nr.	Preis
mm	mm	mm	mm	mm	mm	kg	blank	EUR	matt	EUR	blank	EUR	matt	EUR
10	21,0	10,0	15,0		Rd28x1/8	0,030	-0101	6,20	-0102	6,50	-0103	7,90	-0104	8,20
15	21,0	16,0	21,0		Rd34x1/8	0,040	-0151	6,95	-0152	7,25	-0153	8,95	-0154	9,25
20	24,0	20,0	25,0		Rd44x1/6	0,080	-0201	8,25	-0202	8,60	-0203	10,70	-0204	11,05
25	29,0	26,0	31,0		Rd52x1/6	0,120	-0251	7,55	-0252	7,90	-0253	9,75	-0254	10,10
32	32,0	32,0	37,0		Rd58x1/6	0,140	-0321	9,00	-0322	9,40	-0323	11,85	-0324	12,25
40	33,0	38,0	43,0		Rd65x1/6	0,150	-0401	9,30	-0402	9,70	-0403	12,10	-0404	12,50
50	35,0	50,0	55,0		Rd78x1/6	0,240	-0501	10,65	-0502	10,90	-0503	13,85	-0504	14,10
65	40,0	66,0	72,0		Rd95x1/6	0,370	-0651	16,10	-0652	16,45	-0653	21,25	-0654	21,60
80	45,0	81,0	87,0		Rd110x1/4	0,540	-0801	24,85	-0802	25,35	-0803	32,10	-0804	32,60
90	45,0	89,0	95,0		Rd120x1/4	0,650	-0901	53,70	-0902	54,80	-0903	63,65	-0904	64,75
100	54,0	100,0	106,0		Rd130x1/4	0,700	-1001	36,40	-1002	37,15	-1003	47,90	-1004	48,65
125	46,0	125,0	132,0		Rd160x1/4	1,130	-1251	65,90	-1252	67,25	-1253	97,80	-1254	99,15
150	50,0	150,0	157,0		Rd190x1/4	1,770	-1501	114,00	-1502	116,35	-1503	168,90	-1504	171,25
200	50,0	200,0	213,0		Rd240x1/4	2,490	-2001	581,15	-2002	592,80	-2003	775,25	-2004	786,90

 Rd: Rundgewinde - Dichtungen siehe Seite 11
 auf Anfrage mit APZ 3.1/AD2000-W2

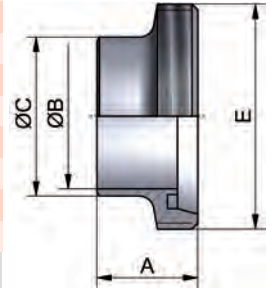
 Rd: round thread - gaskets see page 11
 on inquiry with certificate 3.1/AD2000-W2

Gewindestutzen SC
 welding male part

Art.-Nr. 11400-							AISI 304/304L-1.4301/1.4307				AISI 316L-1.4404			
DN	A	B	C	D	E	Gew.	Art.-Nr.	Preis	Art.-Nr.	Preis	Art.-Nr.	Preis	Art.-Nr.	Preis
mm	mm	mm	mm	mm	mm	kg	blank	EUR	matt	EUR	blank	EUR	matt	EUR
10	17,0	10,0	15,0		22,5	0,010	-0101	3,90	-0102	4,10	-0103	4,30	-0104	4,50
15	17,0	16,0	21,0		28,5	0,010	-0151	4,30	-0152	4,50	-0153	5,15	-0154	5,35
20	18,0	20,0	25,0		36,5	0,040	-0201	4,70	-0202	4,90	-0203	6,05	-0204	6,25
25	22,0	26,0	31,0		44,0	0,070	-0251	4,95	-0252	6,05	-0253	6,50	-0254	7,60
32	25,0	32,0	37,0		50,0	0,120	-0321	6,40	-0322	6,70	-0323	8,20	-0324	8,50
40	26,0	38,0	43,0		56,0	0,130	-0401	6,40	-0402	6,70	-0403	8,25	-0404	8,55
50	28,0	50,0	55,0		68,5	0,150	-0501	7,60	-0502	7,80	-0503	9,35	-0504	9,55
65	32,0	66,0	72,0		86,0	0,310	-0651	10,90	-0652	11,15	-0653	14,75	-0654	15,00
80	37,0	81,0	87,0		100,0	0,380	-0801	17,40	-0802	17,80	-0803	22,50	-0804	22,90
90	35,0	89,0	95,0		111,0	0,450	-0901	38,60	-0902	39,40	-0903	48,85	-0904	49,65
100	44,0	100,0	106,0		121,0	0,600	-1001	26,70	-1002	27,25	-1003	35,05	-1004	35,60
125	34,0	125,0	132,0		150,0	0,760	-1251	51,90	-1252	53,00	-1253	79,90	-1254	81,00
150	37,0	150,0	157,0		176,0	1,030	-1501	98,80	-1502	101,05	-1503	149,50	-1504	151,75
200	39,0	200,0	213,0		226,0	1,450	-2001	454,05	-2002	463,15	-2003	628,85	-2004	637,95

auf Anfrage mit APZ 3.1/AD2000-W2

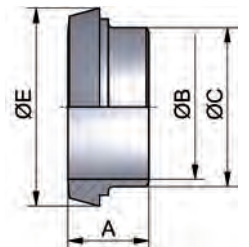
on inquiry with certificate 3.1/AD2000-W2

Kegelstutzen SD
 welding liner

Art.-Nr. 11000-							AISI 304/304L-1.4301/1.4307				AISI 316L-1.4404			
DN	A	B	C	D	E	Gew.	Art.-Nr.	Preis	Art.-Nr.	Preis	Art.-Nr.	Preis	Art.-Nr.	Preis
mm	mm	mm	mm	mm	mm	kg	blank	EUR	matt	EUR	blank	EUR	matt	EUR
10	18,0	3,0	38,0	19,0	Rd28x1/8	0,060	-0101	6,50	-0102	6,00	-0103	8,80	-0104	9,10
15	18,0	3,0	44,0	25,0	Rd34x1/8	0,080	-0151	8,45	-0152	8,80	-0153	10,90	-0154	11,25
20	20,0	3,0	54,0	31,0	Rd44x1/6	0,110	-0201	8,15	-0202	8,50	-0203	11,10	-0204	11,45
25	21,0	3,0	63,0	36,0	Rd52x1/6	0,160	-0251	7,95	-0252	8,30	-0253	10,30	-0254	10,65
32	21,0	3,0	70,0	42,0	Rd58x1/6	0,190	-0321	9,15	-0322	9,55	-0323	11,50	-0324	11,90
40	21,0	3,0	78,0	49,0	Rd65x1/6	0,240	-0401	8,95	-0402	9,35	-0403	12,50	-0404	12,90
50	22,0	3,0	92,0	62,0	Rd78x1/6	0,320	-0501	10,65	-0502	10,90	-0503	14,00	-0504	14,25
65	25,0	4,0	112,0	80,0	Rd95x1/6	0,530	-0651	16,50	-0652	16,85	-0653	21,75	-0654	22,10
75	25,0	4,0	119,0	88,0	Rd104x1/6	0,500	-0751	27,55	-0752	28,15	-0753	36,55	-0754	37,15
80	29,0	4,0	127,0	94,0	Rd110x1/4	0,720	-0801	25,70	-0802	26,25	-0803	33,25	-0804	33,80
90	30,0	4,0	138,0	104,0	Rd120x1/4	0,920	-0901	49,95	-0902	50,95	-0903	68,85	-0904	69,85
100	31,0	5,0	148,0	115,0	Rd130x1/4	0,970	-1001	34,65	-1002	35,35	-1003	45,95	-1004	46,65
125	35,0	5,0	178,0	138,0	Rd160x1/4	1,380	-1251	61,30	-1252	62,65	-1253	89,10	-1254	90,45
150	40,0	6,0	210,0	164,0	Rd190x1/4	2,150	-1501	95,80	-1502	97,80	-1503	148,80	-1504	150,80
200	39,0	6,0	260,0	214,0	Rd240x1/4	2,830	-2001	544,85	-2002	555,75	-2003	720,75	-2004	731,65

Rd: Rundgewinde - auf Anfrage mit APZ 3.1/AD2000-W2

Rd: round thread - on inquiry with certificate 3.1/AD2000-W2

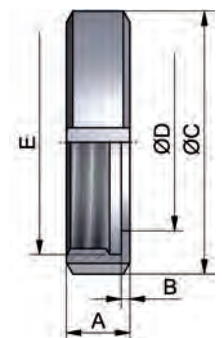
Nutmutter F DIN
 nut DIN

Rohrverbindungen – Verschraubungen pipe connections – screwed pipe connections

Gewindestutzen SKC

Art.-Nr. 11304-

AISI 304/304L-1.4301/1.4307

AISI 316L-1.4404

welding male part short

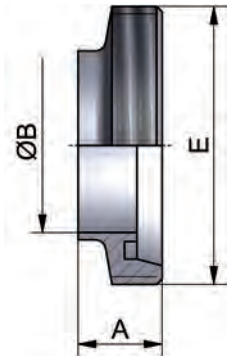

DN	A mm	B mm	C mm	D mm	E mm	Gew. kg	AISI 304/304L-1.4301/1.4307		AISI 316L-1.4404					
							Art.-Nr. blank	Preis EUR	Art.-Nr. matt	Preis EUR	Art.-Nr. blank	Preis EUR	Art.-Nr. matt	Preis EUR
10	17,5	9,0			Rd28x1/8	0,030	-0101	6,65	-0102	6,95	-0103	8,45	-0104	8,75
15	17,5	15,0			Rd34x1/8	0,050	-0151	7,40	-0152	7,70	-0153	9,75	-0154	10,05
20	19,5	19,0			Rd44x1/6	0,090	-0201	9,00	-0202	9,40	-0203	11,60	-0204	12,00
25	22,5	25,0			Rd52x1/6	0,110	-0251	7,60	-0252	7,95	-0253	9,85	-0254	10,20
32	22,5	31,0			Rd58x1/6	0,130	-0321	8,95	-0322	9,35	-0323	10,70	-0324	11,10
40	22,5	37,0			Rd65x1/6	0,150	-0401	9,80	-0402	10,20	-0403	11,45	-0404	11,85
50	23,5	49,0			Rd78x1/6	0,200	-0501	10,80	-0502	11,05	-0503	13,10	-0504	13,35
65	25,5	66,0			Rd95x1/6	0,280	-0651	13,70	-0652	14,00	-0653	18,00	-0654	18,30
80	25,5	81,0			Rd110x1/4	0,420	-0801	22,65	-0802	23,15	-0803	29,35	-0804	29,85
100	30,5	100,0			Rd130x1/4	0,530	-1001	32,15	-1002	32,80	-1003	42,65	-1004	43,30
125	35,5	125,0			Rd160x1/4	0,980	-1251	58,20	-1252	60,85	-1253	87,50	-1254	91,45
150	40,0	150,0			Rd190x1/4	1,610	-1501	101,50	-1502	91,45	-1503	150,60	-1504	157,40

Rd: Rundgewinde - auf Anfrage mit APZ 3.1/AD2000-W2
Dichtungen siehe Seite 11

Rd: round thread - on inquiry with certificate 3.1/AD2000-W2
gaskets see page 11

Kegelstutzen SKD

Art.-Nr. 11404-

AISI 304/304L-1.4301/1.4307

AISI 316L-1.4404

welding liner short

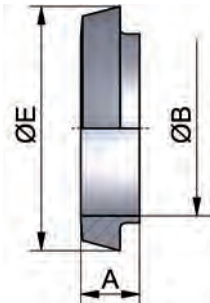

DN	A mm	B mm	C mm	D mm	E mm	Gew. kg	AISI 304/304L-1.4301/1.4307		AISI 316L-1.4404					
							Art.-Nr. blank	Preis EUR	Art.-Nr. matt	Preis EUR	Art.-Nr. blank	Preis EUR	Art.-Nr. matt	Preis EUR
10	13,5	9,0			22,5	0,010	-0101	3,90	-0102	4,10	-0103	4,20	-0104	4,40
15	13,5	15,0			28,5	0,020	-0151	4,15	-0152	4,35	-0153	5,50	-0154	5,70
20	13,5	19,0			36,5	0,040	-0201	4,85	-0202	5,05	-0203	6,25	-0204	6,45
25	15,5	25,0			44,0	0,070	-0251	6,20	-0252	6,45	-0253	7,40	-0254	7,65
32	15,5	31,0			50,0	0,090	-0321	6,60	-0322	6,90	-0323	8,30	-0324	8,60
40	15,5	37,0			56,0	0,090	-0401	6,70	-0402	7,00	-0403	8,35	-0404	8,65
50	16,5	49,0			68,5	0,150	-0501	7,90	-0502	8,10	-0503	9,55	-0504	9,75
65	17,5	66,0			86,0	0,210	-0651	10,20	-0652	10,45	-0653	14,15	-0654	14,40
80	17,5	81,0			100,0	0,240	-0801	16,05	-0802	16,40	-0803	20,65	-0804	21,00
100	20,5	100,0			121,0	0,380	-1001	25,85	-1002	26,40	-1003	34,25	-1004	34,80
125	23,5	125,0			150,0	0,970	-1251	42,60	-1252	44,60	-1253	70,30	-1254	73,50
150	27,0	150,0			176,0	0,870	-1501	81,00	-1502	84,70	-1503	131,60	-1504	137,60

auf Anfrage mit APZ 3.1/AD2000-W2

on inquiry with certificate 3.1/AD2000-W2

Nutmutter F DIN

Art.-Nr. 11000-

AISI 304/304L-1.4301/1.4307

AISI 316L-1.4404

nut DIN

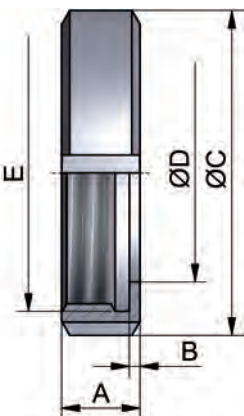

DN	A mm	B mm	C mm	D mm	E mm	Gew. kg	AISI 304/304L-1.4301/1.4307		AISI 316L-1.4404					
							Art.-Nr. blank	Preis EUR	Art.-Nr. matt	Preis EUR	Art.-Nr. blank	Preis EUR	Art.-Nr. matt	Preis EUR
10	18,0	3,0	38,0	19,0	Rd28x1/8	0,060	-0101	6,50	-0102	6,00	-0103	8,80	-0104	9,10
15	18,0	3,0	44,0	25,0	Rd34x1/8	0,080	-0151	8,45	-0152	8,80	-0153	10,90	-0154	11,25
20	20,0	3,0	54,0	31,0	Rd44x1/6	0,110	-0201	8,15	-0202	8,50	-0203	11,10	-0204	11,45
25	21,0	3,0	63,0	36,0	Rd52x1/6	0,160	-0251	7,95	-0252	8,30	-0253	10,30	-0254	10,65
32	21,0	3,0	70,0	42,0	Rd58x1/6	0,190	-0321	9,15	-0322	9,55	-0323	11,50	-0324	11,90
40	21,0	3,0	78,0	49,0	Rd65x1/6	0,240	-0401	8,95	-0402	9,35	-0403	12,50	-0404	12,90
50	22,0	3,0	92,0	62,0	Rd78x1/6	0,320	-0501	10,65	-0502	10,90	-0503	14,00	-0504	14,25
65	25,0	4,0	112,0	80,0	Rd95x1/6	0,530	-0651	16,50	-0652	16,85	-0653	21,75	-0654	22,10
75	25,0	4,0	119,0	88,0	Rd104x1/6	0,500	-0751	27,55	-0752	28,15	-0753	36,55	-0754	37,15
80	29,0	4,0	127,0	94,0	Rd110x1/4	0,720	-0801	25,70	-0802	26,25	-0803	33,25	-0804	33,80
90	30,0	4,0	138,0	104,0	Rd120x1/4	0,920	-0901	49,95	-0902	50,95	-0903	68,85	-0904	69,85
100	31,0	5,0	148,0	115,0	Rd130x1/4	0,970	-1001	34,65	-1002	35,35	-1003	45,95	-1004	46,65
125	35,0	5,0	178,0	138,0	Rd160x1/4	1,380	-1251	61,30	-1252	62,65	-1253	89,10	-1254	90,45
150	40,0	6,0	210,0	164,0	Rd190x1/4	2,150	-1501	95,80	-1502	97,80	-1503	148,80	-1504	150,80
200	39,0	6,0	260,0	214,0	Rd240x1/4	2,830	-2001	544,85	-2002	555,75	-2003	720,75	-2004	731,65

Rd: Rundgewinde - auf Anfrage mit APZ 3.1/AD2000-W2

Rd: round thread - on inquiry with certificate 3.1/AD2000-W2

Rohrverbindungen – Verschraubungen
pipe connections – screwed pipe connections

Art.-Nr. 11301-							AISI 304/304L-1.4301/1.4307				AISI 316L-1.4404			
DN	A	B	C	D	E	Gew.	Art.-Nr.	Preis	Art.-Nr.	Preis	Art.-Nr.	Preis	Art.-Nr.	Preis
mm	mm	mm	mm	mm	mm	kg	blank	EUR	matt	EUR	blank	EUR	matt	EUR
1"	29,0	22,9	25,4		Rd52x1/6	0,100	-1001	7,90	-1002	8,30	-1003	10,15	-1004	10,55
1,5"	33,0	35,1	38,1		Rd65x1/6	0,160	-1121	9,70	-1122	10,15	-1123	12,60	-1124	13,05
2"	35,0	47,8	50,8		Rd78x1/6	0,220	-2001	11,10	-2002	11,35	-2003	14,45	-2004	14,70
2,5"	40,0	60,2	63,5		Rd95x1/6	0,360	-2121	16,75	-2122	17,15	-2123	22,10	-2124	22,50
3"	40,0	72,8	76,1		Rd104x1/6	0,420	-3001	25,85	-3002	26,40	-3003	33,40	-3004	33,95
4"	54,0	97,4	101,6		Rd130x1/4	0,640	-4001	37,90	-4002	38,75	-4003	49,85	-4004	50,70

Rd: Rundgewinde - für Zoll-Rohre
 auf Anfrage mit APZ 3.1/AD2000-W2
 Dichtungen siehe Seite 11

Rd: round thread - for inch-pipes
 on inquiry with certificate 3.1/AD2000-W2
 gaskets see page 11

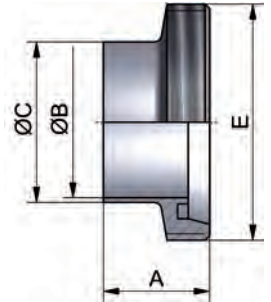

Gewindestutzen Zoll
welding male part inch

Art.-Nr. 11401-							AISI 304/304L-1.4301/1.4307				AISI 316L-1.4404			
DN	A	B	C	D	E	Gew.	Art.-Nr.	Preis	Art.-Nr.	Preis	Art.-Nr.	Preis	Art.-Nr.	Preis
mm	mm	mm	mm	mm	mm	kg	blank	EUR	matt	EUR	blank	EUR	matt	EUR
1"	22,0	22,9	25,4		44,0	0,080	-1001	5,15	-1002	5,45	-1003	6,80	-1004	7,10
1,5"	26,0	35,1	38,1		56,0	0,130	-1121	6,70	-1122	7,05	-1123	8,60	-1124	8,95
2"	28,0	47,8	50,8		68,5	0,180	-2001	7,95	-2002	8,15	-2003	9,75	-2004	9,95
2,5"	32,0	60,2	63,5		86,0	0,330	-2121	11,35	-2122	11,65	-2123	15,35	-2124	15,65
3"	32,0	72,8	76,1		93,0	0,310	-3001	18,10	-3002	18,55	-3003	23,40	-3004	23,85
4"	44,0	97,4	101,6		121,0	0,670	-4001	27,80	-4002	28,40	-4003	36,50	-4004	37,10

für Zoll-Rohre - auf Anfrage mit APZ 3.1/AD2000-W2

for inch-pipes - on inquiry with certificate 3.1/AD2000-W2

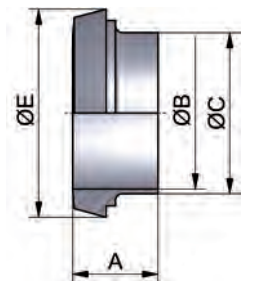

Kegelstutzen Zoll
welding liner inch

Art.-Nr. 11000-							AISI 304/304L-1.4301/1.4307				AISI 316L-1.4404			
DN	A	B	C	D	E	Gew.	Art.-Nr.	Preis	Art.-Nr.	Preis	Art.-Nr.	Preis	Art.-Nr.	Preis
mm	mm	mm	mm	mm	mm	kg	blank	EUR	matt	EUR	blank	EUR	matt	EUR
1"	21,0	3,0	63,0	36,0	Rd52x1/6	0,160	-0251	7,95	-0252	8,30	-0253	10,30	-0254	10,65
1,5"	21,0	3,0	78,0	49,0	Rd65x1/6	0,240	-0401	8,95	-0402	9,35	-0403	12,50	-0404	12,90
2"	22,0	3,0	92,0	62,0	Rd78x1/6	0,320	-0501	10,65	-0502	10,90	-0503	14,00	-0504	14,25
2,5"	25,0	4,0	112,0	80,0	Rd95x1/6	0,530	-0651	16,50	-0652	16,85	-0653	21,75	-0654	22,10
3"	25,0	4,0	119,0	88,0	Rd104x1/6	0,500	-0751	27,55	-0752	28,15	-0753	36,55	-0754	37,15
4"	31,0	5,0	148,0	115,0	Rd130x1/4	0,970	-1001	34,65	-1002	35,35	-1003	45,95	-1004	46,65

Rd: Rundgewinde - auf Anfrage mit APZ 3.1/AD2000-W2

Rd: round thread - on inquiry with certificate 3.1/AD2000-W2

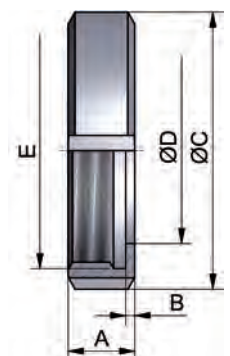

Nutmutter F Zoll
nut inch

Rohrverbindungen – Verschraubungen pipe connections – screwed pipe connections

Gewindestutzen ISO

Art.-Nr. 11308-

AISI 304/304L-1.4301/1.4307

AISI 316L-1.4404

welding male part
ISO

DN	A	B	C	D	E	Gew.	Art.-Nr.	Preis	Art.-Nr.	Preis	Art.-Nr.	Preis	Art.-Nr.	Preis
mm	mm	mm	mm	mm	mm	kg	blank	EUR	matt	EUR	blank	EUR	matt	EUR
17,2	21,0	14,2	17,2		Rd28x1/8	0,030	-0101	10,25	-0102	10,70	-0103	16,10	-0104	16,55
21,3	21,0	18,1	21,3		Rd34x1/8	0,040	-0151	10,50	-0152	10,95	-0153	16,25	-0154	16,70
26,9	24,0	23,7	26,9		Rd44x1/6	0,080	-0201	10,65	-0202	11,10	-0203	16,40	-0204	16,85
33,7	29,0	29,7	33,7		Rd52x1/6	0,110	-0251	10,75	-0252	11,20	-0253	16,10	-0254	16,55
42,4	32,0	38,4	42,4		Rd58x1/6	0,140	-0321	11,25	-0322	11,70	-0323	16,75	-0324	17,20
48,3	33,0	44,3	48,3		Rd65x1/6	0,190	-0401	12,00	-0402	12,50	-0403	17,40	-0404	17,90
60,3	35,0	56,3	60,3		Rd78x1/6	0,250	-0501	13,80	-0502	14,10	-0503	19,70	-0504	20,00
76,1	40,0	71,5	76,1		Rd95x1/6	0,370	-0651	20,45	-0652	20,90	-0653	27,60	-0654	28,05
88,9	45,0	84,3	88,9		Rd110x1/4	0,560	-0801	31,30	-0802	31,95	-0803	43,70	-0804	44,35
114,3	54,0	109,1	114,3		Rd130x1/4	0,810	-1001	43,45	-1002	44,35	-1003	59,80	-1004	60,70
139,7	46,0	134,5	139,7		Rd160x1/4	1,130	-1251	90,60	-1252	92,45	-1253	122,10	-1254	123,95
168,3	50,0	163,1	168,3		Rd190x1/4	1,770	-1501	139,35	-1502	142,15	-1503	202,40	-1504	205,20

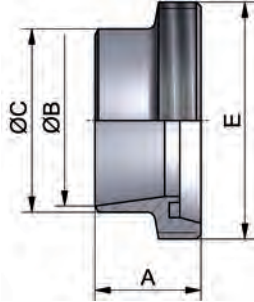

Rd: Rundgewinde - für Rohre gem. DIN EN ISO 1127
auf Anfrage mit APZ 3.1/AD2000-W2
Dichtungen siehe Seite 11

Rd: round thread - for pipes as per DIN EN ISO 1127
on inquiry with certificate 3.1/AD2000-W2
gaskets see page 11

Kegelstutzen ISO

Art.-Nr. 11408-

AISI 304/304L-1.4301/1.4307

AISI 316L-1.4404

welding liner ISO

DN	A	B	C	D	E	Gew.	Art.-Nr.	Preis	Art.-Nr.	Preis	Art.-Nr.	Preis	Art.-Nr.	Preis
mm	mm	mm	mm	mm	mm	kg	blank	EUR	matt	EUR	blank	EUR	matt	EUR
17,2	17,0	14,2	17,2		22,5	0,010	-0101	5,90	-0102	6,15	-0103	9,60	-0104	9,85
21,3	17,0	18,1	21,3		28,5	0,020	-0151	6,10	-0152	6,35	-0153	9,70	-0154	9,95
26,9	18,0	23,7	26,9		36,5	0,040	-0201	6,30	-0202	6,60	-0203	9,85	-0204	10,15
33,7	22,0	29,7	33,7		44,0	0,070	-0251	8,90	-0252	9,30	-0253	12,90	-0254	13,30
42,4	25,0	38,4	42,4		50,0	0,110	-0321	9,45	-0322	9,85	-0323	13,70	-0324	14,10
48,3	26,0	44,3	48,3		56,0	0,130	-0401	9,70	-0402	9,90	-0403	13,90	-0404	14,10
60,3	28,0	56,3	60,3		68,5	0,190	-0501	10,65	-0502	10,90	-0503	15,30	-0504	15,55
76,1	32,0	71,5	76,1		86,0	0,290	-0651	14,30	-0652	14,60	-0653	20,45	-0654	20,75
88,9	37,0	84,3	88,9		100,0	0,360	-0801	22,50	-0802	22,95	-0803	31,45	-0804	31,90
114,3	44,0	109,1	114,3		121,0	0,670	-1001	35,55	-1002	36,30	-1003	46,20	-1004	46,95
139,7	34,0	134,5	139,7		150,0	0,760	-1251	77,65	-1252	79,25	-1253	143,55	-1254	145,15
168,3	37,0	163,1	168,3		176,0	1,030	-1501	135,15	-1502	137,90	-1503	195,75	-1504	198,50

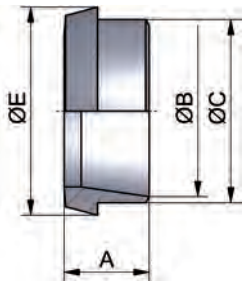

für Rohre gem. DIN EN ISO 1127
auf Anfrage mit APZ 3.1/AD2000-W2

for pipes as per DIN EN ISO 1127
on inquiry with certificate 3.1/AD2000-W2

Nutmutter F ISO

Art.-Nr. 1100-

AISI 304/304L-1.4301/1.4307

AISI 316L-1.4404

nut inch ISO

DN	A	B	C	D	E	Gew.	Art.-Nr.	Preis	Art.-Nr.	Preis	Art.-Nr.	Preis	Art.-Nr.	Preis
mm	mm	mm	mm	mm	mm	kg	blank	EUR	matt	EUR	blank	EUR	matt	EUR
17,2	18,0	3,0	38,0	19,0	Rd28x1/8	0,060	-00101	6,50	-00102	6,00	-00103	8,80	-00104	9,10
21,3	18,0	3,0	44,0	25,0	Rd34x1/8	0,080	-00151	8,45	-00152	8,80	-00153	10,90	-00154	11,25
26,9	20,0	3,0	54,0	31,0	Rd44x1/6	0,110	-00201	8,15	-00202	8,50	-00203	11,10	-00204	11,45
33,7	21,0	3,0	63,0	36,0	Rd52x1/6	0,160	-00251	7,95	-00252	8,30	-00253	10,30	-00254	10,65
42,4	21,0	3,0	70,0	43,0	Rd58x1/6	0,190	-80321	14,40	-80322	14,40	-80323	24,70	-80324	24,70
48,3	21,0	3,0	78,0	49,0	Rd65x1/6	0,240	-00401	8,95	-00402	9,35	-00403	12,50	-00404	12,90
60,3	22,0	3,0	92,0	62,0	Rd78x1/6	0,320	-00501	10,65	-00502	10,90	-00503	14,00	-00504	14,25
76,1	25,0	4,0	112,0	80,0	Rd95x1/6	0,530	-00651	16,50	-00652	16,85	-00653	21,75	-00654	22,10
88,9	29,0	4,0	127,0	94,0	Rd110x1/4	0,720	-00801	25,70	-00802	26,25	-00803	33,25	-00804	33,80
114,3	31,0	5,0	148,0	115,0	Rd130x1/4	0,970	-01001	34,65	-01002	35,35	-01003	45,95	-01004	46,65
139,7	35,0	5,0	178,0	141,0	Rd160x1/4	1,380	-81251	100,35	-81252	100,35	-81253	217,50	-81254	217,50
168,3	40,0	6,0	210,0	169,0	Rd190x1/4	2,150	-81501	171,15	-81502	171,15	-81503	307,05	-81504	307,05

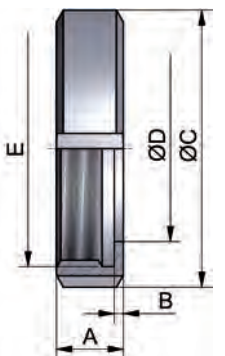

Rd: Rundgewinde - auf Anfrage mit APZ 3.1/AD2000-W2

Rd: round thread - on inquiry with certificate 3.1/AD2000-W2

Rohrverbindungen – Verschraubungen
pipe connections – screwed pipe connections
Art.-Nr. 10500-

							AISI 304/304L-1.4301/1.4307				AISI 316L-1.4404			
DN	A	B	C	D	E	Gew.	Art.-Nr.	Preis	Art.-Nr.	Preis	Art.-Nr.	Preis	Art.-Nr.	Preis
mm	mm	mm	mm	mm	mm	kg	blank	EUR	matt	EUR	blank	EUR	matt	EUR
10	21,0	12,0	4,0	12,2	Rd28x1/8	0,030	-0101	7,45	-0102	7,75	-0103	9,05	-0104	9,35
15	21,0	12,0	4,0	18,2	Rd34x1/8	0,050	-0151	7,65	-0152	7,95	-0153	10,00	-0154	10,30
20	24,0	12,0	6,0	22,2	Rd44x1/6	0,100	-0201	9,00	-0202	9,35	-0203	11,70	-0204	12,05
25	29,0	15,0	7,0	28,2	Rd52x1/6	0,120	-0251	8,10	-0252	8,45	-0253	10,70	-0254	11,05
32	32,0	18,0	7,0	34,2	Rd58x1/6	0,150	-0321	9,45	-0322	9,85	-0323	12,15	-0324	12,55
40	33,0	20,0	7,0	40,2	Rd65x1/6	0,200	-0401	9,65	-0402	10,05	-0403	12,55	-0404	12,95
50	35,0	22,0	7,0	52,2	Rd78x1/6	0,290	-0501	11,10	-0502	11,35	-0503	14,60	-0504	14,85
65	40,0	25,0	8,0	70,4	Rd95x1/6	0,440	-0651	17,35	-0652	17,70	-0653	23,05	-0654	23,40
80	45,0	28,0	8,0	85,4	Rd110x1/4	0,580	-0801	26,90	-0802	27,45	-0803	34,80	-0804	35,35
100	54,0	35,0	10,0	104,4	Rd130x1/4	0,870	-1001	39,75	-1002	40,55	-1003	52,75	-1004	53,55

Gewindestutzen C (Walz)

expanding male part

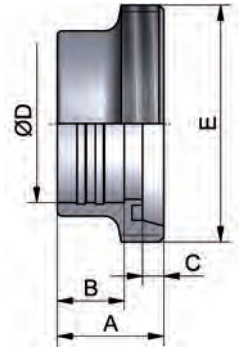

Rd: Rundgewinde

Dichtungen siehe Seite 11

 Rd: round thread
 gaskets see page 11

Art.-Nr. 10600-

							AISI 304/304L-1.4301/1.4307				AISI 316L-1.4404			
DN	A	B	C	D	E	Gew.	Art.-Nr.	Preis	Art.-Nr.	Preis	Art.-Nr.	Preis	Art.-Nr.	Preis
mm	mm	mm	mm	mm	mm	kg	blank	EUR	matt	EUR	blank	EUR	matt	EUR
10	17,0	12,0	6,0	12,2	22,5	0,020	-0101	3,60	-0102	3,75	-0103	4,45	-0104	4,60
15	17,0	12,0	6,0	18,2	28,5	0,030	-0151	4,40	-0152	4,60	-0153	5,90	-0154	6,10
20	18,0	12,0	8,0	22,2	36,5	0,050	-0201	5,10	-0202	5,30	-0203	6,60	-0204	6,80
25	22,0	15,0	10,0	28,2	44,0	0,090	-0251	5,90	-0252	6,15	-0253	7,15	-0254	7,40
32	25,0	18,0	10,0	34,2	50,0	0,110	-0321	6,60	-0322	6,90	-0323	8,40	-0324	8,70
40	26,0	20,0	10,0	40,2	56,0	0,140	-0401	6,85	-0402	7,15	-0403	8,65	-0404	8,95
50	28,0	22,0	11,0	52,2	68,5	0,220	-0501	8,05	-0502	8,25	-0503	10,40	-0504	10,60
65	32,0	25,0	12,0	70,4	86,0	0,310	-0651	12,30	-0652	12,55	-0653	16,15	-0654	16,40
80	37,0	28,0	12,0	85,4	100,0	0,400	-0801	19,35	-0802	19,75	-0803	25,10	-0804	25,50
100	44,0	35,0	15,0	104,4	121,0	0,680	-1001	29,90	-1002	30,50	-1003	39,40	-1004	40,00

Kegelstutzen D (Walz)

expanding liner

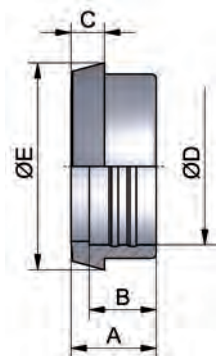
Art.-Nr. 11000-

							AISI 304/304L-1.4301/1.4307				AISI 316L-1.4404			
DN	A	B	C	D	E	Gew.	Art.-Nr.	Preis	Art.-Nr.	Preis	Art.-Nr.	Preis	Art.-Nr.	Preis
mm	mm	mm	mm	mm	mm	kg	blank	EUR	matt	EUR	blank	EUR	matt	EUR
10	18,0	3,0	38,0	19,0	Rd28x1/8	0,060	-0101	6,50	-0102	6,00	-0103	8,80	-0104	9,10
15	18,0	3,0	44,0	25,0	Rd34x1/8	0,080	-0151	8,45	-0152	8,80	-0153	10,90	-0154	11,25
20	20,0	3,0	54,0	31,0	Rd44x1/6	0,110	-0201	8,15	-0202	8,50	-0203	11,10	-0204	11,45
25	21,0	3,0	63,0	36,0	Rd52x1/6	0,160	-0251	7,95	-0252	8,30	-0253	10,30	-0254	10,65
32	21,0	3,0	70,0	42,0	Rd58x1/6	0,190	-0321	9,15	-0322	9,55	-0323	11,50	-0324	11,90
40	21,0	3,0	78,0	49,0	Rd65x1/6	0,240	-0401	8,95	-0402	9,35	-0403	12,50	-0404	12,90
50	22,0	3,0	92,0	62,0	Rd78x1/6	0,320	-0501	10,65	-0502	10,90	-0503	14,00	-0504	14,25
65	25,0	4,0	112,0	80,0	Rd95x1/6	0,530	-0651	16,50	-0652	16,85	-0653	21,75	-0654	22,10
75	25,0	4,0	119,0	88,0	Rd104x1/6	0,500	-0751	27,55	-0752	28,15	-0753	36,55	-0754	37,15
80	29,0	4,0	127,0	94,0	Rd110x1/4	0,720	-0801	25,70	-0802	26,25	-0803	33,25	-0804	33,80
90	30,0	4,0	138,0	104,0	Rd120x1/4	0,920	-0901	49,95	-0902	50,95	-0903	68,85	-0904	69,85
100	31,0	5,0	148,0	115,0	Rd130x1/4	0,970	-1001	34,65	-1002	35,35	-1003	45,95	-1004	46,65
125	35,0	5,0	178,0	138,0	Rd160x1/4	1,380	-1251	61,30	-1252	62,65	-1253	89,10	-1254	90,45
150	40,0	6,0	210,0	164,0	Rd190x1/4	2,150	-1501	95,80	-1502	97,80	-1503	148,80	-1504	150,80
200	39,0	6,0	260,0	214,0	Rd240x1/4	2,830	-2001	544,85	-2002	555,75	-2003	720,75	-2004	731,65

Nutmutter F DIN

nut DIN

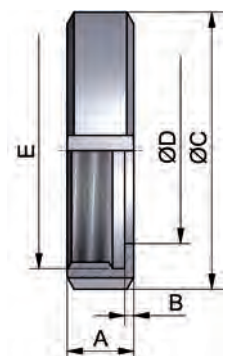

Rd: Rundgewinde - auf Anfrage mit APZ 3.1/AD2000-W2

Rd: round thread - on inquiry with certificate 3.1/AD2000-W2

Rohrverbindungen – Verschraubungen

pipe connections – screwed pipe connections

Gewindestutzen Zoll (Walz) expanding male part inch	Art.-Nr. 10501-							AISI 304/304L-1.4301/1.4307				AISI 316L-1.4404			
	DN	A	B	C	D	E	Gew.	Art.-Nr.	Preis	Art.-Nr.	Preis	Art.-Nr.	Preis	Art.-Nr.	Preis
	mm	mm	mm	mm	mm	mm	kg	blank	EUR	matt	EUR	blank	EUR	matt	EUR
1"	29,0	15,0	7,0	25,6	Rd52x1/6	0,150	-1001	8,40	-1002	8,75	-1003	10,95	-1004	11,30	
1,5"	33,0	20,0	7,0	38,3	Rd65x1/6	0,220	-1121	10,25	-1122	10,70	-1123	13,20	-1124	13,65	
2"	35,0	22,0	7,0	51,0	Rd78x1/6	0,310	-2001	11,70	-2002	11,95	-2003	15,00	-2004	15,25	
2,5"	40,0	25,0	8,0	63,8	Rd95x1/6	0,470	-2121	18,85	-2122	19,25	-2123	24,40	-2124	24,80	
3"	40,0	25,0	8,0	76,4	Rd104x1/6	0,540	-3001	28,30	-3002	28,85	-3003	37,00	-3004	37,55	
4"	54,0	35,0	10,0	101,9	Rd130x1/4	1,000	-4001	45,80	-4002	46,70	-4003	59,20	-4004	60,10	

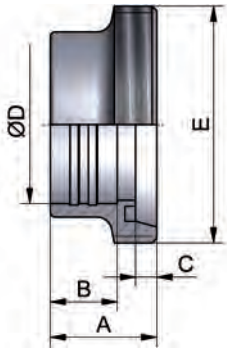

Rd: Rundgewinde
Dichtungen siehe Seite 11

Rd: round thread
gaskets see page 11

Kegelstutzen Zoll (Walz) expanding liner inch	Art.-Nr. 10601-							AISI 304/304L-1.4301/1.4307				AISI 316L-1.4404			
	DN	A	B	C	D	E	Gew.	Art.-Nr.	Preis	Art.-Nr.	Preis	Art.-Nr.	Preis	Art.-Nr.	Preis
	mm	mm	mm	mm	mm	mm	kg	blank	EUR	matt	EUR	blank	EUR	matt	EUR
1"	22,0	15,0	10,0	25,6	44,0	0,100	-1001	5,90	-1002	6,15	-1003	7,60	-1004	7,85	
1,5"	26,0	20,0	10,0	38,3	56,0	0,160	-1121	7,15	-1122	7,45	-1123	9,20	-1124	9,50	
2"	28,0	22,0	11,0	51,0	68,5	0,220	-2001	8,25	-2002	8,45	-2003	10,70	-2004	10,90	
2,5"	32,0	25,0	12,0	63,8	86,0	0,430	-2121	13,90	-2122	14,20	-2123	18,20	-2124	18,50	
3"	32,0	25,0	12,0	76,4	93,0	0,350	-3001	24,20	-3002	24,70	-3003	31,95	-3004	32,45	
4"	44,0	35,0	15,0	101,9	121,0	0,800	-4001	33,15	-4002	33,80	-4003	43,05	-4004	43,70	

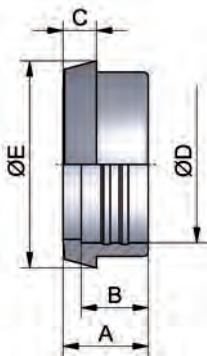

Nutmutter F Zoll nut inch	Art.-Nr. 11000-							AISI 304/304L-1.4301/1.4307				AISI 316L-1.4404			
	DN	A	B	C	D	E	Gew.	Art.-Nr.	Preis	Art.-Nr.	Preis	Art.-Nr.	Preis	Art.-Nr.	Preis
	mm	mm	mm	mm	mm	mm	kg	blank	EUR	matt	EUR	blank	EUR	matt	EUR
1"	21,0	3,0	63,0	36,0	Rd52x1/6	0,160	-0251	7,95	-0252	8,30	-0253	10,30	-0254	10,65	
1,5"	21,0	3,0	78,0	49,0	Rd65x1/6	0,240	-0401	8,95	-0402	9,35	-0403	12,50	-0404	12,90	
2"	22,0	3,0	92,0	62,0	Rd78x1/6	0,320	-0501	10,65	-0502	10,90	-0503	14,00	-0504	14,25	
2,5"	25,0	4,0	112,0	80,0	Rd95x1/6	0,530	-0651	16,50	-0652	16,85	-0653	21,75	-0654	22,10	
3"	25,0	4,0	119,0	88,0	Rd104x1/6	0,500	-0751	27,55	-0752	28,15	-0753	36,55	-0754	37,15	
4"	31,0	5,0	148,0	115,0	Rd130x1/4	0,970	-1001	34,65	-1002	35,35	-1003	45,95	-1004	46,65	

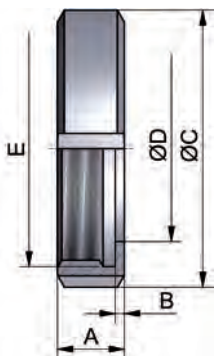

Rd: Rundgewinde - auf Anfrage mit APZ 3.1/AD2000-W2

Rd: round thread - on inquiry with certificate 3.1/AD2000-W2

Rohrverbindungen – Verschraubungen pipe connections – screwed pipe connections

Blindgewinde male part blank	Art.-Nr. 11700-							AISI 304/304L-1.4301/1.4307				AISI 316L-1.4404			
	DN	A	B	C	D	E	Gew.	Art.-Nr. blank	Preis EUR	Art.-Nr. matt	Preis EUR	Art.-Nr. blank	Preis EUR	Art.-Nr. matt	Preis EUR
	10	21,0		20,0	SW17	Rd28x1/8	0,050	-0101	20,20	-0102	21,05	-0103	24,30	-0104	25,15
	15	21,0		26,0	SW17	Rd34x1/8	0,090	-0151	21,20	-0152	22,05	-0153	25,45	-0154	26,30
	20	24,0		26,0	SW17	Rd44x1/6	0,130	-0201	22,25	-0202	23,15	-0203	29,65	-0204	30,55
	25/1"	24,0		34,0	SW27	Rd52x1/6	0,180	-0251	24,40	-0252	25,40	-0253	34,10	-0254	35,10
	32/1,25"	24,0		34,0	SW27	Rd58x1/6	0,210	-0321	26,20	-0322	27,25	-0323	36,60	-0324	37,65
	40/1,5"	24,0		34,0	SW27	Rd65x1/6	0,250	-0401	31,30	-0402	32,60	-0403	43,75	-0404	45,05
	50/2"	24,0		34,0	SW27	Rd78x1/6	0,330	-0501	31,85	-0502	32,50	-0503	44,60	-0504	45,25
	65/2,5"	28,0		34,0	SW32	Rd95x1/6	0,540	-0651	71,85	-0652	73,30	-0653	100,50	-0654	101,95
	80	30,0		34,0	SW32	Rd110x1/4	0,950	-0801	86,05	-0802	87,80	-0803	120,40	-0804	122,15
	100/4"	30,0		34,0	SW32	Rd130x1/4	1,110	-1001	113,30	-1002	115,60	-1003	158,60	-1004	160,90

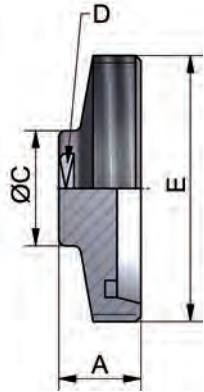

SW: Schlüsselweite - Rd: Rundgewinde

SW: width across flats - Rd: round thread

Blindkegel (massiv) liner blank	Art.-Nr. 11800-							AISI 304/304L-1.4301/1.4307				AISI 316L-1.4404			
	DN	A	B	C	D	E	Gew.	Art.-Nr. blank	Preis EUR	Art.-Nr. matt	Preis EUR	Art.-Nr. blank	Preis EUR	Art.-Nr. matt	Preis EUR
	10	9,0	6,0	18,0	22,5		0,020	-0101	7,55	-0102	7,90	-0103	9,25	-0104	9,60
	15	9,0	6,0	24,0	28,5		0,040	-0151	8,65	-0152	9,00	-0153	9,95	-0154	10,30
	20	11,0	8,0	30,0	36,5		0,070	-0201	9,60	-0202	10,00	-0203	11,75	-0204	12,15
	25/1"	13,0	10,0	35,0	44,0		0,120	-0251	9,75	-0252	10,15	-0253	12,00	-0254	12,40
	32/1,25"	13,0	10,0	41,0	50,0		0,160	-0321	10,65	-0322	11,10	-0323	13,35	-0324	13,80
	40/1,5"	13,0	10,0	48,0	56,0		0,220	-0401	11,70	-0402	12,20	-0403	14,85	-0404	15,35
	50/2"	14,0	11,0	61,0	68,5		0,360	-0501	13,30	-0502	13,60	-0503	17,30	-0504	17,60
	65/2,5"	16,0	12,0	79,0	86,0		0,660	-0651	19,55	-0652	19,95	-0653	25,60	-0654	26,00
	80	16,0	12,0	93,0	100,0		0,910	-0801	25,70	-0802	26,25	-0803	33,30	-0804	33,85
	100/4"	20,0	15,0	114,0	121,0		1,660	-1001	42,80	-1002	43,70	-1003	56,60	-1004	57,50
	125	22,0	17,0	137,0	150,0		2,840	-1251	76,40	-1252	77,95	-1253	101,85	-1254	103,40
	150	24,0	18,0	163,0	176,0		4,290	-1501	105,60	-1502	107,75	-1503	155,85	-1504	158,00

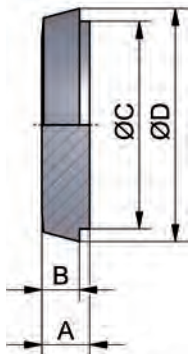

Blindkegel mit Rohrgewinde auf Anfrage

liner blank with pipe thread on inquiry

Blindkegel (Blech) liner blank (sheet metal)	Art.-Nr. 11802-							AISI 304-1.4301				AISI 316L-1.4404			
	DN	A	B	C	D	E	Gew.	Art.-Nr. poliert	Preis EUR	Art.-Nr. matt	Preis EUR	Art.-Nr. poliert	Preis EUR	Art.-Nr. matt	Preis EUR
	25	10,0	47,0				0,020	-0251	6,95	-0252	6,95	-0253	8,45	-0254	8,45
	32	10,0	53,0				0,020	-0321	7,25	-0322	7,25	-0323	8,75	-0324	8,75
	40	10,0	61,0				0,040	-0401	7,45	-0402	7,45	-0403	8,85	-0404	8,85
	50	11,0	73,0				0,050	-0501	7,75	-0502	7,75	-0503	9,75	-0504	9,75
	65	12,0	90,0				0,080	-0651	8,45	-0652	8,45	-0653	11,20	-0654	11,20
	80	12,0	103,0				0,120	-0801	11,70	-0802	11,70	-0803	15,05	-0804	15,05
	100	15,0	123,0				0,170	-1001	15,35	-1002	15,35	-1003	19,75	-1004	19,75



Rohrverbindungen – Verschraubungen
pipe connections – screwed pipe connections

Art.-Nr. 12000-							AISI 304/304L-1.4301/1.4307				AISI 316L-1.4404			
DN	A	B	C	D	E	Gew.	Art.-Nr.	Preis	Art.-Nr.	Preis	Art.-Nr.	Preis	Art.-Nr.	Preis
mm	mm	mm	mm	mm	mm	kg	poliert	EUR	matt	EUR	poliert	EUR	matt	EUR
10	18,5	3,5	38,0		Rd28x1/8	0,070	-0101	16,40	-0102	17,10	-0103	22,75	-0104	23,45
15	18,5	3,5	44,0		Rd34x1/8	0,100	-0151	16,85	-0152	17,55	-0153	23,00	-0154	23,70
20	20,5	3,5	54,0		Rd44x1/6	0,140	-0201	15,15	-0202	15,80	-0203	21,00	-0204	21,65
25/1"	21,5	3,5	63,0		Rd52x1/6	0,210	-0251	13,30	-0252	13,85	-0253	17,70	-0254	18,25
32/1,25"	21,5	3,5	70,0		Rd58x1/6	0,240	-0321	14,45	-0322	15,05	-0323	18,75	-0324	19,35
40/1,5"	21,5	3,5	78,0		Rd65x1/6	0,310	-0401	14,50	-0402	15,10	-0403	18,65	-0404	19,25
50/2"	22,5	3,5	92,0		Rd78x1/6	0,440	-0501	15,75	-0502	16,10	-0503	21,75	-0504	22,10
65/2,5"	25,5	4,5	112,0		Rd95x1/6	0,750	-0651	23,50	-0652	24,00	-0653	29,90	-0654	30,40
75/3"	25,5	4,5	119,0		Rd104x1/6	0,800	-0751	37,75	-0752	38,55	-0753	52,40	-0754	53,20
80	29,5	4,5	127,0		Rd110x1/4	1,020	-0801	34,20	-0802	34,90	-0803	47,05	-0804	47,75
100/4"	31,5	5,5	148,0		Rd130x1/4	1,480	-1001	49,15	-1002	50,15	-1003	67,00	-1004	68,00
125	35,5	5,5	178,0		Rd160x1/4	1,965	-1251	86,40	-1252	88,15	-1253	120,15	-1254	121,90
150	40,5	6,5	210,0		Rd190x1/4	3,280	-1501	267,90	-1502	273,30	-1503	411,60	-1504	417,00
200	39,5	6,5	260,0		Rd240x1/4	4,550	-2001	703,75	-2002	717,85	-2003	993,30	-2004	1007,40

Rd: Rundgewinde Rd: round thread

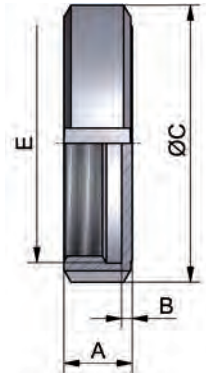
Blindmutter
blind nut

Art.-Nr. 12100-							AISI 304/304L-1.4301/1.4307				AISI 316L-1.4404			
DN	A	B	C	D	E	Gew.	Art.-Nr.	Preis	Art.-Nr.	Preis	Art.-Nr.	Preis	Art.-Nr.	Preis
mm	mm	mm	mm	mm	mm	kg	poliert	EUR	matt	EUR	poliert	EUR	matt	EUR
10	18,5	3,5	38,0	10,0	Rd28x1/8	0,080	-0101	20,35	-0102	21,20	-0103	27,30	-0104	28,45
15	18,5	3,5	44,0	10,0	Rd34x1/8	0,100	-0151	21,05	-0152	21,95	-0153	27,80	-0154	28,95
20	20,5	3,5	54,0	10,0	Rd44x1/6	0,150	-0201	19,50	-0202	20,35	-0203	26,95	-0204	28,10
25/1"	21,5	3,5	63,0	10,0	Rd52x1/6	0,190	-0251	14,10	-0252	14,70	-0253	19,45	-0254	20,30
32/1,25"	21,5	3,5	70,0	10,0	Rd58x1/6	0,250	-0321	14,85	-0322	15,50	-0323	20,60	-0324	21,45
40/1,5"	21,5	3,5	78,0	10,0	Rd65x1/6	0,320	-0401	14,85	-0402	15,50	-0403	20,60	-0404	21,45
50/2"	22,5	3,5	92,0	10,0	Rd78x1/6	0,490	-0501	18,85	-0502	19,25	-0503	23,85	-0504	24,35
65/2,5"	25,5	4,5	112,0	10,0	Rd95x1/6	0,750	-0651	23,20	-0652	23,70	-0653	32,25	-0654	32,95
75/3"	25,5	4,5	119,0	10,0	Rd104x1/6	0,850	-0751	38,70	-0752	39,50	-0753	52,45	-0754	53,55
80	29,5	4,5	127,0	10,0	Rd110x1/4	1,070	-0801	35,15	-0802	35,90	-0803	48,65	-0804	49,70
100/4"	31,5	5,5	148,0	10,0	Rd130x1/4	1,520	-1001	49,60	-1002	50,65	-1003	69,50	-1004	70,95
125	35,5	5,5	178,0	10,0	Rd160x1/4	1,520	-1251	89,45	-1252	91,30	-1253	124,30	-1254	126,90
150	40,5	6,5	210,0	10,0	Rd190x1/4	3,330	-1501	267,85	-1502	273,40	-1503	411,65	-1504	420,15

Rd: Rundgewinde Rd: round thread

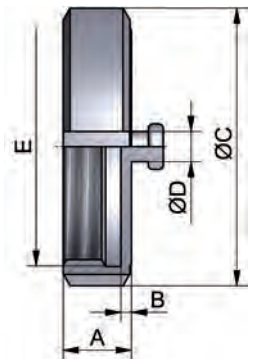
Blindmutter mit Knopf
blind nut with boss

Art.-Nr. 12104-							AISI 304/304L-1.4301/1.4307				AISI 316L-1.4404			
DN	A	B	C	D	E	Gew.	Art.-Nr.	Preis	Art.-Nr.	Preis	Art.-Nr.	Preis	Art.-Nr.	Preis
mm	mm	mm	mm	mm	mm	kg	pol./NBR	EUR	matt/NBR	EUR	pol./NBR	EUR	matt/NBR	EUR
10	18,5	3,5	38,0	10,0	Rd28x1/8	0,130	-0101200	23,10	-0102200	24,10	-0103200	31,05	-0104200	32,35
15	18,5	3,5	44,0	10,0	Rd34x1/8	0,150	-0151200	23,75	-0152200	24,75	-0153200	31,75	-0154200	33,10
20	20,5	3,5	54,0	10,0	Rd44x1/6	0,190	-0201200	22,20	-0202200	23,15	-0203200	29,30	-0204200	30,55
25/1"	21,5	3,5	63,0	10,0	Rd52x1/6	0,250	-0251200	17,30	-0252200	18,05	-0253200	23,90	-0254200	24,90
32/1,25"	21,5	3,5	70,0	10,0	Rd58x1/6	0,290	-0321200	18,50	-0322200	19,30	-0323200	24,35	-0324200	25,40
40/1,5"	21,5	3,5	78,0	10,0	Rd65x1/6	0,330	-0401200	18,50	-0402200	19,30	-0403200	24,35	-0404200	25,40
50/2"	22,5	3,5	92,0	10,0	Rd78x1/6	0,460	-0501200	22,70	-0502200	23,20	-0503200	29,15	-0504200	29,80
65/2,5"	25,5	4,5	112,0	10,0	Rd95x1/6	0,700	-0651200	27,30	-0652200	27,90	-0653200	37,90	-0654200	38,70
75/3"	25,5	4,5	119,0	10,0	Rd104x1/6	0,900	-0751200	43,20	-0752200	44,10	-0753200	59,55	-0754200	60,80
80	29,5	4,5	127,0	10,0	Rd110x1/4	1,110	-0801200	39,70	-0802200	40,55	-0803200	55,30	-0804200	56,45
100/4"	31,5	5,5	148,0	10,0	Rd130x1/4	1,530	-1001200	55,45	-1002200	56,60	-1003200	77,30	-1004200	78,90
125	34,5	5,5	178,0	10,0	Rd160x1/4	2,180	-1251200	96,40	-1252200	98,40	-1253200	133,95	-1254200	136,75
150	40,5	6,5	210,0	10,0	Rd190x1/4	3,040	-1501200	304,70	-1502200	311,00	-1503200	423,50	-1504200	432,25

Rd: Rundgewinde - weitere Dichtungswerkstoffe auf Anfrage Rd: round thread - other gasket materials on inquiry

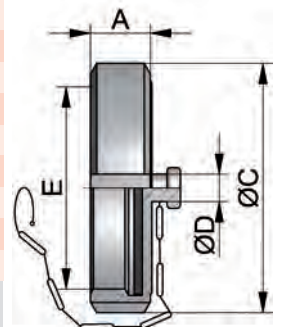
Blindmutter (komplett)
blind nut (complete)

Dichtscheibe (Blindmutter) Art.-Nr. 12200-

gasket disc (blind nut)

DN	A	B	C	D	E	Gew.	Art.-Nr.	Preis	Art.-Nr.	Preis	Art.-Nr.	Preis	Art.-Nr.	Preis
mm	mm	mm	mm	mm	mm	kg	NBR	EUR	EPDM	EUR	FKM	EUR	PTFE	EUR
10	3,0	28,0				0,002	-0100200	0,90	-0100300	3,60	-0100400	6,90	-0100500	7,95
15	3,0	34,0				0,003	-0150200	0,65	-0150300	3,80	-0150400	5,80	-0150500	8,20
20	3,0	44,0				0,006	-0200200	1,20	-0200300	3,40	-0200400	8,60	-0200500	8,55
25/1"	3,0	52,0				0,010	-0250200	1,20	-0250300	2,40	-0250400	5,80	-0250500	8,95
32/1,25"	3,0	58,0				0,011	-0320200	1,30	-0320300	2,50	-0320400	6,05	-0320500	9,20
40/1,5"	3,0	65,0				0,016	-0400200	1,20	-0400300	2,60	-0400400	6,40	-0400500	9,45
50/2"	3,0	78,0				0,021	-0500200	1,30	-0500300	2,85	-0500400	8,60	-0500500	9,65
65/2,5"	3,0	95,0				0,030	-0650200	1,80	-0650300	3,30	-0650400	13,10	-0650500	13,10
75/3"	3,0	104,0				0,035	-0750200	2,90	-0750300	4,30	-0750400	15,10	-0750500	14,50
80	3,0	110,0				0,050	-0800200	2,70	-0800300	4,40	-0800400	17,90	-0800500	15,90
100/4"	3,0	130,0				0,080	-1000200	3,15	-1000300	5,10	-1000400	21,80	-1000500	18,95
125	3,0	160,0				0,125	-1250200	6,80	-1250300	12,80	-1250400	27,45	-1250500	33,00
150	3,0	190,0				0,145	-1500200	7,65	-1500300	14,10	-1500400	39,95	-1500500	46,00
200	3,0	240,0				0,180	-2000200	15,10	-2000300	18,80	-2000400	49,10	-2000500	50,30

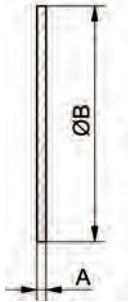

Kette mit Haken und Öse

chain with hook and eye

DN	A	B	C	D	E	Gew.	AISI 304/304L-1.4301/1.4307		Art.-Nr.	Preis
mm	mm	mm	mm	mm	mm	kg	blank	EUR	blank	EUR
10	90,0					0,025	-0201015	34,80	-0202015	36,20
15	90,0					0,025	-0251015	35,25	-0252015	36,70
20	90,0					0,025	-0251020	35,25	-0252020	36,70
25	90,0					0,030	-0321020	20,20	-0322020	21,05
32	100,0					0,030	-0321025	20,20	-0322025	21,05
40	110,0					0,030	-0401025	18,95	-0402025	19,75
50	130,0					0,035	-0401032	18,95	-0402032	19,75
65	140,0					0,035	-0501032	20,85	-0502032	21,30
80	140,0					0,050	-0501040	19,75	-0502040	20,15
100	170,0					0,050	-0651040	50,60	-0652040	51,65
125	200,0					0,055	-0651050	29,75	-0652050	30,35
150	230,0					0,070	-0801050	93,75	-0802050	95,65

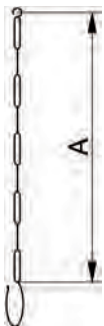

Reduzier-Gewindestutzen

welding reducing male part

DN	A	B	C	D	E	Gew.	AISI 304/304L-1.4301/1.4307		AISI 316L-1.4404	
mm	mm	mm	mm	mm	mm	kg	blank	EUR	blank	EUR
20-15	24,0		16,0	20,0	Rd44x1/6	0,090	-0201015	34,80	-0202015	36,20
25-15	29,0		16,0	26,0	Rd52x1/6	0,120	-0251015	35,25	-0252015	36,70
25-20	29,0		20,0	26,0	Rd52x1/6	0,120	-0251020	35,25	-0252020	36,70
32-20	27,0		20,0	32,0	Rd58x1/6	0,160	-0321020	20,20	-0322020	21,05
32-25	27,0		26,0	32,0	Rd58x1/6	0,140	-0321025	20,20	-0322025	21,05
40-25	28,0		26,0	38,0	Rd65x1/6	0,140	-0401025	18,95	-0402025	19,75
40-32	29,0		32,0	38,0	Rd65x1/6	0,170	-0401032	18,95	-0402032	19,75
50-32	29,0		32,0	50,0	Rd78x1/6	0,260	-0501032	20,85	-0502032	21,30
50-40	35,0		38,0	50,0	Rd78x1/6	0,260	-0501040	19,75	-0502040	20,15
65-40	39,0		38,0	66,0	Rd95x1/6	0,370	-0651040	50,60	-0652040	51,65
65-50	40,0		50,0	66,0	Rd95x1/6	0,410	-0651050	29,75	-0652050	30,35
80-50	45,0		50,0	81,0	Rd110x1/4	0,700	-0801050	93,75	-0802050	95,65
80-65	46,0		66,0	81,0	Rd110x1/4	0,630	-0801065	66,25	-0802065	67,60
100-65	49,0		66,0	100,0	Rd130x1/4	0,910	-1001065	136,50	-1002065	139,25
100-80	49,0		81,0	100,0	Rd130x1/4	0,840	-1001080	137,85	-1002080	140,65

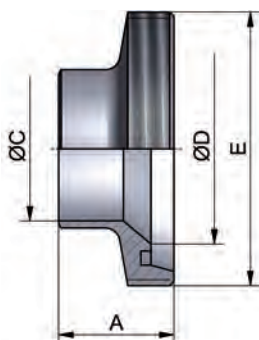

weitere Größen auf Anfrage - Rd: Rundgewinde

other dimensions on inquiry - Rd: round thread

Rohrverbindungen – Verschraubungen
pipe connections – screwed pipe connections

Art.-Nr. 12402-							AISI 304/304L-1.4301/1.4307				AISI 316L-1.4404			
DN	A	B	C	D	E	Gew.	Art.-Nr.	Preis	Art.-Nr.	Preis	Art.-Nr.	Preis	Art.-Nr.	Preis
mm	mm	mm	mm	mm	mm	kg	blank	EUR	matt	EUR	blank	EUR	matt	EUR
20-15	17,0	20,0	8,0	16,0	36,5	0,080	-0201015	14,35	-0202015	14,95	-0203015	19,90	-0204015	20,50
25-15	22,0	26,0	10,0	16,0	44,0	0,110	-0251015	14,10	-0252015	14,70	-0253015	19,50	-0254015	20,10
25-20	22,0	26,0	10,0	20,0	44,0	0,110	-0251020	14,25	-0252020	14,85	-0253020	19,65	-0254020	20,25
32-20	23,0	32,0	10,0	20,0	50,0	0,140	-0321020	15,25	-0322020	15,90	-0323020	23,05	-0324020	23,70
32-25	20,0	32,0	10,0	26,0	50,0	0,120	-0321025	15,25	-0322025	15,90	-0323025	23,05	-0324025	23,70
40-25	20,0	38,0	10,0	26,0	56,0	0,180	-0401025	14,50	-0402025	15,10	-0403025	19,10	-0404025	19,70
40-32	23,0	38,0	10,0	32,0	56,0	0,150	-0401032	14,50	-0402032	15,10	-0403032	19,10	-0404032	19,70
50-32	23,0	50,0	11,0	32,0	68,5	0,270	-0501032	19,55	-0502032	19,95	-0503032	25,95	-0504032	26,35
50-40	26,0	50,0	11,0	38,0	68,5	0,260	-0501040	16,35	-0502040	16,70	-0503040	22,20	-0504040	22,55
65-40	26,0	66,0	12,0	38,0	86,0	0,510	-0651040	25,45	-0652040	26,00	-0653040	33,35	-0654040	33,90
65-50	27,0	66,0	12,0	50,0	86,0	0,410	-0651050	21,05	-0652050	21,50	-0653050	26,10	-0654050	26,55
80-50	30,0	81,0	12,0	50,0	100,0	0,600	-0801050	39,75	-0802050	40,55	-0803050	51,65	-0804050	52,45
80-65	31,0	81,0	12,0	66,0	100,0	0,520	-0801065	34,90	-0802065	35,60	-0803065	40,95	-0804065	41,65
100-65	40,0	100,0	15,0	66,0	121,0	1,050	-1001065	82,45	-1002065	84,10	-1003065	114,45	-1004065	116,10
100-80	42,0	100,0	15,0	81,0	121,0	0,800	-1001080	72,55	-1002080	74,05	-1003080	99,65	-1004080	101,15

weitere Größen auf Anfrage other dimensions on inquiry

**Reduzier-
Kegelstutzen**

**welding
reducing liner**

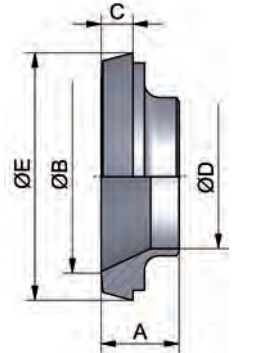

Art.-Nr. 12600-							AISI 304/304L-1.4301/1.4307				AISI 316L-1.4404			
DN	A	B	C	D	E	Gew.	Art.-Nr.	Preis	Art.-Nr.	Preis	Art.-Nr.	Preis	Art.-Nr.	Preis
mm	mm	mm	mm	mm	mm	kg	blank	EUR	matt	EUR	blank	EUR	matt	EUR
20-15	24,0	12,0	18,2	20,0	Rd44x1/6	0,090	-0201015	34,80	-0202015	36,20	-0203015	44,30	-0204015	45,70
25-15	29,0	12,0	18,2	26,0	Rd52x1/6	0,120	-0251015	35,25	-0252015	36,70	-0253015	45,85	-0254015	47,30
25-20	29,0	12,0	22,2	26,0	Rd52x1/6	0,120	-0251020	35,25	-0252020	36,70	-0253020	45,85	-0254020	47,30
32-20	27,0	15,0	22,2	32,0	Rd58x1/6	0,160	-0321020	20,20	-0322020	21,05	-0323020	24,45	-0324020	25,30
32-25	27,0	15,0	28,2	32,0	Rd58x1/6	0,140	-0321025	20,20	-0322025	21,05	-0323025	24,45	-0324025	25,30
40-25	28,0	15,0	28,2	38,0	Rd65x1/6	0,170	-0401025	18,95	-0402025	19,75	-0403025	23,85	-0404025	24,65
40-32	29,0	18,0	34,2	38,0	Rd65x1/6	0,180	-0401032	18,95	-0402032	19,75	-0403032	23,85	-0404032	24,65
50-32	29,0	18,0	34,2	50,0	Rd78x1/6	0,280	-0501032	20,85	-0502032	21,30	-0503032	33,85	-0504032	34,30
50-40	35,0	20,0	40,2	50,0	Rd78x1/6	0,290	-0501040	19,75	-0502040	20,15	-0503040	25,45	-0504040	25,85
65-40	39,0	20,0	40,2	66,0	Rd95x1/6	0,410	-0651040	50,60	-0652040	51,65	-0653040	66,25	-0654040	67,30
65-50	40,0	22,0	52,2	66,0	Rd95x1/6	0,450	-0651050	29,75	-0652050	30,35	-0653050	38,40	-0654050	39,00
80-50	45,0	22,0	52,2	81,0	Rd110x1/4	0,890	-0801050	93,75	-0802050	95,65	-0803050	120,10	-0804050	122,00
80-65	46,0	25,0	70,3	81,0	Rd110x1/4	0,700	-0801065	66,25	-0802065	67,60	-0803065	86,25	-0804065	87,60
100-65	49,0	25,0	70,3	100,0	Rd130x1/4	0,980	-1001065	136,50	-1002065	139,25	-1003065	176,20	-1004065	178,95
100-80	49,0	28,0	85,3	100,0	Rd130x1/4	0,926	-1001080	137,85	-1002080	140,65	-1003080	180,55	-1004080	183,35

weitere Größen auf Anfrage - Rd: Rundgewinde other dimensions on inquiry - Rd: round thread

**Red.-Gewindestutzen
(Walz)**

**expanding reducing
male part**

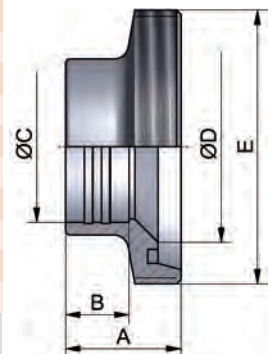

Art.-Nr. 12400-							AISI 304/304L-1.4301/1.4307				AISI 316L-1.4404			
DN	A	B	C	D	E	Gew.	Art.-Nr.	Preis	Art.-Nr.	Preis	Art.-Nr.	Preis	Art.-Nr.	Preis
mm	mm	mm	mm	mm	mm	kg	blank	EUR	matt	EUR	blank	EUR	matt	EUR
20-15	25,0	12,0	8,0	18,2	36,5	0,080	-0201015	14,35	-0202015	14,95	-0203015	19,90	-0204015	20,50
25-15	22,0	12,0	10,0	18,2	44,0	0,110	-0251015	14,10	-0252015	14,70	-0253015	19,50	-0254015	20,10
25-20	22,0	12,0	10,0	22,2	44,0	0,110	-0251020	14,25	-0252020	14,85	-0253020	19,65	-0254020	20,25
32-20	23,0	12,0	10,0	22,2	50,0	0,135	-0321020	15,25	-0322020	15,90	-0323020	23,05	-0324020	23,70
32-25	20,0	15,0	10,0	28,2	50,0	0,120	-0321025	15,25	-0322025	15,90	-0323025	23,05	-0324025	23,70
40-25	20,0	15,0	10,0	28,2	56,0	0,170	-0401025	14,50	-0402025	15,10	-0403025	19,10	-0404025	19,70
40-32	23,0	18,0	10,0	34,2	56,0	0,170	-0401032	14,50	-0402032	15,10	-0403032	19,10	-0404032	19,70
50-32	23,0	18,0	11,0	34,2	68,5	0,290	-0501032	19,55	-0502032	19,95	-0503032	25,95	-0504032	26,35
50-40	26,0	20,0	11,0	40,2	68,5	0,270	-0501040	16,35	-0502040	16,70	-0503040	22,20	-0504040	22,55
65-40	26,0	20,0	12,0	40,2	86,0	0,540	-0651040	25,45	-0652040	26,00	-0653040	33,35	-0654040	33,90
65-50	27,0	22,0	12,0	52,2	86,0	0,450	-0651050	21,05	-0652050	21,50	-0653050	26,10	-0654050	26,55
80-50	30,0	22,0	12,0	52,2	100,0	0,660	-0801050	39,75	-0802050	40,55	-0803050	51,65	-0804050	52,45
80-65	31,0	25,0	12,0	70,4	100,0	0,500	-0801065	34,90	-0802065	35,60	-0803065	40,95	-0804065	41,65
100-65	40,0	25,0	15,0	70,4	121,0	1,170	-1001065	82,45	-1002065	84,10	-1003065	114,45	-1004065	116,10
100-80	42,0	28,0	15,0	85,4	121,0	1,060	-1001080	72,55	-1002080	74,05	-1003080	99,65	-1004080	101,15

weitere Größen auf Anfrage other dimensions on inquiry

**Reduzier-
Kegelstutzen
(Walz)**

**expanding
reducing liner**

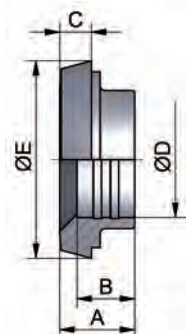

Rohrverbindungen – Verschraubungen pipe connections – screwed pipe connections

Einschraub-Kegelstutzen liner threaded outside	Art.-Nr. 12700-							AISI 304/304L-1.4301/1.4307				AISI 316L-1.4404			
	DN	A	B	C	D	E	Gew.	Art.-Nr.	Preis	Art.-Nr.	Preis	Art.-Nr.	Preis	Art.-Nr.	Preis
	mm	mm	mm	mm	mm	mm	kg	blank	EUR	matt	EUR	blank	EUR	matt	EUR
10	38,0	14,0	G3/8"	SW14		22,5	0,040	-0101	17,65	-0102	18,40	-0103	28,60	-0104	29,35
15	38,0	14,0	G1/2"	SW19		28,5	0,050	-0151	12,90	-0152	13,45	-0153	21,75	-0154	22,30
20	40,0	14,0	G3/4"	SW27		36,5	0,100	-0201	17,45	-0202	18,15	-0203	23,60	-0204	24,30
25	50,0	20,0	G1"	SW30		44,0	0,150	-0251	18,00	-0252	18,75	-0253	24,20	-0254	24,95
32	50,0	20,0	G1.1/4"	SW36		50,0	0,210	-0321	21,65	-0322	22,55	-0323	28,65	-0324	29,55
40	50,0	20,0	G1.1/2"	SW44		56,0	0,240	-0401	23,50	-0402	24,45	-0403	34,30	-0404	35,25
50	50,0	20,0	G2"	SW55		68,5	0,310	-0501	28,75	-0502	29,35	-0503	41,40	-0504	42,00
65	55,0	22,0	G2.1/2"	SW70		86,0	0,500	-0651	47,10	-0652	48,05	-0653	70,35	-0654	71,30
80	60,0	25,0	G3"	SW88		100,0	0,580	-0801	72,05	-0802	73,50	-0803	121,15	-0804	122,60
100	70,0	30,0	G4"	SW110		121,0	1,220	-1001	106,00	-1002	108,15	-1003	173,80	-1004	175,95

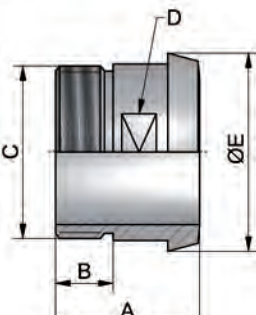

G: Rohrgewinde ISO 228-1 - SW: Schlüsselweite G: pipe thread ISO 228-1 - SW: width across flats

Einschraub-Gewindestutzen male threaded outside	Art.-Nr. 12800-							AISI 304/304L-1.4301/1.4307				AISI 316L-1.4404			
	DN	A	B	C	D	E	Gew.	Art.-Nr.	Preis	Art.-Nr.	Preis	Art.-Nr.	Preis	Art.-Nr.	Preis
	mm	mm	mm	mm	mm	mm	kg	blank	EUR	matt	EUR	blank	EUR	matt	EUR
10	40,0	14,0	G3/8"	SW17	Rd28x1/8	0,060		-0101	16,70	-0102	17,40	-0103	25,90	-0104	26,60
15	40,0	14,0	G1/2"	SW24	Rd34x1/8	0,090		-0151	17,70	-0152	18,45	-0153	26,60	-0154	27,35
20	42,0	14,0	G3/4"	SW30	Rd44x1/6	0,150		-0201	22,20	-0202	23,10	-0203	34,05	-0204	34,95
25	48,0	20,0	G1"	SW41	Rd52x1/6	0,220		-0251	24,10	-0252	25,10	-0253	40,00	-0254	41,00
32	48,0	20,0	G1.1/4"	SW46	Rd58x1/6	0,310		-0321	26,10	-0322	27,15	-0323	42,15	-0324	43,20
40	50,0	20,0	G1.1/2"	SW50	Rd65x1/6	0,400		-0401	28,90	-0402	30,10	-0403	43,75	-0404	44,95
50	52,0	20,0	G2"	SW65	Rd78x1/6	0,540		-0501	37,10	-0502	37,85	-0503	53,95	-0504	54,70
65	56,0	22,0	G2.1/2"	SW80	Rd95x1/6	0,710		-0651	55,05	-0652	56,20	-0653	80,05	-0654	81,20
80	66,0	25,0	G3"	SW95	Rd110x1/4	0,950		-0801	85,50	-0802	87,25	-0803	144,85	-0804	146,60
100	72,0	30,0	G4"	SW117	Rd130x1/4	1,480		-1001	171,60	-1002	175,05	-1003	250,15	-1004	253,60

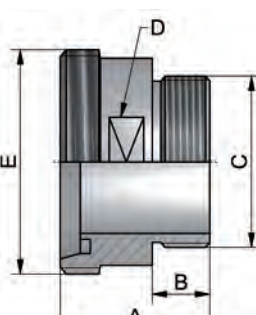

G: Rohrgewinde ISO 228-1 - SW: Schlüsselweite - Rd: Rundgewinde G: pipe thread ISO 228-1 - SW: width across flats - Rd: round thread

Aufschraub-Gewindestutzen male threaded inside	Art.-Nr. 12900-							AISI 304/304L-1.4301/1.4307				AISI 316L-1.4404			
	DN	A	B	C	D	E	Gew.	Art.-Nr.	Preis	Art.-Nr.	Preis	Art.-Nr.	Preis	Art.-Nr.	Preis
	mm	mm	mm	mm	mm	mm	kg	blank	EUR	matt	EUR	blank	EUR	matt	EUR
10	30,0	14,0	G3/8"	SW19	Rd28x1/8	0,050		-0101	22,50	-0102	23,40	-0103	45,65	-0104	46,55
15	30,0	14,0	G1/2"	SW24	Rd34x1/8	0,070		-0151	22,50	-0152	23,40	-0153	32,45	-0154	33,35
20	30,0	14,0	G3/4"	SW30	Rd44x1/6	0,120		-0201	22,50	-0202	23,40	-0203	36,60	-0204	37,50
25	35,0	20,0	G1"	SW41	Rd52x1/6	0,190		-0251	22,50	-0252	23,40	-0253	30,50	-0254	31,40
32	35,0	20,0	G1.1/4"	SW46	Rd58x1/6	0,230		-0321	26,35	-0322	27,45	-0323	37,75	-0324	38,85
40	35,0	20,0	G1.1/2"	SW55	Rd65x1/6	0,300		-0401	26,35	-0402	27,45	-0403	38,15	-0404	39,25
50	35,0	20,0	G2"	SW65	Rd78x1/6	0,360		-0501	30,00	-0502	30,60	-0503	43,45	-0504	44,05
65	38,0	22,0	G2.1/2"	SW80	Rd95x1/6	0,490		-0651	49,90	-0652	50,90	-0653	73,55	-0654	74,55
80	43,0	25,0	G3"	SW95	Rd110x1/4	0,680		-0801	134,30	-0802	137,00	-0803	197,50	-0804	200,20
100	50,0	30,0	G4"	SW117	Rd130x1/4	0,720		-1001	175,50	-1002	179,05	-1003	255,45	-1004	259,00

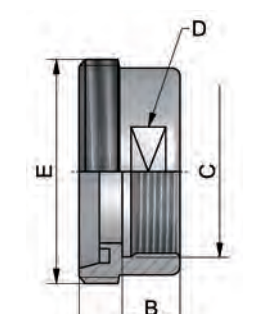

G: Rohrgewinde ISO 228-1 - SW: Schlüsselweite - Rd: Rundgewinde G: pipe thread ISO 228-1 - SW: width across flats - Rd: round thread

Rohrverbindungen – Verschraubungen
pipe connections – screwed pipe connections
**IDF-Gewindestutzen
ISO S**
Art.-Nr. 15243-

AISI 316L-1.4404

DN	A	B	C	D	E	Gew.
mm	mm	mm	mm	mm	mm	kg
1"	21,5		25,6		Tr37,1x1/8	0,060
1,5"	21,5		38,6		Tr50,6x1/8	0,100
2"	21,5		51,6		Tr64,1x1/8	0,140
2,5"	21,5		64,1		Tr77,6x1/8	0,210
3"	21,5		76,7		Tr91,1x1/8	0,270
4"	21,5		102,5		Tr118,2x1/8	0,410

Art.-Nr.	Preis	Art.-Nr.	Preis
blank	EUR	matt	EUR
-1003	12,80	-1004	13,30
-1123	14,80	-1124	15,30
-2003	17,10	-2004	17,80
-2123	21,20	-2124	21,90
-3003	24,80	-3004	25,90
-4003	(+)	-4004	(+)

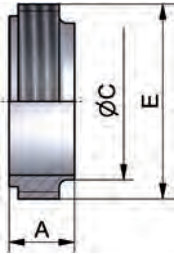

Tr: Amerikanisches Trapezgewinde Acme

Tr: Trapezoidal thread acc. Acme

**IDF-Bundstutzen
ISO S**
Art.-Nr. 15343-

AISI 316L-1.4404

DN	A	B	C	D	E	Gew.
mm	mm	mm	mm	mm	mm	kg
1"	12,0	33,8	25,6			0,020
1,5"	12,0	47,0	38,6			0,040
2"	12,0	60,5	51,6			0,060
2,5"	12,0	74,0	64,1			0,100
3"	12,0	87,5	76,7			0,140
4"	21,5	114,1	102,5			0,200

Art.-Nr.	Preis	Art.-Nr.	Preis
blank	EUR	matt	EUR
-1003	11,10	-1004	11,60
-1123	12,50	-1124	13,00
-2003	12,90	-2004	13,60
-2123	15,60	-2124	16,30
-3003	19,10	-3004	19,80
-4003	(+)	-4004	(+)

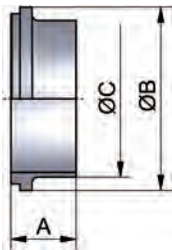
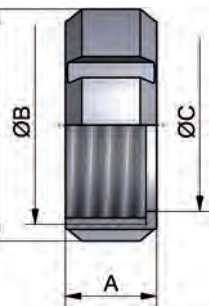
**IDF welding liner
ISO**

**IDF-Nutmutter ISO
IDF nut ISO**
Art.-Nr. 15443-

AISI 304/304L-1.4301/1.4307

DN	A	B	C	D	E	Gew.
mm	mm	mm	mm	mm	mm	kg
1"	30,0	Tr38,3x1/8	30,5	48,0		0,150
1,5"	30,0	Tr51,8x1/8	43,5	64,0		0,240
2"	30,0	Tr65,3x1/8	57,0	77,0		0,300
2,5"	30,0	Tr78,8x1/8	70,7	91,0		0,380
3"	30,0	Tr92,3x1/8	83,3	106,0		0,510
4"	30,0	Tr119,4x1/8	110,0	135,0		0,730

Art.-Nr.	Preis	Art.-Nr.	Preis
blank	EUR	matt	EUR
-1001	12,75	-1002	13,30
-1121	14,45	-1122	15,05
-2001	15,90	-2002	16,25
-2121	17,85	-2122	18,25
-3001	21,50	-3002	21,95
-4001	78,10	-4002	79,70

 Tr: Amerikanisches Trapezgewinde Acme
 auch als Sechskantmutter erhältlich

 Tr: Trapezoidal thread acc. Acme
 also available as hexagonal nut

**IDF-Dichtung
(L-Form)**
Art.-Nr. 15541-

DN	A	B	C	D	E	Gew.
mm	mm	mm	mm	mm	mm	kg
1"	6,0	32,5	23,6			0,002
1,5"	6,0	46,0	36,6			0,003
2"	6,0	59,5	49,6			0,006
2,5"	6,0	73,2	61,3			0,007
3"	6,0	86,5	73,9			0,009
4"	6,0	112,5	98,6			0,018

Art.-Nr.	Preis
NBR	EUR
-1000200	3,90
-1120200	4,10
-2000200	4,80
-2120200	5,10
-3000200	5,30
-4000200	6,90

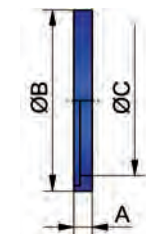
 weitere Werkstoffe auf Anfrage
 (+) Preis auf Anfrage

 other gasket materials on inquiry
 (+) price on inquiry

Rohrverbindungen – Verschraubungen
pipe connections – screwed pipe connections
Art.-Nr. 16263-

DN	A	B	C	D	E	Gew.
mm	mm	mm	mm	mm	mm	kg
1"	26,3	W45,5x1/8	25,6		SWG16	0,130
1,5"	26,3	W58,2x1/8	38,3		SWG16	0,150
2"	26,3	W72,5x1/6	51,0		SWG16	0,210
2,5"	26,3	W85,2x1/6	63,7		SWG16	0,260
3"	26,3	W97,9x1/6	76,4		SWG16	0,330
4"	26,3	W123,3x1/6	101,8		SWG14	0,440

AISI 316L-1.4404

Art.-Nr.	Preis	Art.-Nr.	Preis
blank	EUR	matt	EUR
-1003	13,90	-1004	14,40
-1123	14,80	-1124	15,40
-2003	17,60	-2004	18,30
-2123	26,10	-2124	26,90
-3003	30,20	-3004	31,00
-4003	45,80	-4004	46,70

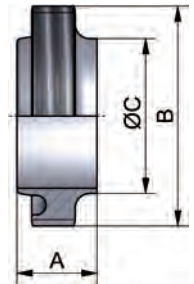
RJT-Gewindestutzen S
RJT welding male part

 W: Whitworth-Gewinde gem. BS 84
 SWG: SWG-Nummer

 W: Whitworth thread acc. BS 84
 SWG: SWG-Number

Art.-Nr. 16363-

DN	A	B	C	D	E	Gew.
mm	mm	mm	mm	mm	mm	kg
1"	12,7	41,3	25,6		SWG16	0,040
1,5"	12,7	54,0	38,3		SWG16	0,040
2"	12,7	66,7	51,0		SWG16	0,060
2,5"	12,7	79,4	63,7		SWG16	0,080
3"	12,7	92,1	76,4		SWG16	0,080
4"	25,4	117,5	101,8		SWG14	0,160

AISI 316L-1.4404

Art.-Nr.	Preis	Art.-Nr.	Preis
blank	EUR	matt	EUR
-1003	7,20	-1004	7,60
-1123	7,70	-1124	8,20
-2003	9,20	-2004	9,70
-2123	10,60	-2124	11,20
-3003	14,90	-3004	15,60
-4003	27,60	-4004	28,50

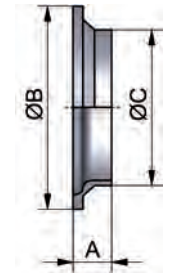
RJT-Bundstutzen S
RJT welding liner

SWG: SWG-Nummer

SWG: SWG-Number

Art.-Nr. 16463-

DN	A	B	C	D	E	Gew.
mm	mm	mm	mm	mm	mm	kg
1"	22,0	W46,6x1/8	33,3	SW51		0,150
1,5"	22,0	W59,3x1/8	46,0	SW65		0,200
2"	22,0	W73,6x1/6	58,7	SW79		0,280
2,5"	22,0	W86,3x1/6	71,4	SW92		0,340
3"	22,0	W99,0x1/6	84,1	SW105		0,410
4"	22,0	W124,4x1/6	109,5	SW130		0,560

AISI 304/304L-1.4301/1.4307

Art.-Nr.	Preis	Art.-Nr.	Preis
blank	EUR	matt	EUR
-1001	11,80	-1002	12,30
-1121	15,80	-1122	16,30
-2001	17,90	-2002	18,50
-2121	18,80	-2122	19,50
-3001	26,10	-3002	27,10
-4001	(+)	-4002	(+)

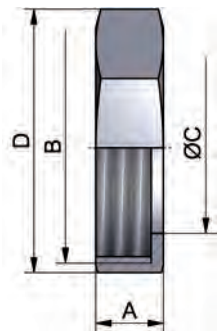
RJT-Sechskantmutter
RJT hexagon nut

 W: Whitworth-Gewinde gem. BS 84
 SW: Schlüsselweite

 W: Whitworth thread acc. BS 84
 SW: width across flats

Art.-Nr. 16561-

DN	A	B	C	D	E	Gew.
mm	mm	mm	mm	mm	mm	kg
1"	6,6		26,7			0,004
1,5"	6,6		39,4			0,006
2"	6,6		52,1			0,008
2,5"	6,6		64,8			0,010
3"	6,6		77,5			0,012
4"	6,6		102,9			0,014

Art.-Nr. **Preis**
 NBR EUR

-1000200	3,40
-1120200	3,40
-2000200	3,60
-2120200	3,90
-3000200	4,90
-4000200	5,90

RJT-Dichtung
RJT gasket

 weitere Werkstoffe auf Anfrage
 (+) Preis auf Anfrage

 other gasket materials on inquiry
 (+) price on inquiry

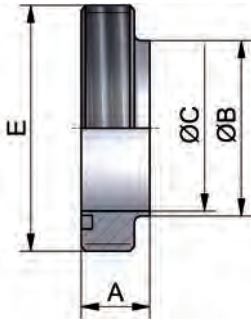
Rohrverbindungen – Verschraubungen
pipe connections – screwed pipe connections
DS-Gewindestutzen S
Art.-Nr. 15752-
AISI 304/304L-1.4301/1.4307
AISI 316L-1.4404
DS welding male part

DN	A	B	C	D	E	Gew.	AISI 304/304L-1.4301/1.4307		AISI 316L-1.4404					
							Art.-Nr.	Preis	Art.-Nr.	Preis	Art.-Nr.	Preis	Art.-Nr.	Preis
	mm	mm	mm	mm	mm	kg	blank	EUR	matt	EUR	blank	EUR	matt	EUR
1"	18,5	25,4	22,5		Rd44x1/6	0,090	-0251	9,80	-0252	10,20	-0253	14,65	-0254	15,05
1,5"	20,0	38,4	35,5		Rd58x1/6	0,140	-0381	10,80	-0382	11,25	-0383	17,60	-0384	18,05
2"	20,0	51,4	48,5		Rd72x1/6	0,220	-0511	13,20	-0512	13,50	-0513	21,35	-0514	21,65
2,5"	24,0	63,9	60,5		Rd88x1/6	0,340	-0631	16,80	-0632	17,15	-0633	31,75	-0634	32,10
3"	24,0	76,4	72,0		Rd100x1/6	0,430	-0761	19,60	-0762	20,00	-0763	37,20	-0764	37,60
4"	24,0	102,0	97,6		Rd130x1/6	0,720	-1011	29,85	-1012	30,45	-1013	59,20	-1014	59,80

Rd: Rundgewinde

Rd: round thread

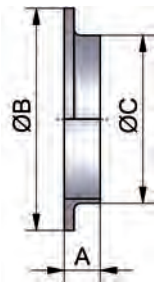
DS-Bundstutzen S
Art.-Nr. 15852-
AISI 304/304L-1.4301/1.4307
AISI 316L-1.4404
DS welding liner

DN	A	B	C	D	E	Gew.	AISI 304/304L-1.4301/1.4307		AISI 316L-1.4404					
							Art.-Nr.	Preis	Art.-Nr.	Preis	Art.-Nr.	Preis	Art.-Nr.	Preis
	mm	mm	mm	mm	mm	kg	blank	EUR	matt	EUR	blank	EUR	matt	EUR
1"	11,0	40,0	25,4			0,020	-0251	6,70	-0252	7,00	-0253	11,00	-0254	11,30
1,5"	11,0	54,0	38,4			0,040	-0381	8,40	-0382	8,75	-0383	15,55	-0384	15,90
2"	11,0	68,0	51,4			0,050	-0511	10,40	-0512	10,65	-0513	18,10	-0514	18,35
2,5"	12,0	84,0	63,9			0,100	-0631	15,80	-0632	16,15	-0633	20,55	-0634	20,90
3"	12,0	96,0	76,4			0,120	-0761	17,85	-0762	18,25	-0763	27,45	-0764	27,85
4"	12,0	124,0	102,0			0,260	-1011	28,75	-1012	29,35	-1013	37,80	-1014	38,40

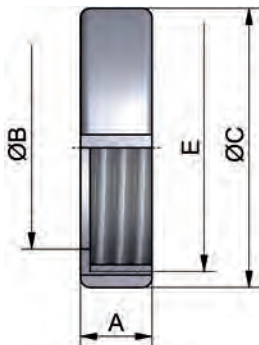
DS-Nutmutter
Art.-Nr. 15952-
AISI 304/304L-1.4301/1.4307
DS nut

DN	A	B	C	D	E	Gew.	AISI 304/304L-1.4301/1.4307			
							Art.-Nr.	Preis	Art.-Nr.	Preis
	mm	mm	mm	mm	mm	kg	blank	EUR	matt	EUR
1"	20,0	35,0	57,0		Rd44x1/6	0,160	-0251	10,55	-0252	11,00
1,5"	20,0	48,5	71,0		Rd58x1/6	0,220	-0381	11,35	-0382	11,85
2"	22,0	62,5	86,0		Rd72x1/6	0,310	-0511	14,40	-0512	14,70
2,5"	24,0	76,5	103,0		Rd88x1/6	0,450	-0631	18,40	-0632	18,80
3"	25,0	88,5	115,0		Rd100x1/6	0,540	-0761	21,75	-0762	22,20
4"	28,0	117,0	150,0		Rd130x1/6	1,000	-1011	36,05	-1012	36,80

Rd: Rundgewinde

Rd: round thread

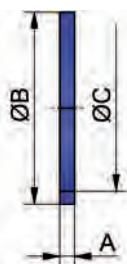
DS-Dichtung
Art.-Nr. 16050-
DS gasket

DN	A	B	C	D	E	Gew.	Art.-Nr.		Preis	
							NBR		EUR	
	mm	mm	mm	mm	mm	kg				
1"	4,5	32,0	25,0			0,002	-0250200			1,60
1,5"	4,5	47,0	38,0			0,003	-0380200			1,70
2"	4,5	59,0	51,0			0,004	-0510200			1,95
2,5"	4,5	74,5	63,5			0,007	-0630200			2,60
3"	4,5	88,0	76,0			0,009	-0760200			3,90
4"	4,5	112,5	101,6			0,014	-1010200			3,60

weitere Werkstoffe auf Anfrage

other gasket materials on inquiry

Rohrverbindungen – Verschraubungen
pipe connections – screwed pipe connections

SMS-Gewindestutzen S SMS welding male part	Art.-Nr. 17500-							AISI 304/304L-1.4301/1.4307				AISI 316L-1.4404			
	DN	A	B	C	D	E	Gew.	Art.-Nr.	Preis	Art.-Nr.	Preis	Art.-Nr.	Preis	Art.-Nr.	Preis
	mm	mm	mm	mm	mm	mm	kg	blank	EUR	matt	EUR	blank	EUR	matt	EUR
1"	15,0	3,0	25,0	22,5	Rd40x1/6	0,030	-0251	10,20	-0252	10,65	-0253	13,65	-0254	14,10	
1,5"	20,0	3,0	38,0	35,5	Rd60x1/6	0,110	-0381	13,55	-0382	14,10	-0383	17,45	-0384	18,00	
2"	20,0	3,0	51,0	48,5	Rd70x1/6	0,240	-0511	15,15	-0512	15,50	-0513	18,05	-0514	18,40	
2,5"	24,0	3,0	63,5	60,5	Rd85x1/6	0,330	-0631	21,20	-0632	21,65	-0633	26,85	-0634	27,30	
3"	24,0	3,0	76,0	72,0	Rd98x1/6	0,960	-0761	25,40	-0762	25,95	-0763	32,55	-0764	33,10	
4"	35,0	3,0	101,6	97,6	Rd132x1/6	1,322	-1011	55,65	-1012	56,80	-1013	70,70	-1014	71,85	

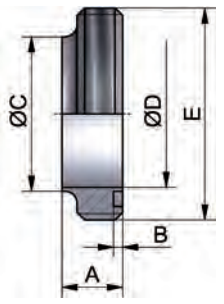

Rd: Rundgewinde

Rd: round thread

SMS-Bundstutzen S SMS welding liner	Art.-Nr. 17600-							AISI 304/304L-1.4301/1.4307				AISI 316L-1.4404			
	DN	A	B	C	D	E	Gew.	Art.-Nr.	Preis	Art.-Nr.	Preis	Art.-Nr.	Preis	Art.-Nr.	Preis
	mm	mm	mm	mm	mm	mm	kg	blank	EUR	matt	EUR	blank	EUR	matt	EUR
1"	8,0	3,5	25,0	22,5	35,5	0,010	-0251	7,60	-0252	7,95	-0253	9,10	-0254	9,45	
1,5"	9,0	4,0	38,0	35,5	55,0	0,030	-0381	9,00	-0382	9,40	-0383	11,00	-0384	11,40	
2"	9,0	4,0	51,0	48,5	65,0	0,060	-0511	10,35	-0512	10,60	-0513	13,20	-0514	13,45	
2,5"	9,0	4,0	63,5	60,5	80,0	0,110	-0631	14,20	-0632	14,50	-0633	17,85	-0634	18,15	
3"	10,0	5,0	76,0	72,0	93,0	0,130	-0761	18,00	-0762	18,40	-0763	23,10	-0764	23,50	
4"	12,0	6,0	101,6	97,6	127,0	0,300	-1011	32,50	-1012	33,15	-1013	42,10	-1014	42,75	

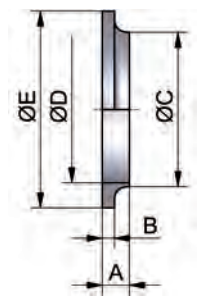

SMS-Nutmutter SMS nut	Art.-Nr. 17200-							AISI 304/304L-1.4301/1.4307			
	DN	A	B	C	D	E	Gew.	Art.-Nr.	Preis	Art.-Nr.	Preis
	mm	mm	mm	mm	mm	mm	kg	blank	EUR	matt	EUR
1"	20,0	16,0	51,0	32,0	Rd40x1/6	0,050	-0251	10,10	-0252	10,55	
1,5"	25,0	21,0	74,0	48,0	Rd60x1/6	0,170	-0381	11,95	-0382	12,45	
2"	26,0	21,0	84,0	60,5	Rd70x1/6	0,310	-0511	13,20	-0512	13,50	
2,5"	30,0	25,0	100,0	74,0	Rd85x1/6	0,330	-0631	18,50	-0632	18,90	
3"	32,0	26,0	114,0	87,0	Rd98x1/6	0,591	-0761	23,45	-0762	23,95	
4"	45,0	38,0	154,0	117,0	Rd132x1/6	1,740	-1011	67,45	-1012	68,80	

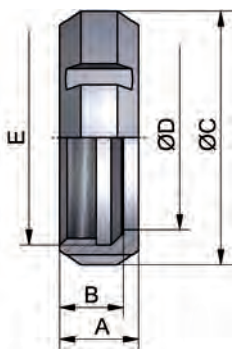

Rd: Rundgewinde

RD: round thread

SMS-Dichtung SMS gasket	Art.-Nr. 17300-							AISI 304/304L-1.4301/1.4307		AISI 316L-1.4404		PTFE			
	DN	A	B	C	D	E	Gew.	Art.-Nr.	Preis	Art.-Nr.	Preis	Art.-Nr.	Preis		
	mm	mm	mm	mm	mm	mm	kg	NBR	EUR	EPDM	EUR	FKM	EUR		
1"	5,5*	25,0	32,0				0,002	-0250200	1,10	-0250300	1,60	-0250400	10,50	-0250500	4,90
1,5"	5,5*	38,0	48,0				0,003	-0380200	1,15	-0380300	1,70	-0380400	13,80	-0380500	5,60
2"	5,5*	51,0	61,0				0,006	-0510200	1,30	-0510300	2,20	-0510400	26,80	-0510500	12,60
2,5"	5,5*	63,5	73,5				0,007	-0630200	1,40	-0630300	3,10	-0630400	35,20	-0630500	11,20
3"	5,5*	76,0	86,0				0,010	-0760200	1,80	-0760300	3,60	-0760400	45,10	-0760500	16,50
4"	5,5*	101,6	113,5				0,020	-1010200	4,20	-1010300	8,50	-1010400	78,10	-1010500	19,10

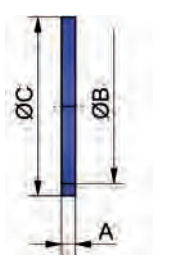

* PTFE A = 4 mm

* PTFE A = 4 mm



Kölner Armaturenhandel e. K.

Telefon: 0 22 34 / 92 97 62
Telefax: 0 22 34 / 94 47 90